

DETENTION POND		WEIR STRUCTURE	
Return Event	Peak In-Flow (CFS)	Elevation (ft)	Width (ft)
2 YEAR	149.0	695	7.0
25 YEAR	280.0	696.5	7.0
100 YEAR	367.5	697.4	4.0

DETENTION POND ROUTING				
Return Event	Peak In-Flow (CFS)	Peak Out-Flow (CFS)	Max WSEL (ft)	Max Storage (Ac-ft)
2	149.0	83.4	695	3.51
25	280.0	193.6	696.5	5.66
100	367.5	271.0	697.4	6.84

DETENTION POND						
Elev. (ft)	Depth (ft)	Pr. Area (ft ²)	Area (ac)	Incremental Volume (ft ³)	Cumulative Volume (ft ³)	Notes
692.5	0.0	61,208	1.405142	0	0	
693	0.5	61,208	1.405142	30,604	30,604	
694	1.0	61,208	1.405142	61,208	91,812	
695	1.0	61,208	1.405142	61,208	153,020	
696	1.0	61,208	1.405142	61,208	214,228	
697	1.0	61,208	1.405142	61,208	275,436	
697.4	0.4	61,208	1.405142	24,483	299,919	100 YR WSEL
698	1.0	61,208	1.405142	61,208	336,644	

D50 CALCULATIONS:

V = 10.63 FPS

D50 = 0.0105 * (V)^{2.06}
 D50 = 0.0105 * (10.63)^{2.06}
 D50 = 1.37 FT

V = 8.90 FPS

D50 = 0.0105 * (V)^{2.06}
 D50 = 0.0105 * (8.90)^{2.06}
 D50 = 0.95 FT

- NOTES:**
- THE PROPOSED POND IS TO BE PRIVATELY MAINTAINED AND OWNED.
 - HANDRAIL TO BE PROVIDED AROUND ENTIRE POND. REFERENCE LANDSCAPE PLANS.
 - GRAVITY WALLS TO ALLOW FOR SHEET FLOW FROM SIDEWALKS AND LANDSCAPING AROUND POND TO DRAIN INTO POND.
 - CONTRACTOR TO PROVIDE SEPARATE COST, AS A BID ALTERNATIVE, FOR A POND LINER. REFERENCE GEOTECHNICAL REPORT FOR POND LINER OPTIONS AND SPECIFICATIONS.

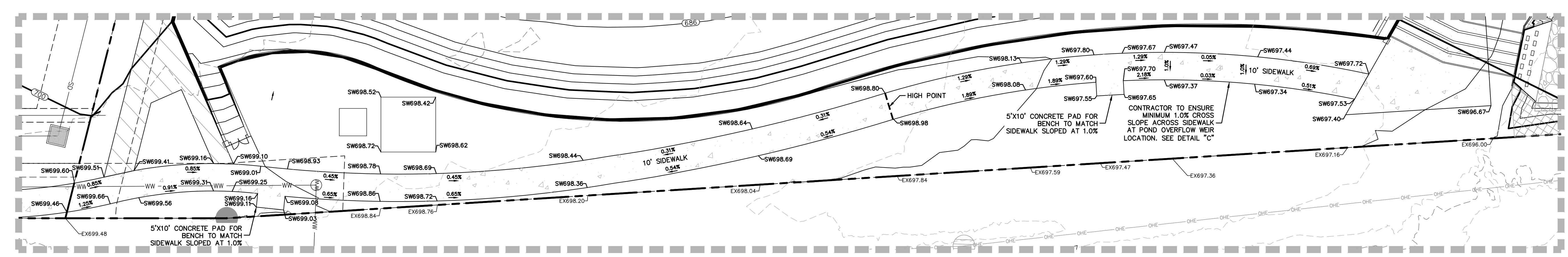

SIDEWALK SH-130 DETAIL WITH SPOTS
1" = 20'

NO.	REVISION	DATE



PAPE-DAWSON ENGINEERS

AUSTIN | SAN ANTONIO | HOUSTON | FORT WORTH | DALLAS
 1808 N. MOPAC EXPY., SUITE 301, AUSTIN, TX 78758 | 512-464-8871
 TPELIS FIRM REGISTRATION #470 | TPELIS FIRM REGISTRATION #1002861

**NORTHPOINTE EAST TRACT
 PUBLIC INFRASTRUCTURE
 PFLUGERVILLE, TEXAS
 DETENTION POND PLAN**

JOB NO.	51084-03
DATE	AUGUST 2024
DESIGNER	TR
CHECKED	BT
DRAWN	JR
SHEET	36 of 77

Date: Oct 21, 2024, 9:30am User ID: TRIEX
 File: \\pape-dawson.com\user-pd\Projects\51084\03\301_Construction_Documents\Civil\51084-03.dwg
 THIS DOCUMENT HAS BEEN PRODUCED FROM MATERIAL THAT WAS STORED AND/OR TRANSMITTED ELECTRONICALLY AND MAY HAVE BEEN INADVERTENTLY ALTERED. RELY ONLY ON FINAL HARD COPY MATERIALS BEARING THE CONSULTANT'S ORIGINAL SIGNATURE AND SEAL.

REFERENCE NOTES SCHEDULE

SYMBOL	AGGREGATES DESCRIPTION	DETAIL
AG-01	DECORATIVE GRAVEL	E/L4.01
AG-02	BOULDERS	G/L4.01
SYMBOL	METAL DESCRIPTION	DETAIL
M-01	GUARDRAIL	A/L4.02
M-02	STEEL EDGING	V/L4.01
M-03	SHADE STRUCTURE	A/L4.03
M-04	MAINTENANCE GATE	E/L4.02
SYMBOL	PAVING DESCRIPTION	DETAIL
P-01	CONCRETE (NATURAL)	B/L4.01
P-02	CONCRETE (ENHANCED)	B/L4.01
P-03	PAVERS	D/L4.01
SYMBOL	SITE FURNISHINGS DESCRIPTION	DETAIL
S-01	TRASH RECEPTACLE	PER MANUFACTURER SPECS.
S-02	BENCH	PER MANUFACTURER SPECS.
S-03	TABLES + CHAIRS	PER MANUFACTURER SPECS.
SYMBOL	WALL DESCRIPTION	DETAIL
W-01	POND RETAINING WALL (GRAVITY)(BY OTHERS)	J/L4.01
W-02	POND RETAINING WALL (CONCRETE)(CAPSTONE ONLY)	B/L4.02
W-03	POND RETAINING WALL COLUMNS (STONE VENEER/CAP ONLY)	C/L4.02 & D/L4.02
W-04	STONE BLOCKWALL	H/L4.01
W-05	STEEL RETAINING WALL	B/L4.04

NORTHING/EASTING POINT SCHEDULE

POINT	DESCRIPTION	NORTHING	EASTING
1	SIDEWALK CL	N 10141247.07	E 3100468.88
2	SIDEWALK CL	N 10141179.26	E 3100432.78
3	SIDEWALK CL	N 1014123.99	E 3100391.90
4	SIDEWALK CL	N 10140986.53	E 3100322.66
5	SIDEWALK CL	N 10140827.20	E 3100230.49
6	SIDEWALK EDGE	N 10140823.37	E 3100237.82
7	SIDEWALK CL	N 10140807.79	E 3100228.73
8	SIDEWALK CL	N 10140780.71	E 3100230.04
9	SIDEWALK EDGE	N 10140803.19	E 3100180.47
10	SIDEWALK CL	N 10140803.58	E 3100185.74
11	SIDEWALK CL	N 10141022.83	E 3100172.30
12	SIDEWALK CL	N 10141098.73	E 3100150.56
13	SIDEWALK CL	N 10141123.07	E 3100145.55
14	SIDEWALK CL	N 10141251.61	E 3100137.14
15	SIDEWALK EDGE	N 10141261.23	E 3100142.56
16	SIDEWALK EDGE	N 10141297.44	E 3100138.84
17	SIDEWALK EDGE	N 10141238.59	E 3100460.59
18	SIDEWALK EDGE	N 10141185.06	E 3100432.19
19	SIDEWALK CL	N 10141305.19	E 3100131.74
20	SIDEWALK CL	N 10141351.12	E 3100124.52
21	SIDEWALK CL	N 10141443.76	E 3100121.14
22	SIDEWALK CL	N 10141466.07	E 3100115.94
23	SIDEWALK CL	N 10141553.90	E 3100119.67
24	SIDEWALK CL	N 10141630.47	E 3100115.75
25	SIDEWALK CL	N 10141738.18	E 3100113.13
26	SIDEWALK CL	N 10141818.64	E 3100107.48
27	SIDEWALK CL	N 10141866.57	E 3100105.73

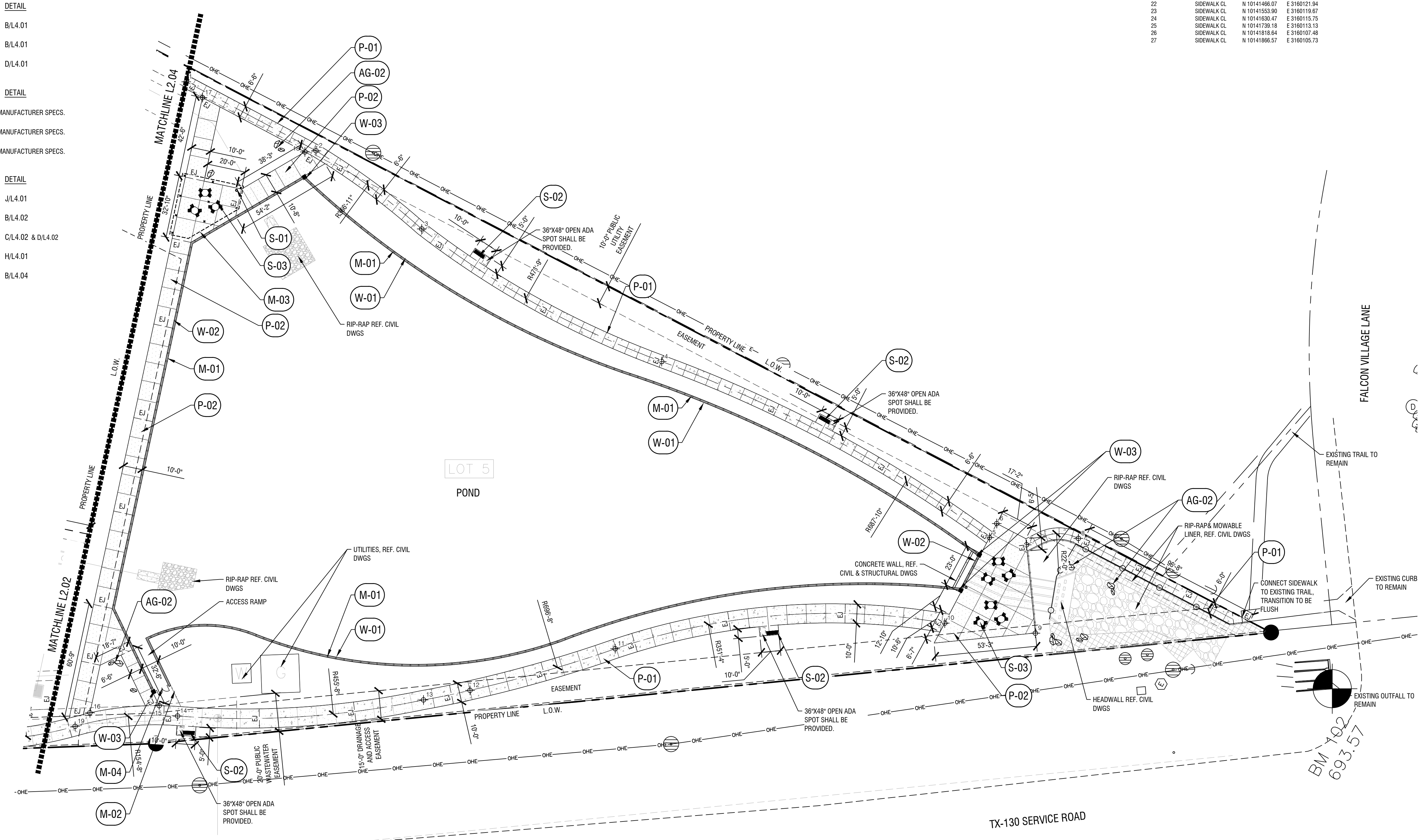

NO.	REVISION	DATE

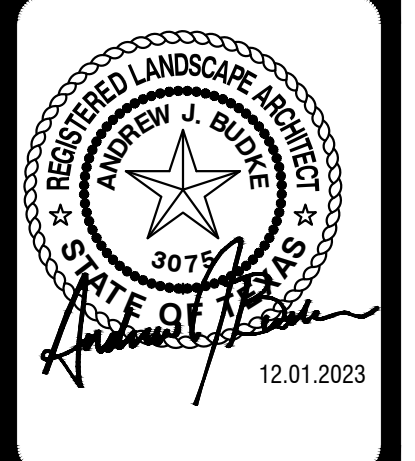

12.01.2023

Kimley»Horn
 © 2024 KIMLEY-HORN AND ASSOCIATES, INC.
 260 EAST DAVIS STREET, SUITE 100, MCKINNEY, TX 75069
 PHONE: 469-301-2880
 WWW.KIMLEY-HORN.COM TX-F-928

NORTHPOINTE EAST TRACT PUBLIC INFRASTRUCTURE
 PFLUGERVILLE, TEXAS
 HARDSCAPE PLAN

JOB NO. 51084-03
 DATE December 01, 2023
 DESIGNER
 CHECKED AJB DRAWN AMH
 SHEET L2.01

Date: Dec 01, 2023, 10:41am, User: Anne.Hornhorn, File: K:\WORK\LAIF\Projects\087545010 - Northpointe - Trademark\CAD\Sheets\L2.01 - HARDSCAPE AND LAYOUT PLAN.dwg

THIS DOCUMENT HAS BEEN PRODUCED FROM MATERIAL THAT WAS STORED AND/OR TRANSMITTED ELECTRONICALLY AND MAY HAVE BEEN INADVERTENTLY ALTERED. RELY ONLY ON FINAL HARDCOPY MATERIALS BEARING THE CONSULTANT'S ORIGINAL SIGNATURE AND SEAL.

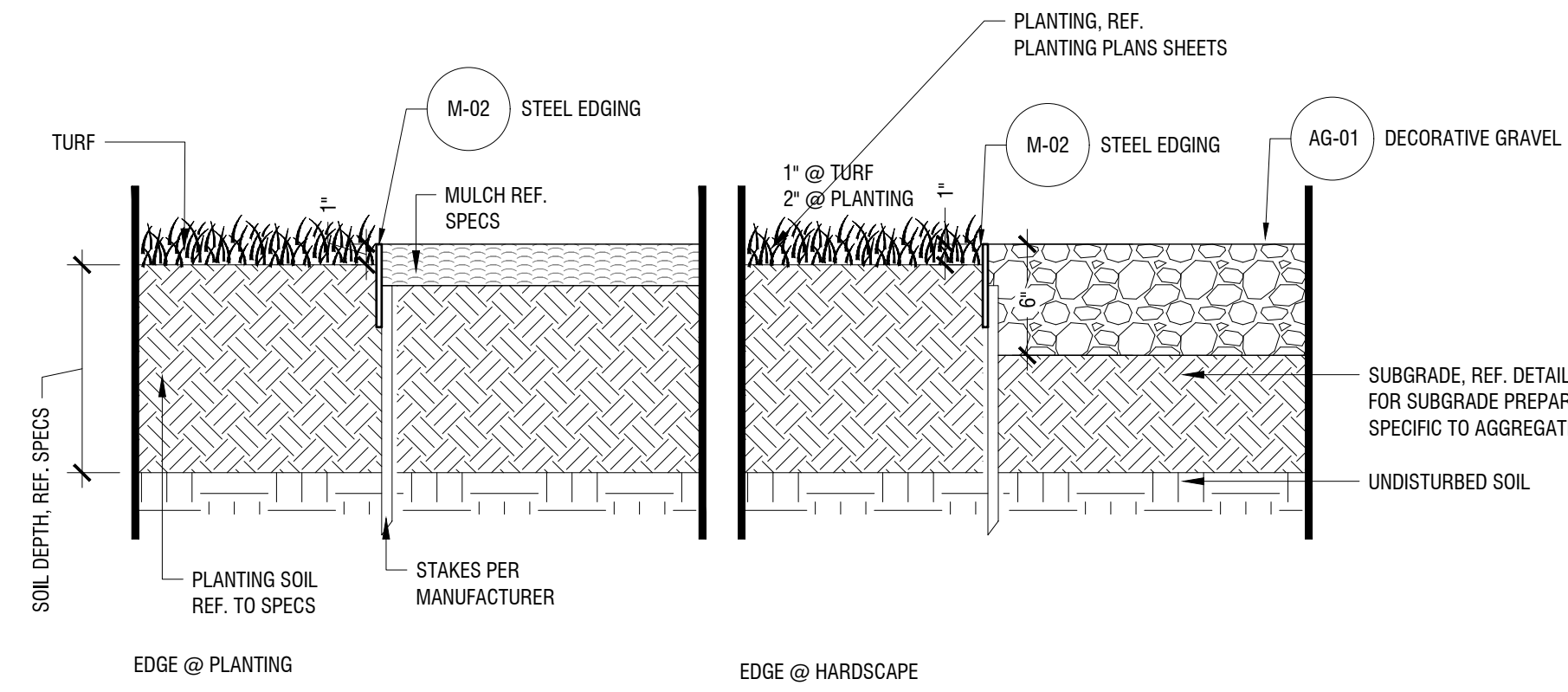

STEEL EDGING

P-PA-NOR-12

Scale: 1 1/2" = 1'-0"

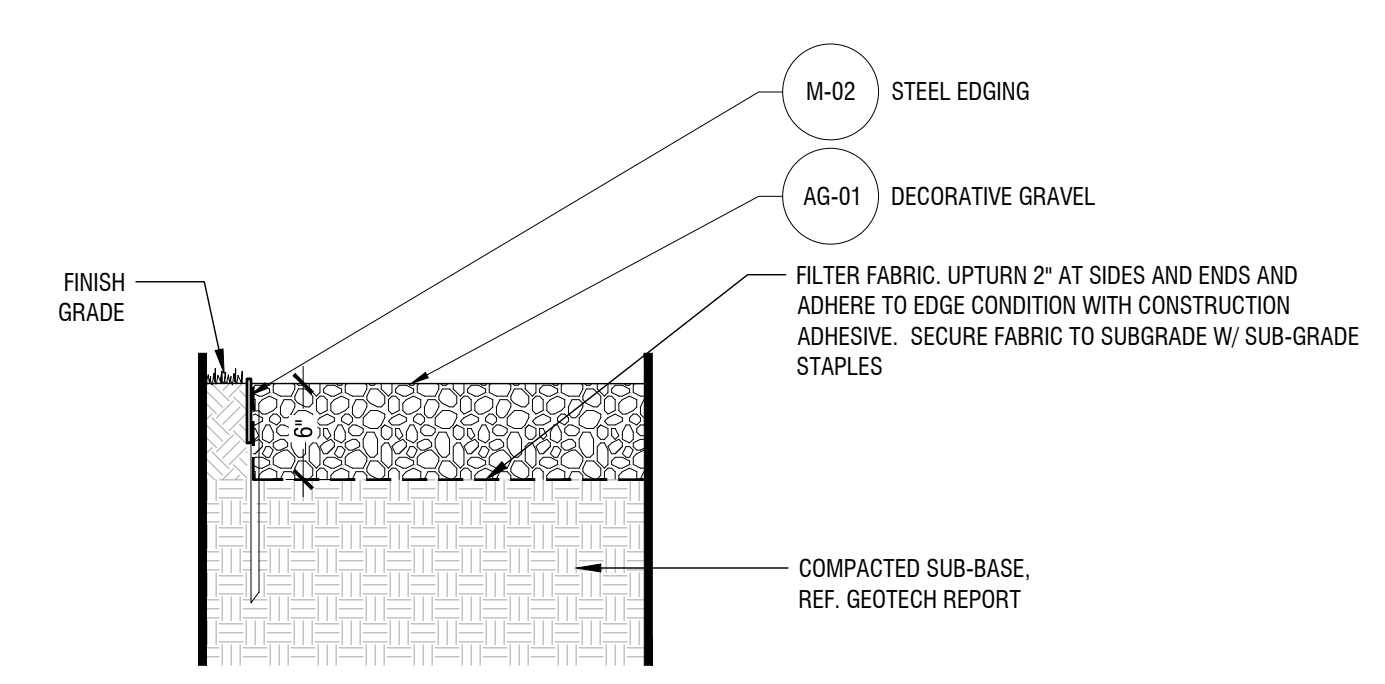

DECORATIVE GRAVEL @ PLANTING

P-PA-NOR-05

Scale: 1" = 1'-0"

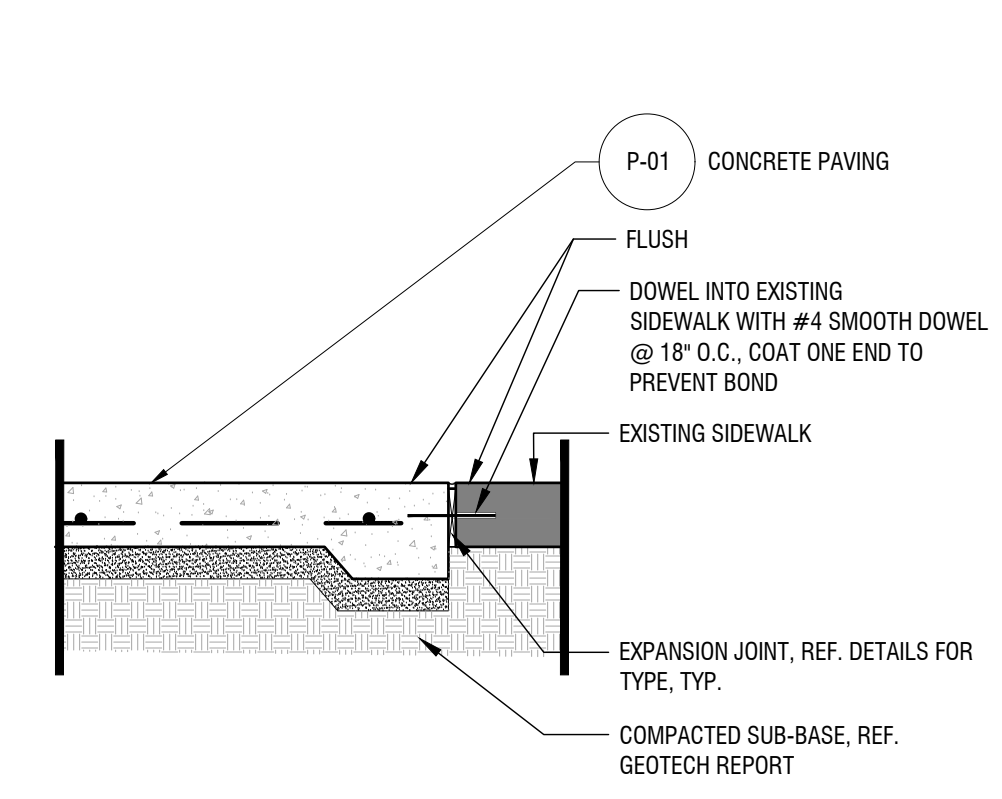

CONCRETE PAVING AT EXISTING SIDEWALK

P-PA-NOR-04

Scale: 1" = 1'-0"

- NOTES:
1. WALL DETAIL SHOWN IN PLAN AND DETAIL FOR REFERENCE ONLY. SITE RETAINING WALLS TO BE DESIGNED BY WALL CONTRACTOR & IS SHOWN IN KIMLEY HORN PLANS FOR REFERENCE ONLY.
 2. PROVIDE SAMPLES AND SHOP DRAWINGS FOR OWNER'S APPROVAL.
 3. DRAINAGE AT WALL TO BE DESIGNED BY CONTRACTOR.
 4. STONE GRAVITY WALL TO BE MORTAR SET.
 5. STRUCTURAL ENGINEER TO REVIEW FENCE POST SIZE & SPACING FOR ALL FENCES @ WALL.

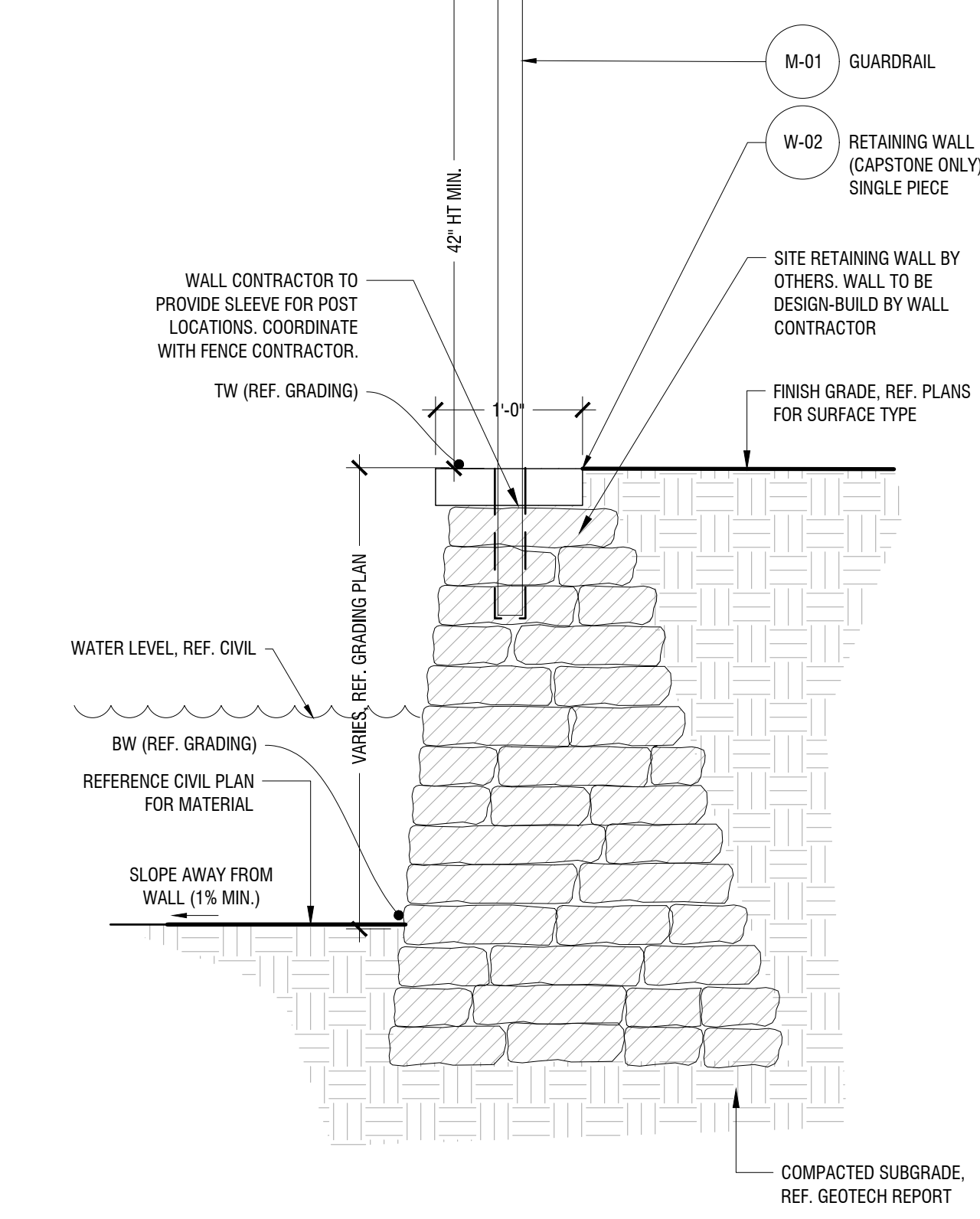

ENGINEERED RETAINING WALL

P-PA-NOR-09

Scale: 1" = 1'-0"

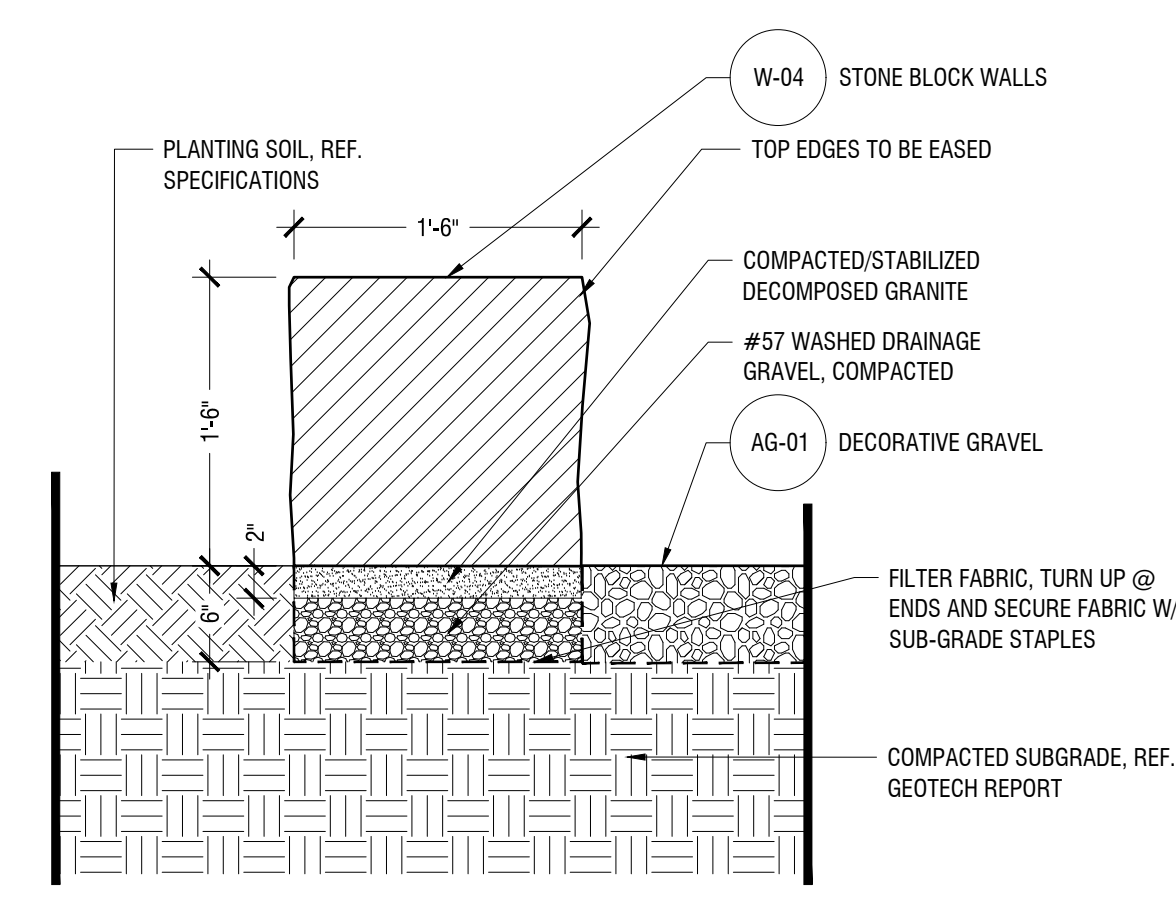

STONE BLOCK WALL

P-PA-NOR-07

Scale: 1" = 1'-0"

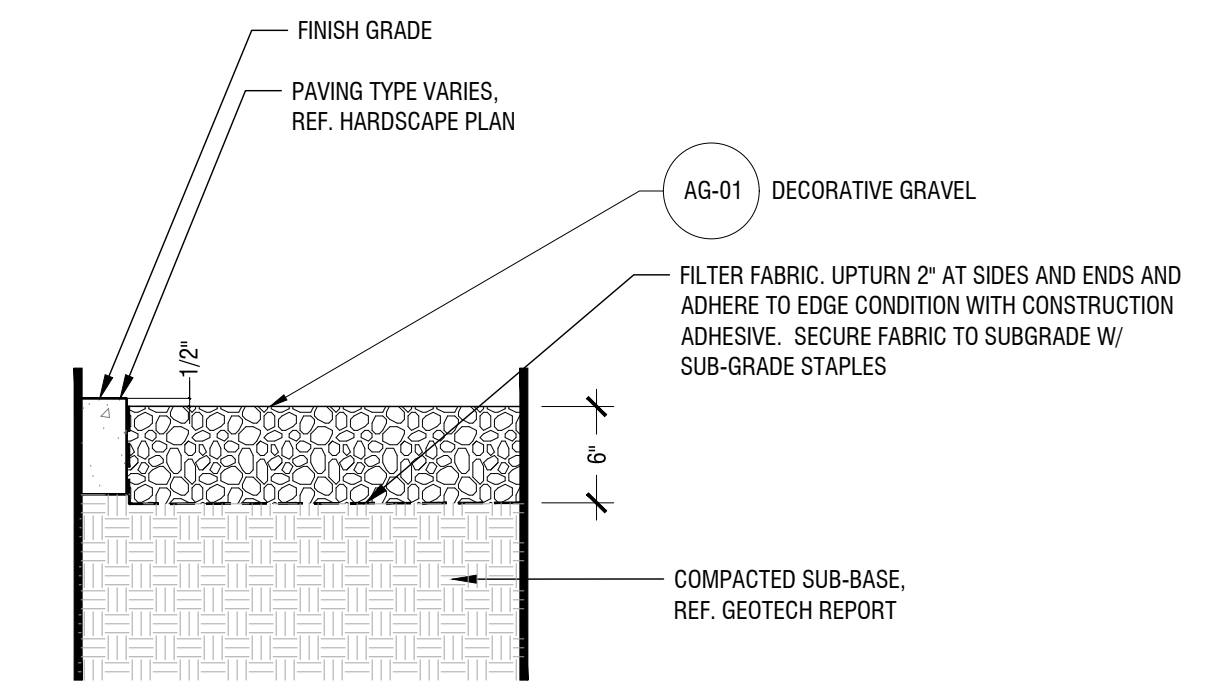

DECORATIVE GRAVEL @ PAVING

P-PA-NOR-06

Scale: 1" = 1'-0"

- NOTES:
1. ALL VEHICULAR CONCRETE TO BE DESIGNED BY CIVIL ENGINEER.
 2. ALL PAVING TO MEET SUBGRADE PREPARATION PER GEOTECH REPORT.
 3. ALL PAVING IN CITY ROW TO MEET CITY STANDARDS.
 4. ALL PEDESTRIAN PAVING TO BE 4,000 PSI.

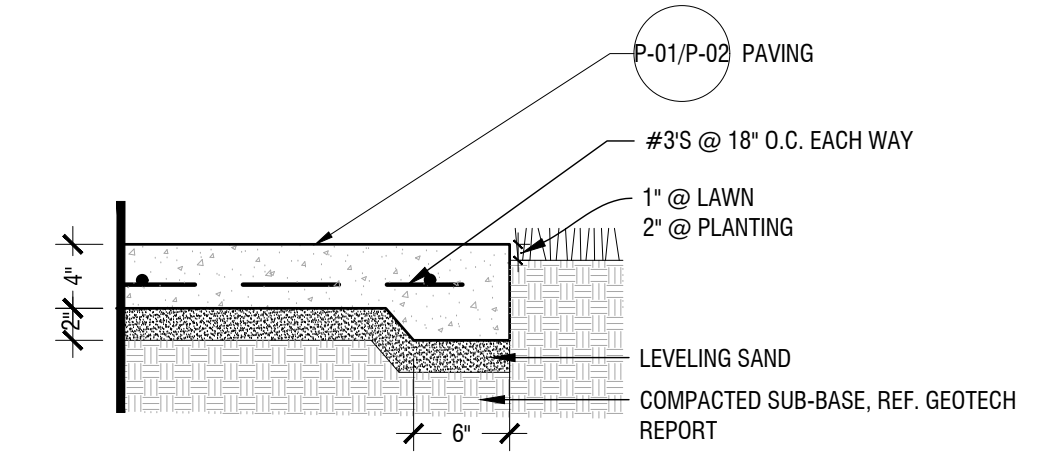

TYP. CONCRETE PAVING

P-PA-NOR-02

Scale: 1" = 1'-0"

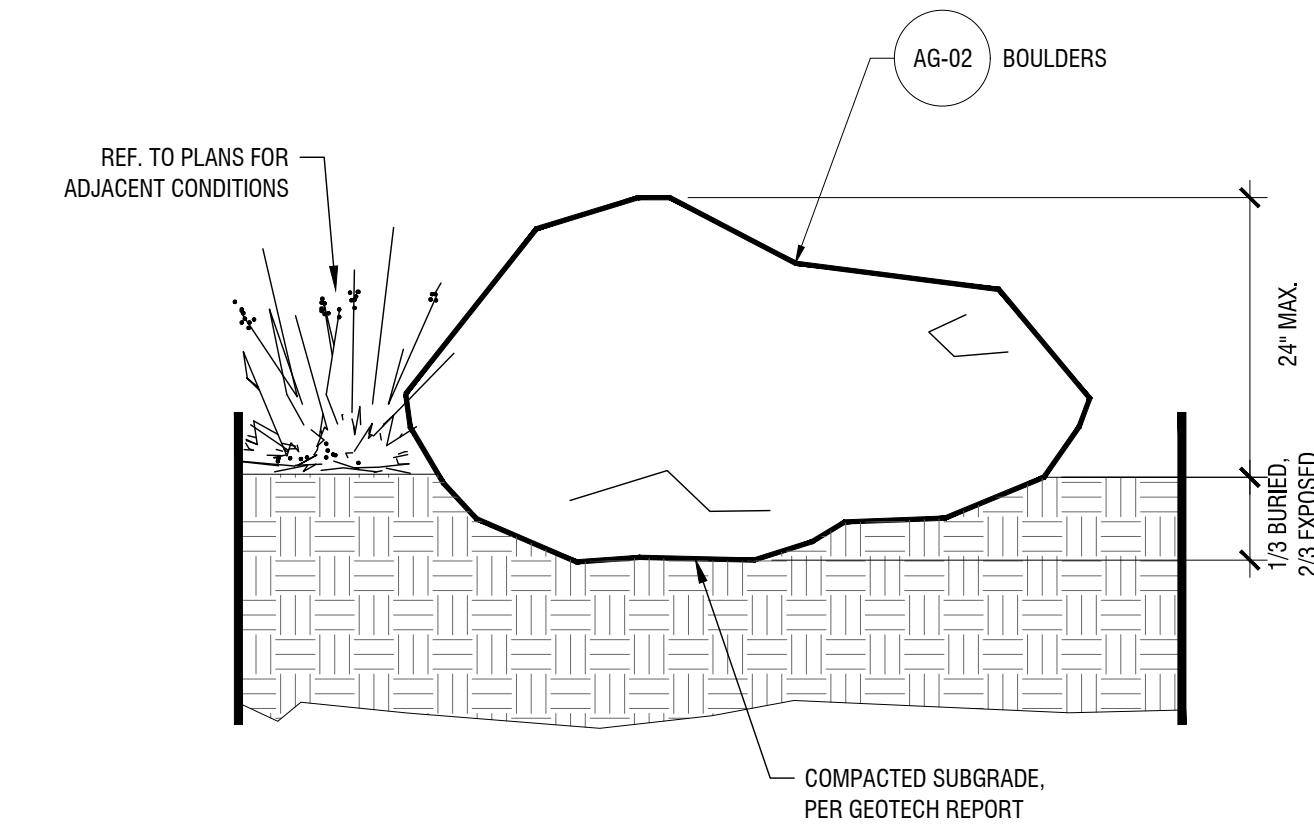

BOULDERS

P-PA-NOR-11

Scale: 1" = 1'-0"

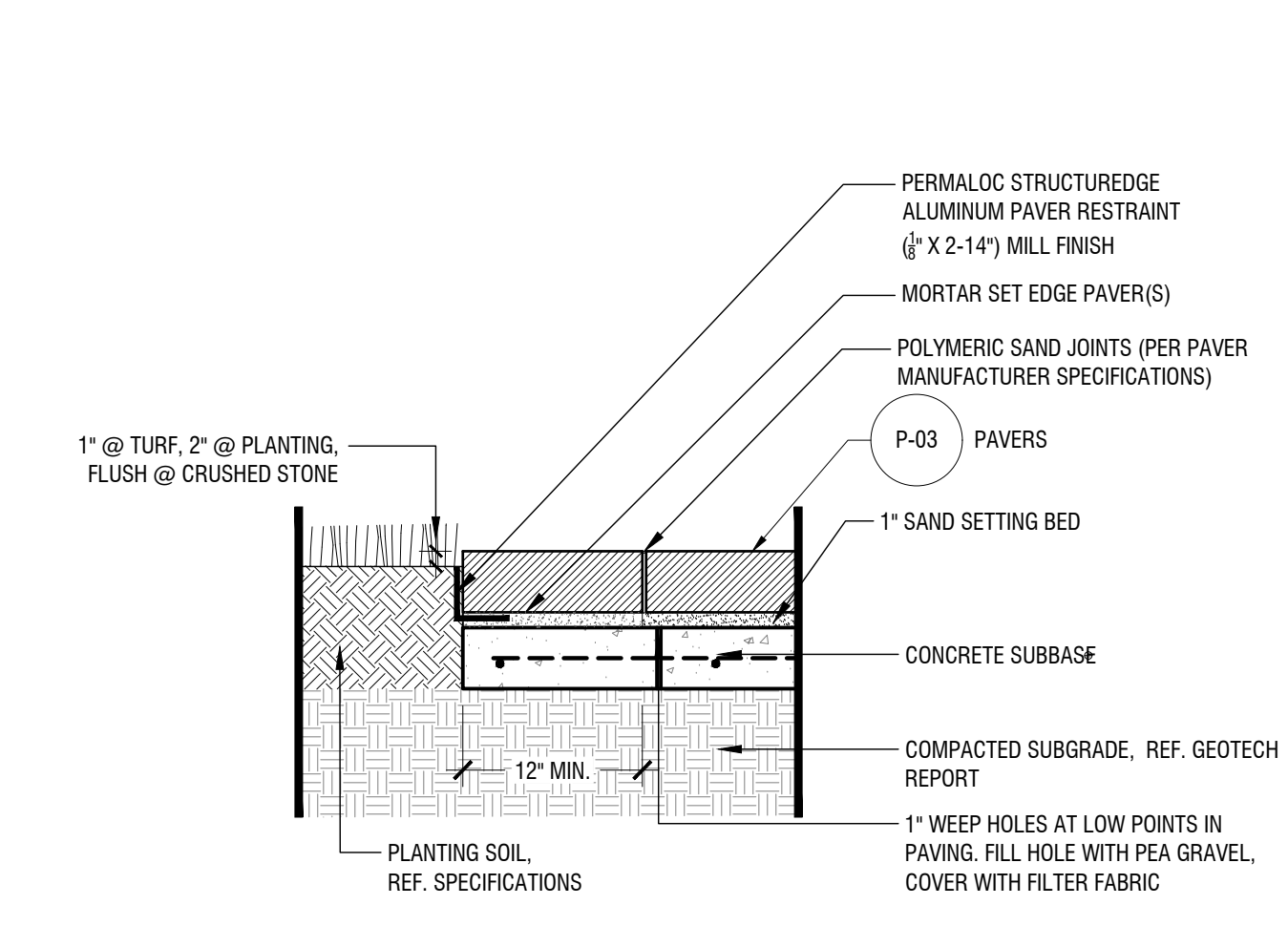

PAVERS

P-PA-NOR-03

Scale: 1" = 1'-0"

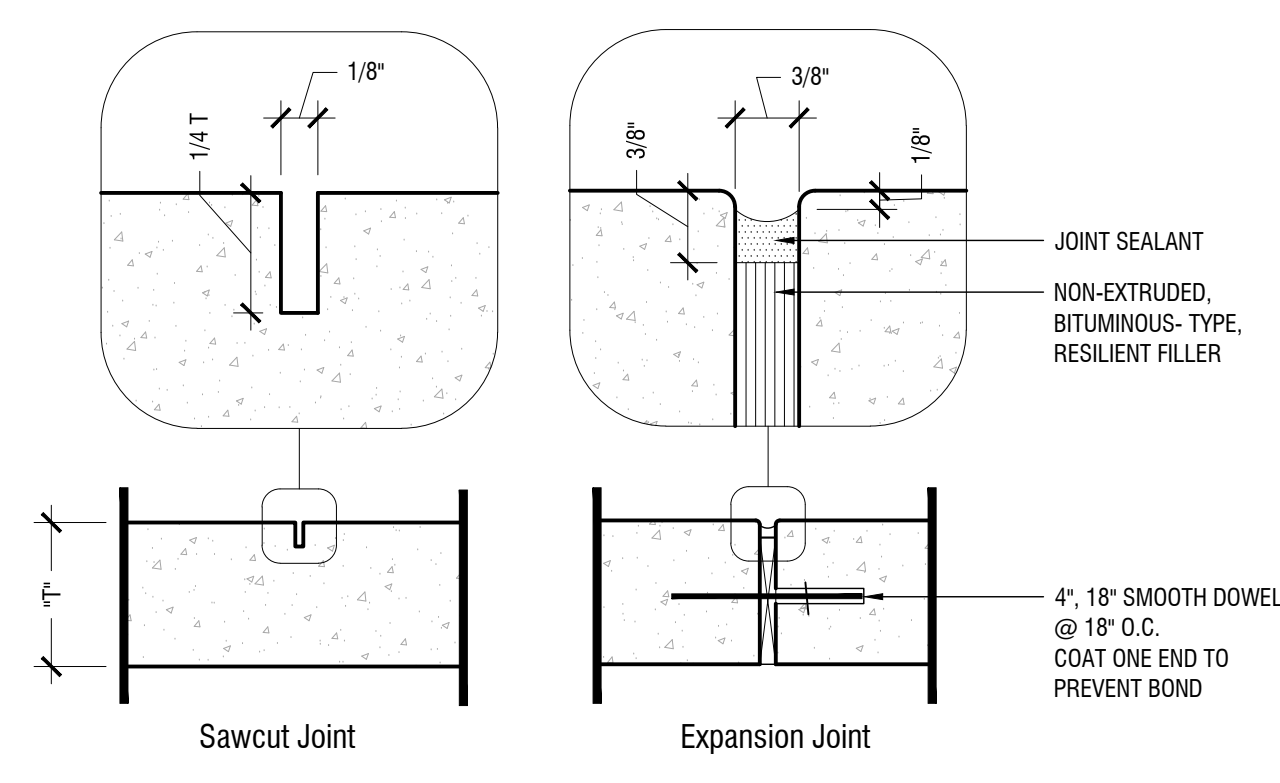

CONCRETE PAVING JOINTS

P-PA-NOR-01

N.T.S.

NO.	REVISION	DATE

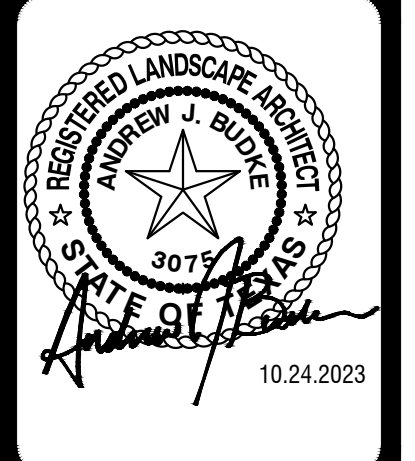

10.24.2023

Kimley»Horn
 © 2024 KIMLEY-HORN AND ASSOCIATES, INC.
 260 EAST DAVIS STREET, SUITE 100, MCKINNEY, TX 75069
 PHONE: 469-301-2880
 WWW.KIMLEY-HORN.COM TX F-928

**NORTHPOINTE EAST TRACT
 PUBLIC INFRASTRUCTURE**
 PFLUGERVILLE, TEXAS
 HARDSCAPE DETAILS

JOB NO. 51084-03
 DATE October 24, 2023
 DESIGNER
 CHECKED A.B. DRAWN AMH.
 SHEET L4.01

Date: Oct 24, 2023, 5:03pm User ID: Anne.Horn
 File: K:\WORK\LAPE\Projects\087545010 - Northpointe - Trademark\CAD\Sheets\L4.01 HARDSCAPE DETAILS.dwg
 THIS DOCUMENT HAS BEEN PRODUCED FROM MATERIAL THAT WAS STORED AND/OR TRANSMITTED ELECTRONICALLY AND MAY HAVE BEEN INADVERTENTLY ALTERED. RELY ONLY ON FINAL HARD COPY MATERIALS BEARING THE CONSULTANT'S ORIGINAL SIGNATURE AND SEAL.

NOTES:

1. COLUMN DETAIL SHOWN IN PLAN AND DETAIL FOR REFERENCE ONLY. COLUMNS TO BE DESIGNED BY WALL CONTRACTOR & IS SHOWN IN KIMLEY HORN PLANS FOR REFERENCE ONLY.
2. PROVIDE SAMPLES AND SHOP DRAWINGS FOR OWNER'S APPROVAL.
3. DRAINAGE AT WALL TO BE DESIGNED BY CONTRACTOR.

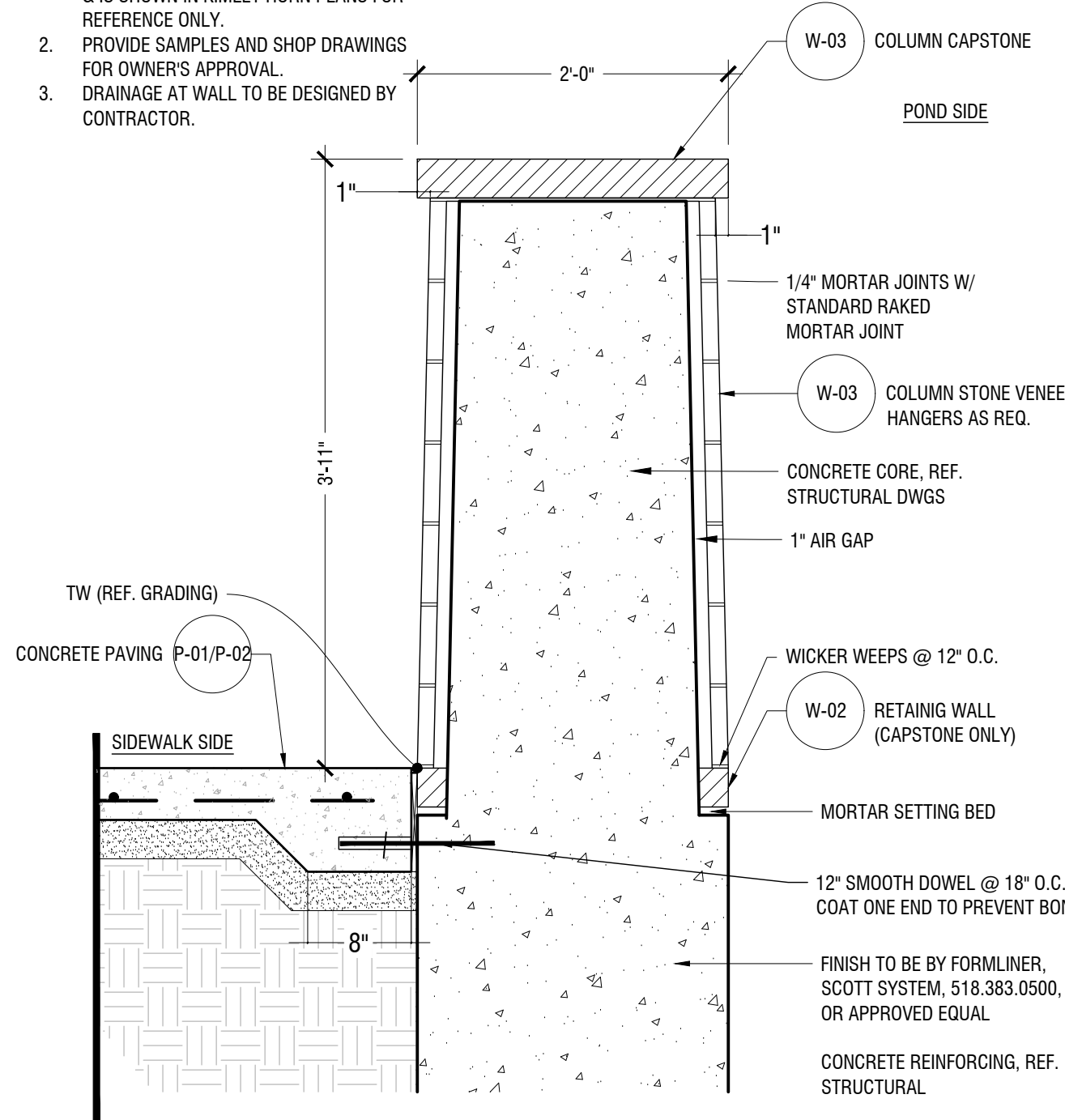

RETAINING WALL COLUMN

P-PA-NOR-13 Scale: 1" = 1'-0"

NOTES:

1. COLUMN DETAIL SHOWN IN PLAN AND DETAIL FOR REFERENCE ONLY. COLUMNS TO BE DESIGNED BY WALL CONTRACTOR & IS SHOWN IN KIMLEY HORN PLANS FOR REFERENCE ONLY.
2. PROVIDE SAMPLES AND SHOP DRAWINGS FOR OWNER'S APPROVAL.
3. DRAINAGE AT WALL TO BE DESIGNED BY CONTRACTOR.

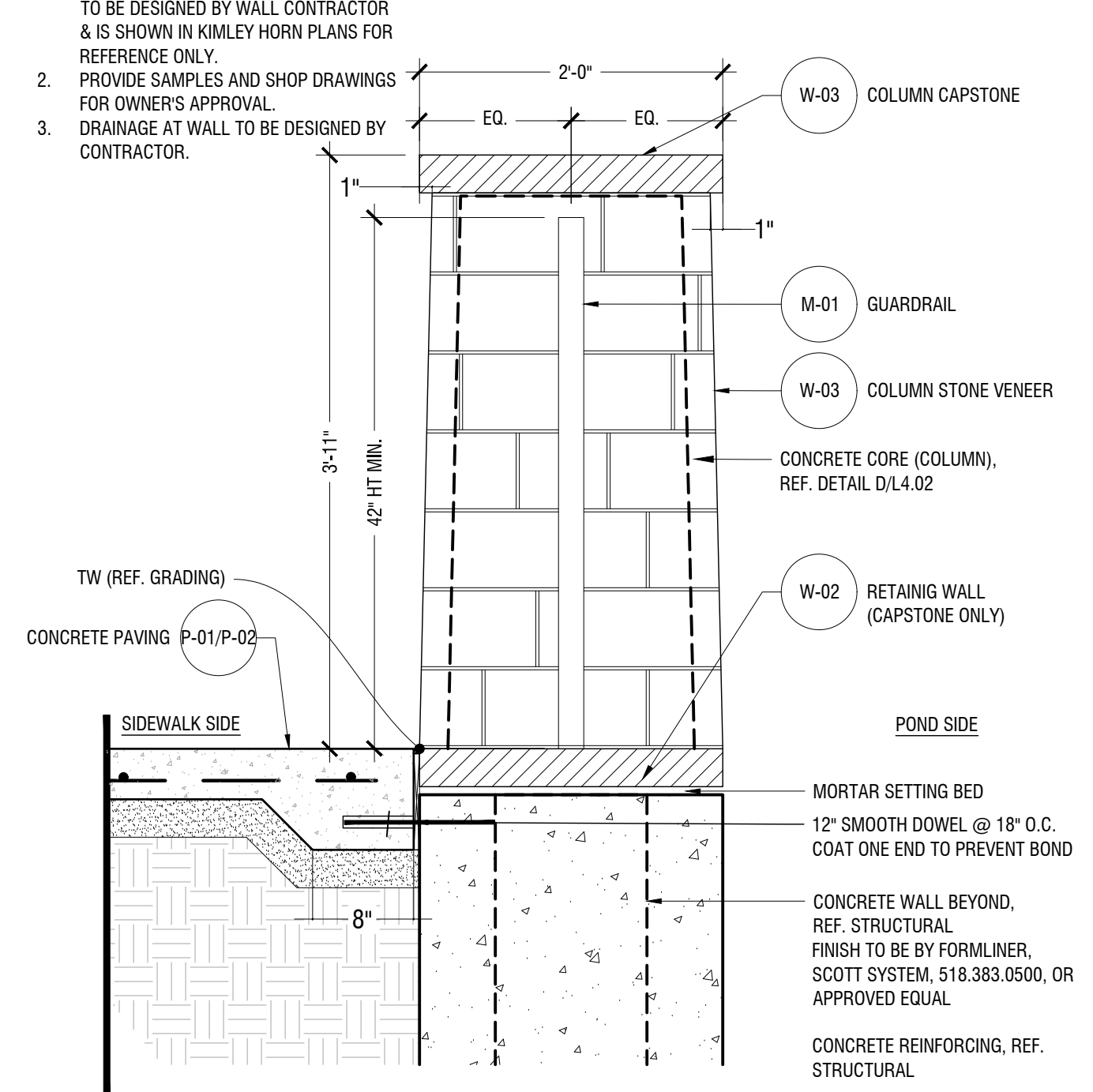

RETAINING WALL COLUMN

P-PA-NOR-14 Scale: 1" = 1'-0"

NOTES:

1. WALL DETAIL SHOWN IN PLAN AND DETAIL FOR REFERENCE ONLY. SITE RETAINING WALLS TO BE DESIGNED BY WALL CONTRACTOR & IS SHOWN IN KIMLEY HORN PLANS FOR REFERENCE ONLY.
2. PROVIDE SAMPLES AND SHOP DRAWINGS FOR OWNER'S APPROVAL.
3. DRAINAGE AT WALL TO BE DESIGNED BY CONTRACTOR.
4. STRUCTURAL ENGINEER TO REVIEW FENCE POST SIZE & SPACING FOR ALL FENCES @ WALL.

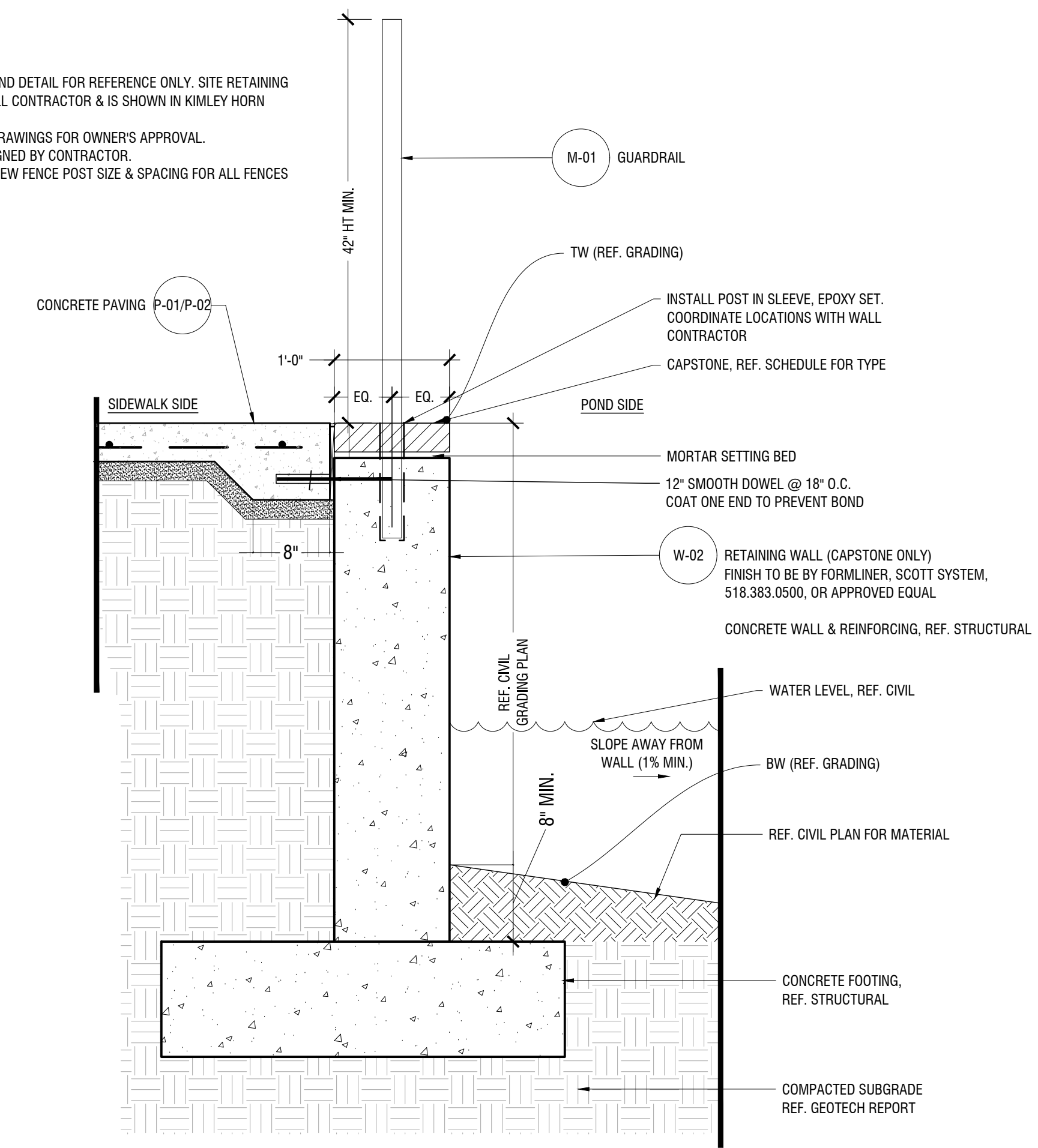

ENGINEERED RETAINING WALL

P-PA-NOR-10 Scale: 1" = 1'-0"

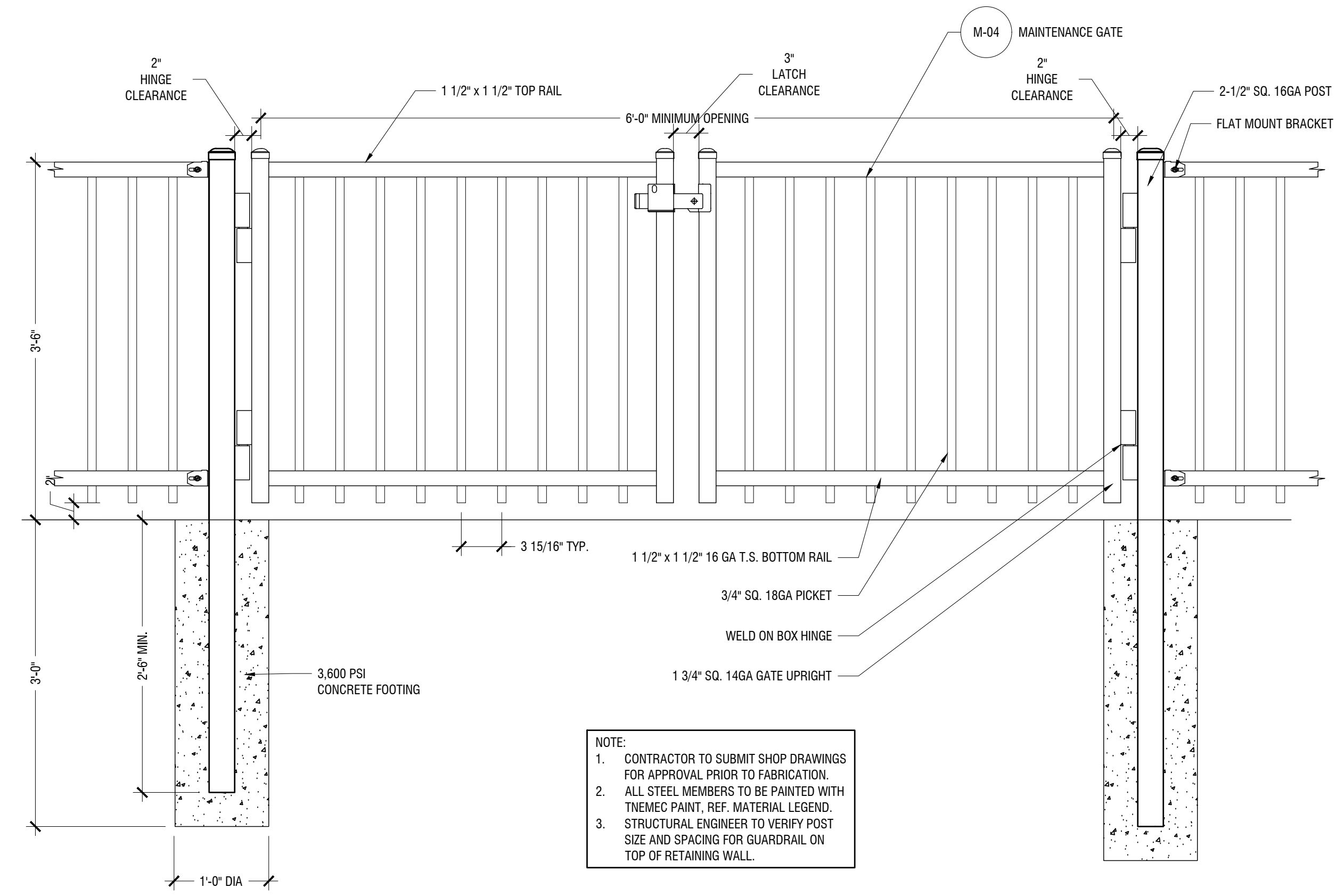

MAINTENANCE GATE

P-PA-NOR-25 Scale: 1" = 1'-0"

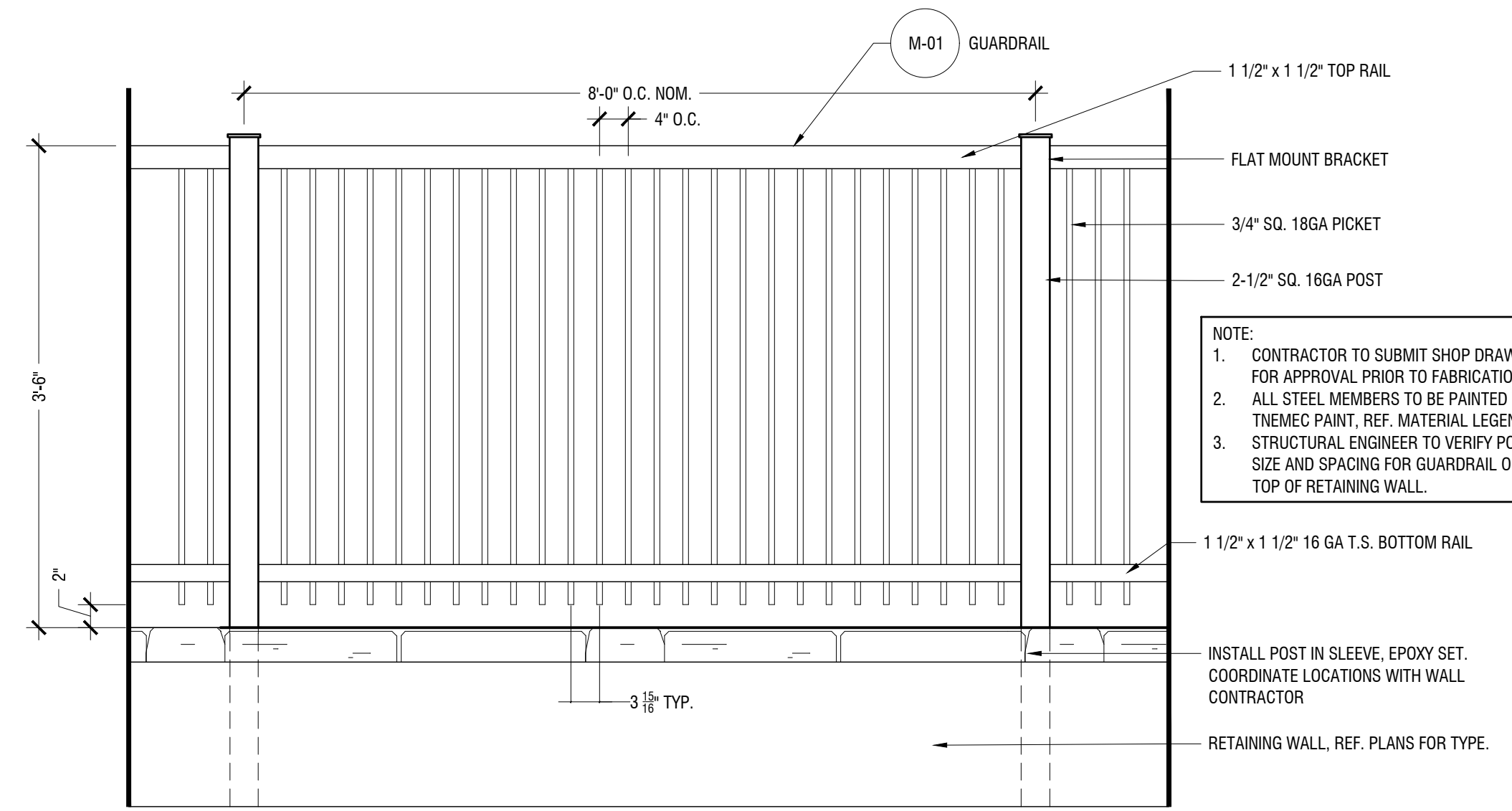

GUARDRAIL

P-PA-NOR-08 Scale: 1" = 1'-0"

NO.	REVISION	DATE

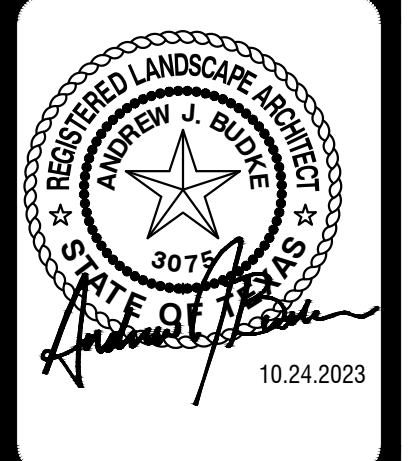

Kimley»Horn
 © 2021 KIMLEY-HORN AND ASSOCIATES, INC.
 260 EAST DAVIS STREET, SUITE 100, MCKINNEY, TX 75069
 PHONE: 469-301-2880
 WWW.KIMLEY-HORN.COM TX F-928

**NORTHPOINTE EAST TRACT
 PUBLIC INFRASTRUCTURE**
 PFLUGERVILLE, TEXAS
 HARDSCAPE DETAILS

JOB NO. 51084-03
 DATE October 24, 2023
 DESIGNER
 CHECKED AJB DRAWN AMH
 SHEET L4.02

Date: Oct 24, 2023, 5:03pm User ID: Anne-Hornon File: R:\WORK\LA\Projects\087545010 - Northpointe - Hardscape Details.dwg

THIS DOCUMENT HAS BEEN PRODUCED FROM MATERIAL THAT WAS STORED AND/OR TRANSMITTED ELECTRONICALLY AND MAY HAVE BEEN INADVERTENTLY ALTERED. RELY ONLY ON FINAL HARD COPY MATERIALS BEARING THE CONSULTANT'S ORIGINAL SIGNATURE AND SEAL.

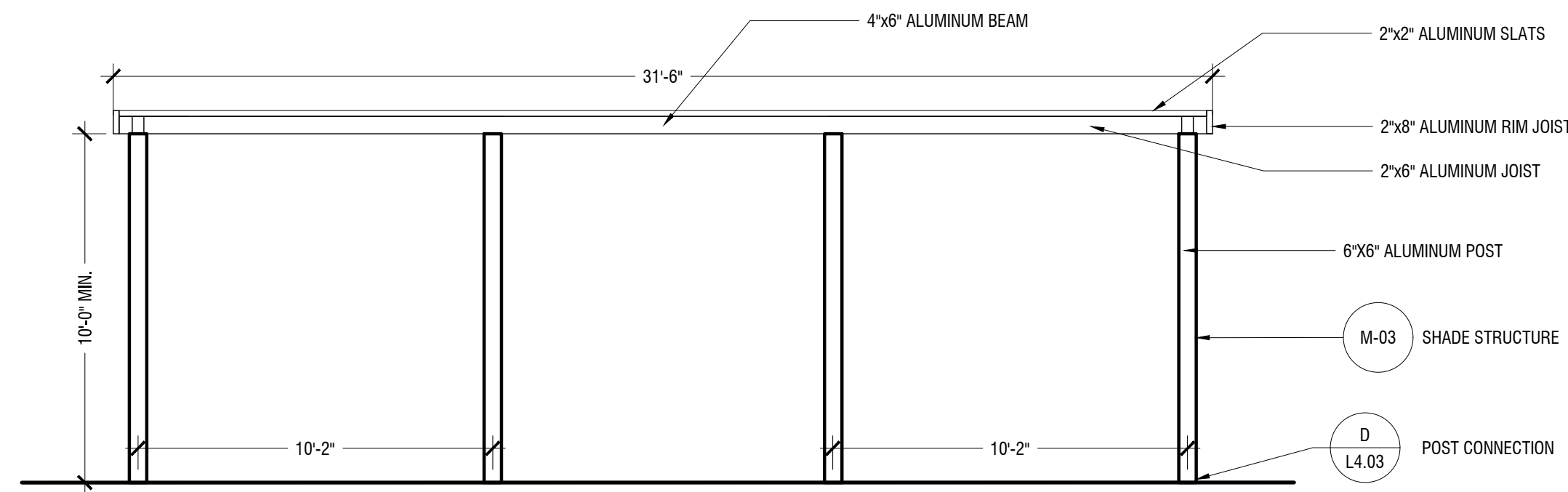

SHADE STRUCTURE ELEVATION

P-PA-NOR-17

Scale: 1/4" = 1'-0"

C

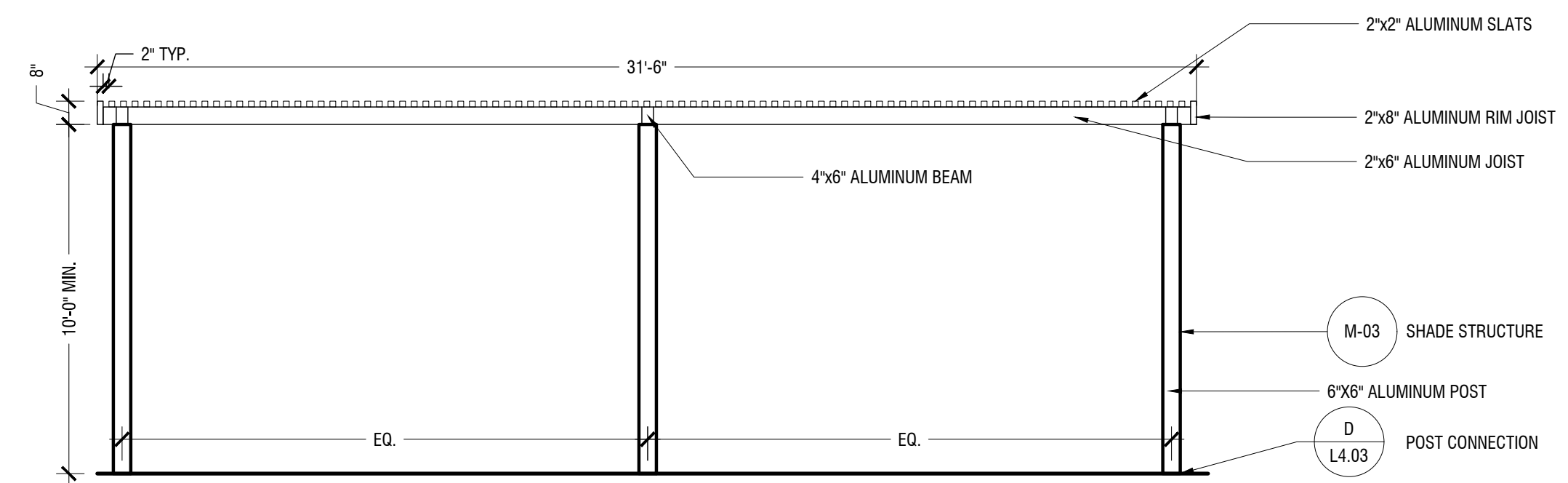

SHADE STRUCTURE ELEVATION

P-PA-NOR-16

Scale: 1/4" = 1'-0"

B

- NOTES:
- SHADE STRUCTURE DESIGN PROVIDED FOR DESIGN INTENT AND LAYOUT ONLY. SHADE STRUCTURE TO BE DESIGN BUILD BY ARCH FAB, INCLUDING ALL STRUCTURAL ENGINEERING, MEMBER SIZING, AND CONNECTIONS DETAILS. CONTRACTOR TO SUBMIT SHOP DRAWINGS, MATERIAL SAMPLES, AND CUT SHEETS FOR REVIEW AND APPROVAL.
 - REFER TO STRUCTURAL PLANS FOR PERFORMANCE SPECIFICATIONS AND PIER DETAILS.
 - SIZE OF METAL STRUCTURAL MEMBERS SHOWN FOR REFERENCE ONLY. FINAL SIZE DETERMINED BY SHADE STRUCTURE MANUFACTURER.

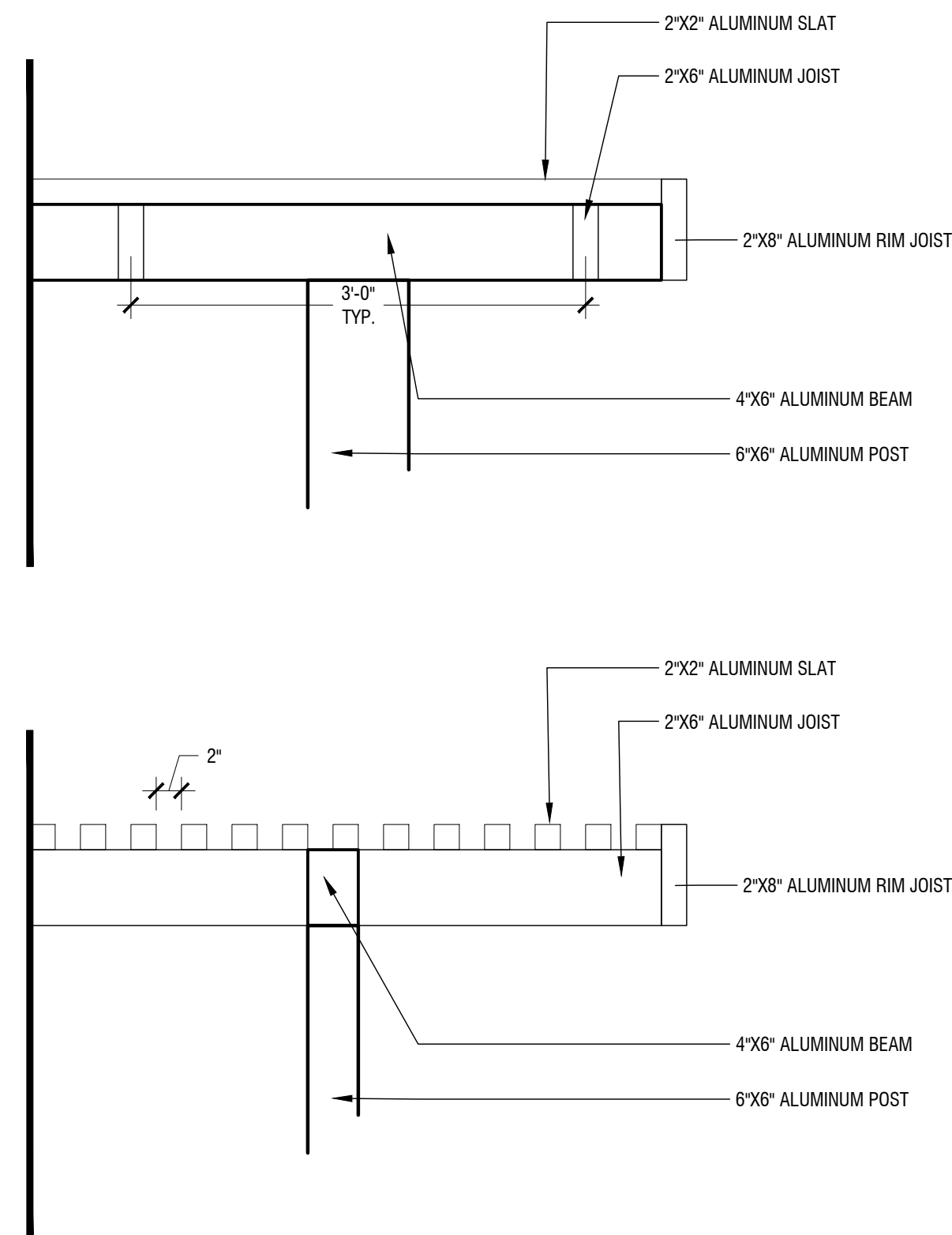

SHADE STRUCTURE BEAM CONNECTION

P-PA-NOR-19

Scale: 1" = 1'-0"

E

- NOTES:
- SHADE STRUCTURE DESIGN PROVIDED FOR DESIGN INTENT AND LAYOUT ONLY. SHADE STRUCTURE TO BE DESIGN BUILD BY ARCH FAB, INCLUDING ALL STRUCTURAL ENGINEERING, MEMBER SIZING, AND CONNECTIONS DETAILS. CONTRACTOR TO SUBMIT SHOP DRAWINGS, MATERIAL SAMPLES, AND CUT SHEETS FOR REVIEW AND APPROVAL.
 - REFER TO STRUCTURAL PLANS FOR PERFORMANCE SPECIFICATIONS AND PIER DETAILS.
 - SIZE OF METAL STRUCTURAL MEMBERS SHOWN FOR REFERENCE ONLY. FINAL SIZE DETERMINED BY SHADE STRUCTURE MANUFACTURER.

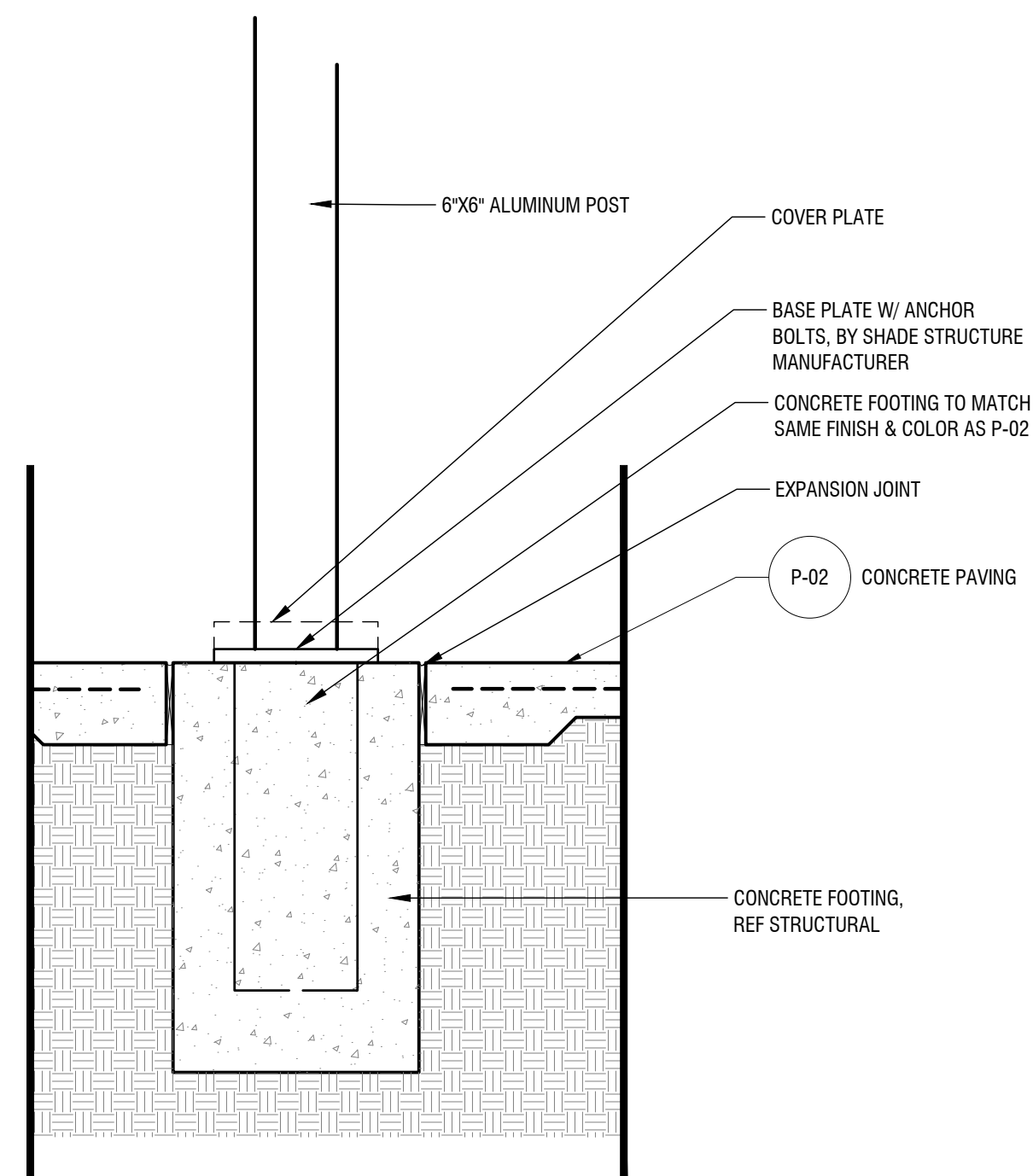

POST CONNECTION

P-PA-NOR-18

Scale: 1" = 1'-0"

D

- NOTES:
- SHADE STRUCTURE DESIGN PROVIDED FOR DESIGN INTENT AND LAYOUT ONLY. SHADE STRUCTURE TO BE DESIGN BUILD BY ARCH FAB, INCLUDING ALL STRUCTURAL ENGINEERING, MEMBER SIZING, AND CONNECTIONS DETAILS. CONTRACTOR TO SUBMIT SHOP DRAWINGS, MATERIAL SAMPLES, AND CUT SHEETS FOR REVIEW AND APPROVAL.
 - REFER TO STRUCTURAL PLANS FOR PERFORMANCE SPECIFICATIONS AND PIER DETAILS.
 - SIZE OF METAL STRUCTURAL MEMBERS SHOWN FOR REFERENCE ONLY. FINAL SIZE DETERMINED BY SHADE STRUCTURE MANUFACTURER.

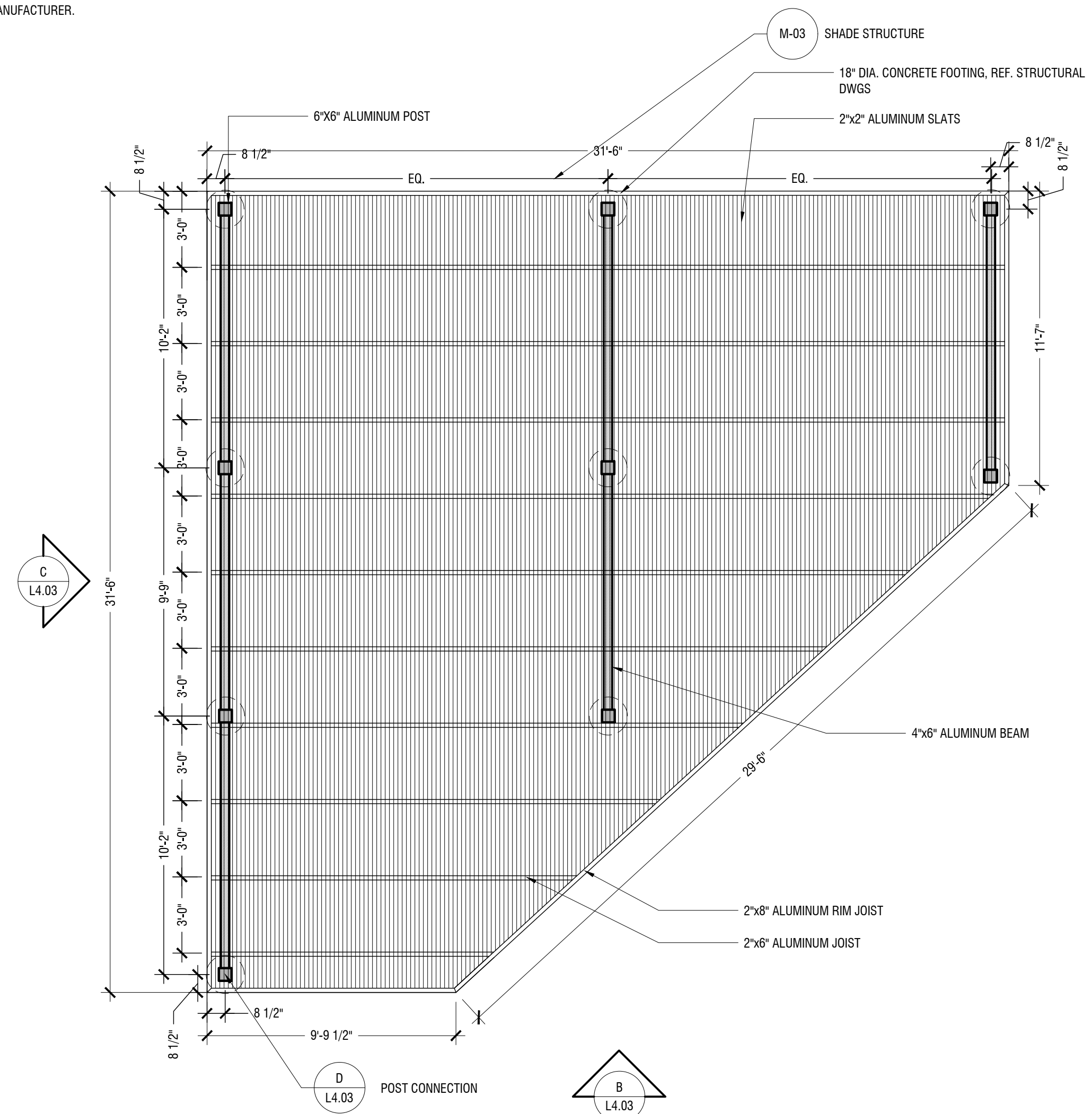

SHADE STRUCTURE PLAN

P-PA-NOR-15

Scale: 1/4" = 1'-0"

A

NO.	REVISION	DATE



Kimley»Horn
 © 2024 KIMLEY-HORN AND ASSOCIATES, INC.
 260 EAST DAVIS STREET, SUITE 100, MCKINNEY, TX 75069
 PHONE: 469-501-2880
 WWW.KIMLEY-HORN.COM TX F-928

**NORTHPOINTE EAST TRACT
 PUBLIC INFRASTRUCTURE**
 PFLUGERVILLE, TEXAS
 HARDSCAPE DETAILS

JOB NO. 51084-03
 DATE October 24, 2023
 DESIGNER
 CHECKED AJB DRAWN AMH
 SHEET L4.03

NO.	REVISION	DATE

10.14.2024

Kimley»Horn
 © 2024 KIMLEY-HORN AND ASSOCIATES, INC.
 260 EAST DAVIS STREET, SUITE 100, MCKINNEY, TX 75069
 PHONE: 469-301-2890
 WWW.KIMLEY-HORN.COM TX F-928

**NORTHPOINTE EAST TRACT
 PUBLIC INFRASTRUCTURE
 PFLUGERVILLE, TEXAS
 PLANTING PLAN**

JOB NO. 51084-03
 DATE October 14, 2024
 DESIGNER
 CHECKED AJB DRAWN AMH
 SHEET L5.01

CASE NO. CON2024-00314

PLANT SCHEDULE

SYMBOL	COMMON / BOTANICAL NAME	QTY
TREES		
	Bald Cypress / Taxodium distichum	14
	Cedar Elm / Ulmus crassifolia	15
	Live Oak / Quercus virginiana	9
	Red Oak / Quercus rubra	12
ORNAMENTAL TREES		
	Purple Smoke Tree / Cotinus coggygria 'Atropurpurea'	12
	Texas Mountain Laurel / Sophora secundiflora	5
	Yaupon Holly / Ilex vomitoria	23
SHRUBS		
	American Gold Rush Coneflower / Rudbeckia x American Gold Rust	242
	Dwarf Yaupon / Ilex vomitoria 'Nana'	139
	Dwarf Yaupon Holly / Ilex vomitoria 'Nana'	55
	Gulf Coast Pink Muhly Grass / Muhlenbergia capillaris 'Gulf Coast'	248
	Karl Foerster Feather Reed Grass / Calamagrostis x acutiflora 'Karl Foerster'	317
	Mexican Bush Sage / Salvia leucantha	896
	Tuscan Blue Rosemary / Rosmarinus officinalis 'Tuscan Blue'	47
	White Muhly Grass / Muhlenbergia capillaris 'White Cloud'	462
GROUND COVERS		
	Berkeley Sedge / Carex divisa	2,930
	Texas Sedge / Carex texensis	4,826
SOD		
	Bermuda Grass / Cynodon dactylon	25,153 sf

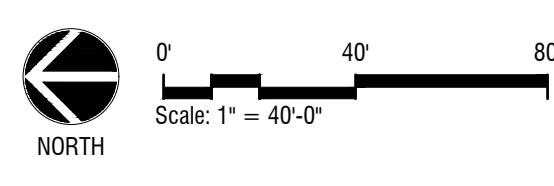
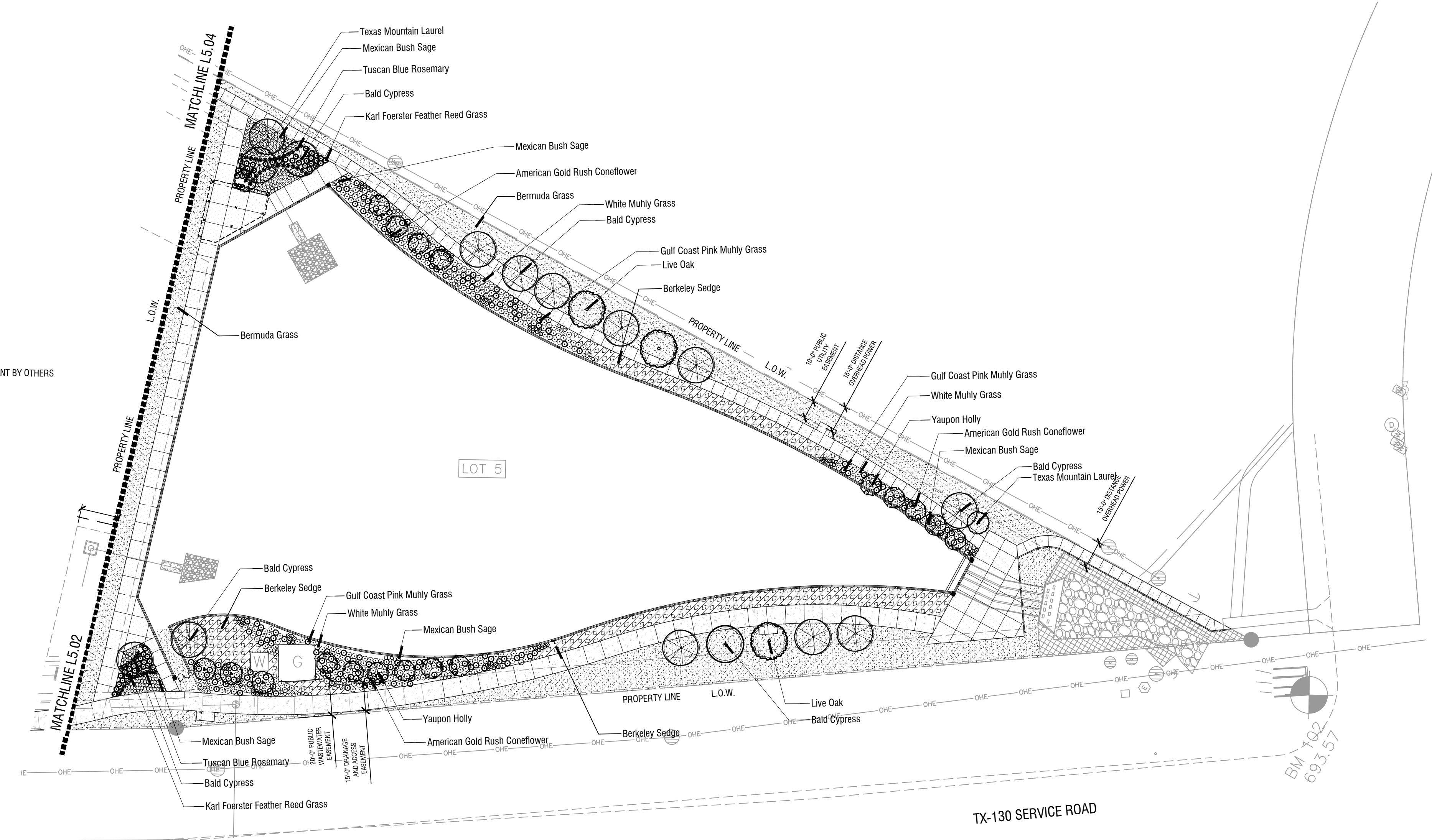

Planting Plan | A
 Scale: 1" = 40'

Date: Oct 04, 2024, 12:20pm User ID: Anne.Harman
 File: R:\WORK\LAUF\Projects\087545010 - Northpointe - Trademark\CAD\Sheets\L5.01 PLANTING PLAN.dwg

THIS DOCUMENT HAS BEEN PRODUCED FROM MATERIAL THAT WAS STORED AND/OR TRANSMITTED ELECTRONICALLY AND MAY HAVE BEEN INADVERTENTLY ALTERED. RELY ONLY ON FINAL HARD COPY MATERIALS BEARING THE CONSULTANT'S ORIGINAL SIGNATURE AND SEAL.