

2021-8843

Discuss and consider action to approve a professional services agreement with Kimley-Horn in the amount of \$349,995.80 for professional engineering services associated with the Pfluger Farm Lane North project and authorizing the City Manger to execute the same.



Pfluger Farm Lane

Project approved
in the 2018 CO
Bond

Coordination with
LC Pflugerville & KH

Kick off Design
January 2021

Deliver
Project



Selected KH
1 of the 7 firms
2019-2021
Transportation
Improvements
Project
April 2019

CC Approved
Developer/City
Agreement with LC
September 2020

Prepare
Final PS&E

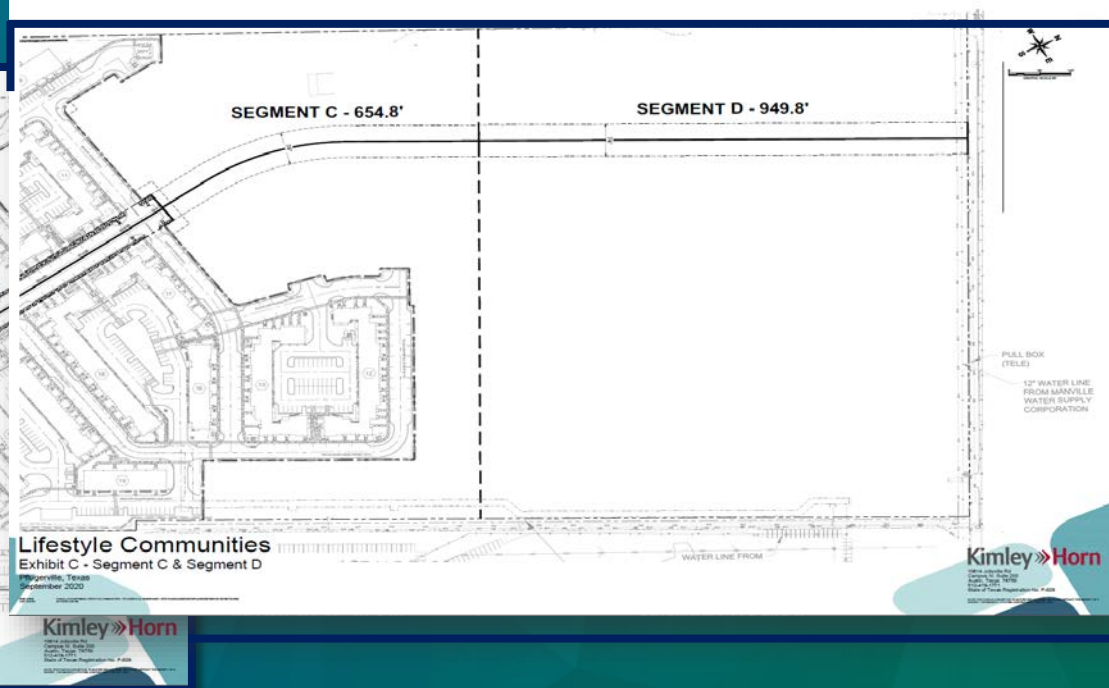
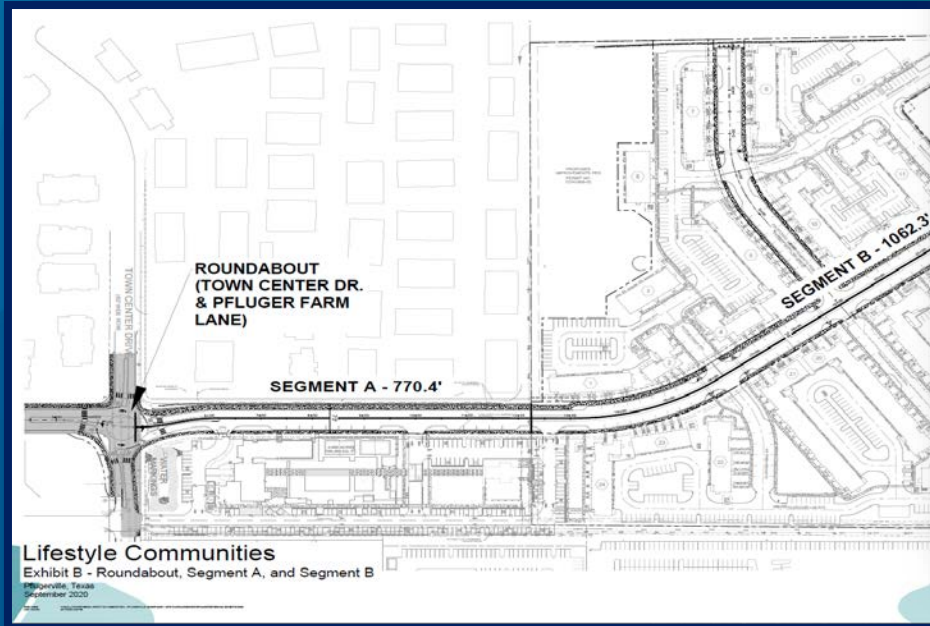

Project Background

Development Agreement Approved:
September 22, 2020

- LC Pflugerville will donate the right of way necessary to construct the road to Wilke Lane (SH45 Frontage Road).
- The agreement also provided that the City will reimburse \$300,000 for the design of Pfluger Farm Ln in Segment A.
- The agreement obligated the City to commence design of the road with approval of the 2020 GO Bond

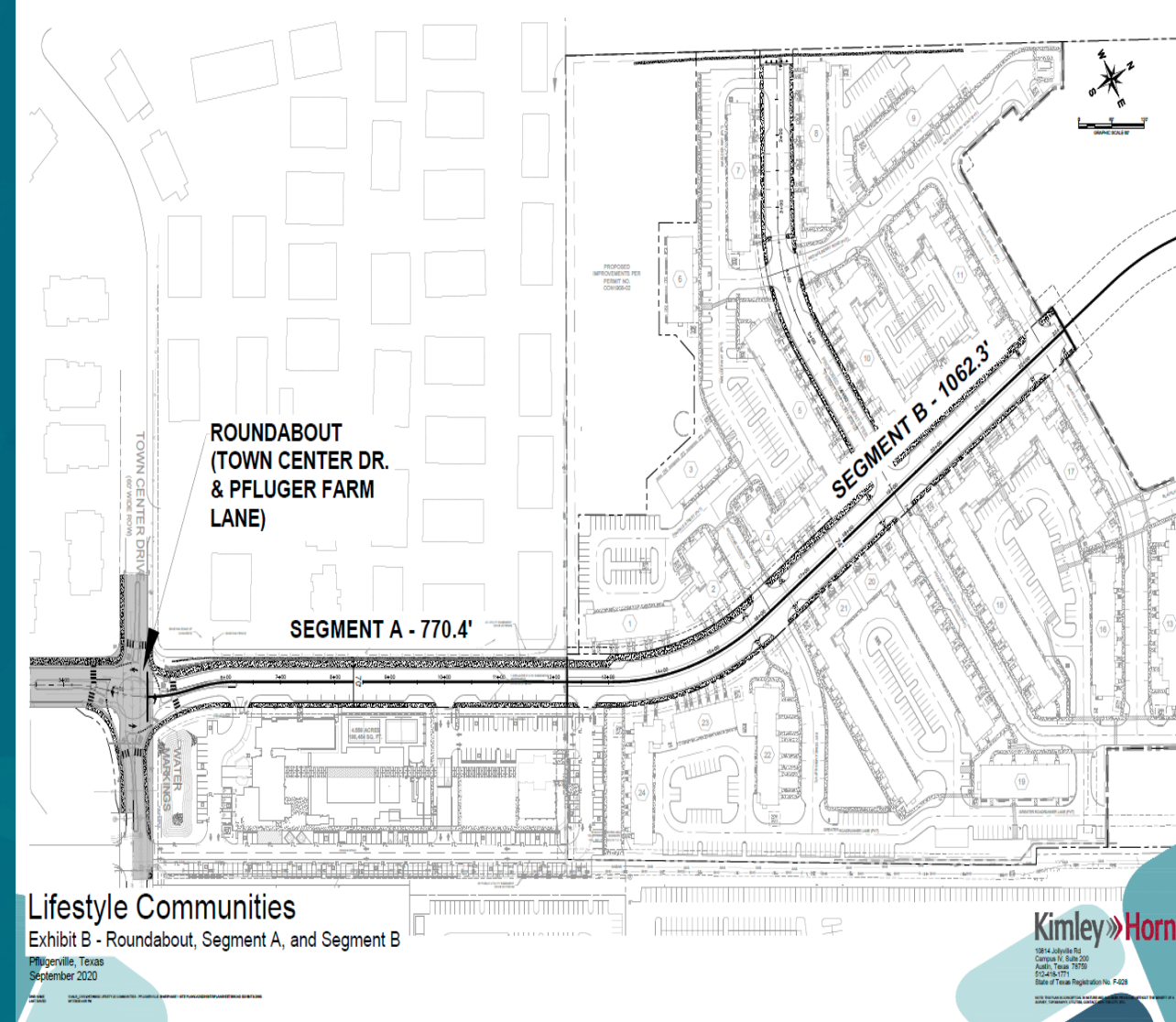

Scope of Services

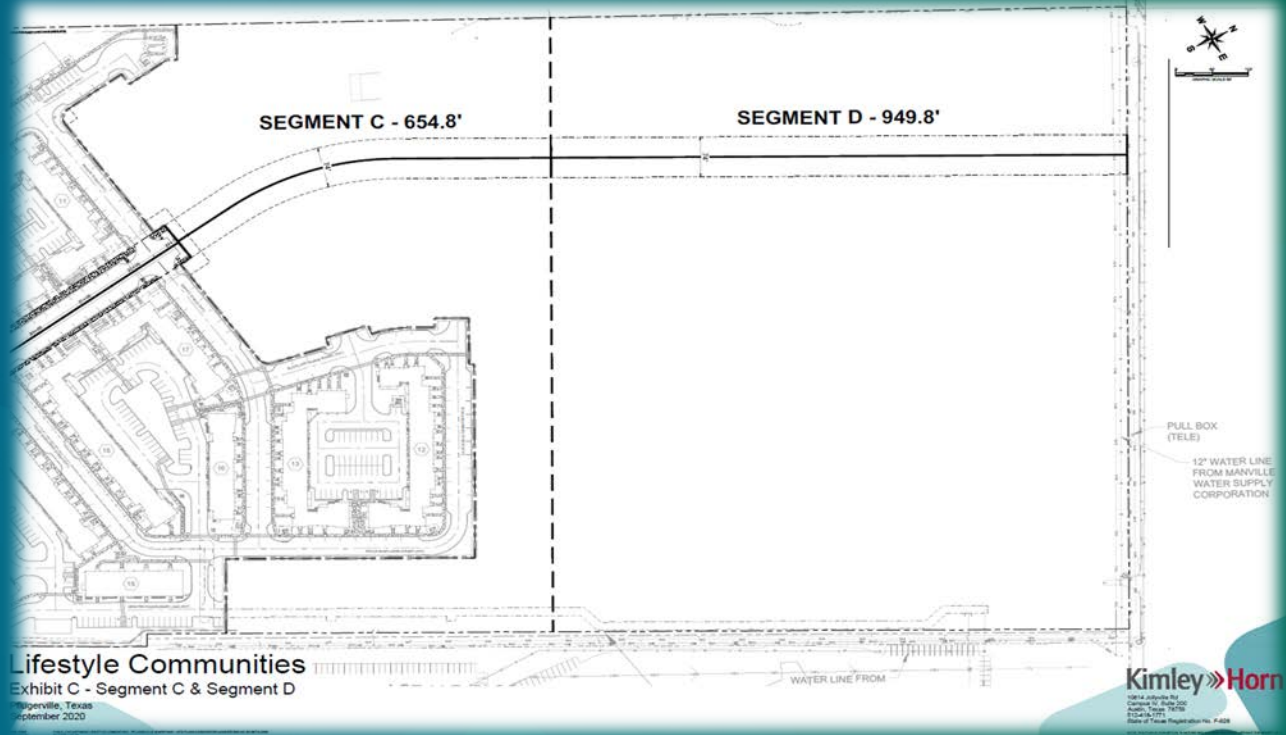
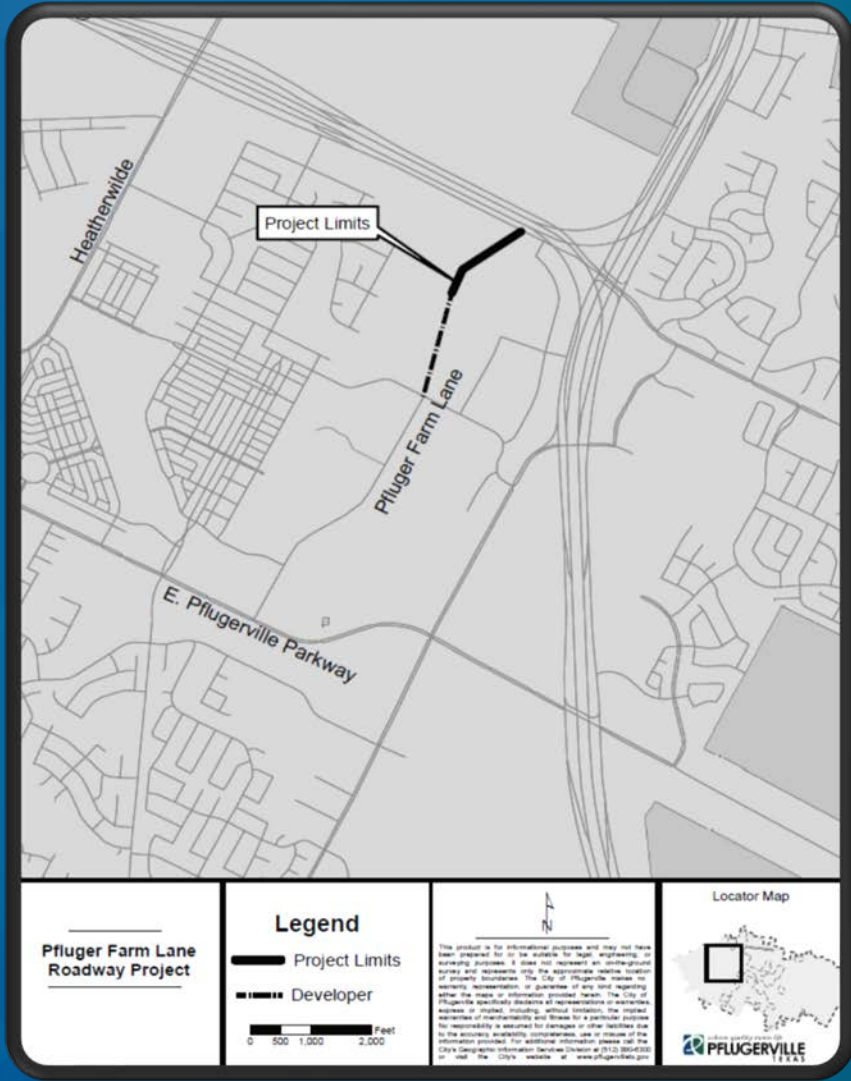

- Project Management
- Survey and ROW Data
- SUE/Utility Coordination
- Environmental Assessment
- TxDOT Coordination
- Final PS&E



Staff Recommendation

Staff requests approving a professional services agreement with Kimley-Horn in the amount of \$349,995.80 for professional engineering services associated with the Pfluger Farm Lane North project and authorizing the City Manager to execute the same.

