

**PROFESSIONAL SERVICES
SUPPLEMENTAL AGREEMENT # 4
FOR
WEISS LANE**

STATE OF TEXAS §
 §
COUNTY OF TRAVIS §

FIRM: LJA Engineering, Inc. ("Consultant")

ADDRESS: 5316 Highway 290 West, Suite 150
 Austin, Texas 78735

This Supplemental Agreement No.4 to a contract for Professional Services is made by and between the City of Pflugerville, Texas, hereinafter called the "City" and LJA Engineering, Inc. , hereinafter called the "Consultant".

WHEREAS, the City and Consultant executed an Agreement for Professional Services, hereinafter called the "Agreement", on the 15th day of July, 2015 for the Weiss Lane project in the amount of \$852,286.95; and a supplemental on the 1st day of February, 2016 in the amount of \$641,296.00 for additional design and PS&E services; and a supplemental on the 12th day of April, 2016 for no additional compensation for additional SUE services; and a supplemental on the 25th day of May, 2016 in the amount of \$112,875.00 for additional design and PS&E services; and

WHEREAS, it has become necessary to amend the Agreement to modify the provisions for the Scope of Services and Compensation;

NOW THEREFORE, premises considered, the City and the Consultant agree that said Agreement is amended as follows:

Article III. Scope of Services and Exhibit A, shall be amended as set forth in the attached addendum to Exhibit A.

Article IV. Compensation to Consultant and Exhibit C (Fee Schedule), shall be amended by by increasing by \$108,541.00 the amount payable under the Agreement for a total of \$1,714,998.95, as shown by the attached Addendum to Exhibit C (Fee Schedule).

EXECUTED and **AGREED** to as of the dates indicated below.

**CITY OF
PFLUGERVILLE**

CONSULTANT

_____	_____
(Signature)	(Signature)
Printed Name: <u>Brandon E. Wade</u>	Printed Name: <u>Jeff P. Collins</u>
Title: <u>City Manager</u>	Title: <u>Executive</u> <u>Vice</u>
	<u>President</u>
Date: _____	Date: _____

APPROVED AS TO FORM:

George Hyde
City Attorney
Denton Navarro Rocha Bernal Hyde & Zech, P.C.

Exhibit A - Scope of Services Supplemental #4**SERVICES TO BE PROVIDED BY THE ENGINEER**

Roadway: Weiss Lane
County: Travis
Limits: **Schematic & PS&E:** from E. Pecan Street to Cele Road

General Supplemental Work Description:

Surveying and development of additional design and PS&E services related to the Wilbarger Creek Bridge design modification and the addition of the Manville 16-inch Waterline Relocation into the Weiss Lane Project.

The Unnamed Tributary to Unnamed Tributary A to Wilbarger Creek Bridge design will be modified to include a dedicated left turn bay for access to Jesse Bohls Drive. Additional PS&E design is required to widen the bridge structure and abutments to accommodate this new design.

In an effort to eliminate conflicts and streamline the design and construction process, approximately 7,850 linear feet of 16-inch Waterline will be relocated as part of the Weiss Lane Project in place of existing parallel conflicting Manville Waterline infrastructure.

The new 16-inch Waterline will begin near the Weiss Lane STA 35+50 and proceed north to a connection to a proposed 16-inch Waterline (by OTHERS) at Pflugerville Parkway near Weiss Lane STA 76+50. The new 16-inch Waterline will pick up at the end of a proposed 16-inch Waterline (by OTHERS) near Weiss Lane STA 125+50 and connect to the existing Manville Water System near Weiss Lane STA 163+00.

Existing meter connections will be relocated to the proposed 16-inch Waterline and the existing Manville Waterlines will be abandoned in place. The project will also include a 2-inch waterline crossing and connection to an existing 2-inch waterline along the east side of Weiss Lane near STA 40+50.

PROJECT MANAGEMENT AND COMMUNICATION PLAN

- ◆ Meetings & Coordination
 - Additional City and Manville WSC Coordination Meetings
 - Additional Sub Coordination Meetings
 - Additional Design Team Meetings

SPECIALTY SERVICES

- ◆ See Attached Scopes (2 separate proposals) for McGray & McGray Land Surveyors, Inc. – Surveying Services
 - Locate Manville WSC waterline points and provide a .dgn file of the collected points.

- Provide a plat and description for 2 proposed public utility easements.
 - Provide 2 plats and descriptions for proposed ROW.
-

BRIDGE DESIGN

Bridge structure shall be designed for HL 93 loading.

Bridge Layout. The Engineer shall:

- ◆ Prepare Bridge Layout plans and elevations for all bridge types listed below in accordance with the latest edition of the State's Load and Resistance Factor Design Bridge Design Manual, Bridge Project Development Manual and Bridge Detailing Manual. Submit the bridge layout to the County for approval before proceeding to structural detail design. Coordinate with the County to determine the location of soil borings needed.

The Bridge layouts in Plan View shall contain the following information:

- Reference line, centerline, or profile grade line (bearing, location, and station).
- Horizontal curve information.
- Right of way (if required).
- Skew angle(s).
- Bearing of centerline.
- Include horizontal and vertical template information of all roadways or railroads crossed.
- Approach slab and curb returns.
- Typical bridge roadway section including preliminary proposed beam types and spacings.
- Slope for header banks and approach fills.
- Control stations at beginning and ending of bridge (with deck elevation).
- Approach pavement and crown width.
- Bridge roadway width and curbs, face of rail, shoulders or sidewalks.
- Limits and type of riprap.
- Proposed features under structure.
- Location of profile grade line.
- North Arrow.
- Cross slope and superelevation data.
- Minimum horizontal distances and vertical clearance points.
- Location of soil borings (station and offset).
- Bent stations and bearings.
- Retaining wall locations, if applicable.
- Traffic flow directional arrows and stream flow direction (if any).
- Railing types shown.
- Joint types and seal size, if used.
- Critical horizontal clearances (location of railroad tracks, nearby structures and utilities).
- Present and projected (20 years) ADT.
- Design speed and functional classification.
- Drawing scale shall be as recommended in the bridge detailing manual.

- Show National Bridge Inventory (NBI) Number.
- Locate bridge drain and bridge lighting bracket stations on plan view, when applicable.

Bridge Layouts in Elevation View should contain the following:

- Type of foundation.
- Finished grade elevations at beginning and end of bridge.
- Overall length of structure.
- Length, type of spans and units.
- Type of railing.
- Minimum calculated vertical clearance(s).
- Existing and proposed ground lines clearly marked.
- Grid elevations and stations.
- Bent numbers encircled.
- Standard Title.
- Profile grade data.
- Type of riprap.
- Fixed/expansion condition of all bents.
- Number, size and length of foundations.
- Drawing scale shall be as recommended in the bridge detailing manual.

Bridge Layouts in Typical Transverse Section should contain the following:

- Widths (overall, roadway, shoulders, sidewalks, etc.).
- Profile grade line and horizontal control line.
- Cross slope.
- Type of railing.
- Beam type and numbers (if required).

The Engineer shall submit a 100% complete bridge layout to the County at the 30% submittal to provide ample review and design time. The Engineer shall not proceed with detailed design until the preliminary bridge layouts are approved by the County.

Structures.

- ◆ The Engineer shall prepare bridge layout, final design calculations, and details for the following structures on Weiss Lane.

Final Design Calculations and Details.

- ◆ The Engineer shall finalize bridge layouts, make final design calculations, and final detail drawings, per structure, in accordance with standard requirements of the County. All bridge design shall be in conformance with the latest edition of the State's LRFD Bridge Design Manual, Bridge Project Development Manual, Bridge Detailing Manual, and AASHTO LRFD Bridge Design Specifications. The Engineer's designer and checker shall both check all calculations and initial. The Engineer shall submit for review all structural design calculations and quantity calculations at the 90% submittal.

Construction Phase Services.

- ◆ The Engineer shall:
 - Review and approve shop drawings.
 - Provide response to Contractor's RFI's.

- Attend Pre-Construction meeting.
- Site visit as needed.

PLANS, SPECIFICATIONS, AND ESTIMATE (PS&E) DEVELOPMENT MANVILLE WATERLINE IMPROVEMENTS

The proposed Weiss Lane improvements necessitate the relocation of Manville Water Supply Corporation waterlines.

WATER SYSTEM IMPROVEMENTS

The existing Manville waterlines will be consolidated into a 16-inch waterline that will be constructed within the ROW and Utility Easements where available. The waterline design will be coordinated with connecting portions of the waterline (by OTHERS).

Services will include:

- PS&E detailing relocation of approximately 7,850 LF of 16-inch waterline between Pecan Street Wilbarger Creek Bridge and Hodde Lane/Cele Road.
- Detail connections to existing Manville WSC water system, proposed 16-inch waterline between Pflugerville Parkway and Aventura Avenue (by OTHERS), and reconnection of existing meters to proposed 16-inch waterline.
- Standards and Specifications

MILESTONE COMMENT RESOLUTION

Services will include:

- Addressing interim Manville WSC review comments;
- Addressing 90% City of Pflugerville and Manville WSC review comments.

NOT INCLUDED IN THIS SCOPE

- ◆ SUE Investigations
- ◆ Material Testing - anticipated to be additional services closer to design completion
- ◆ Waterline Installation Inspection

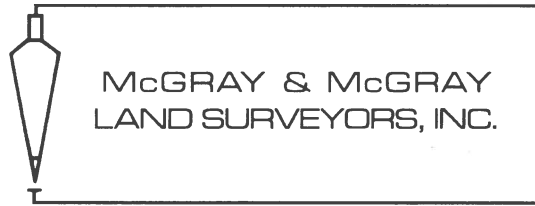

August 11, 2016

Brian Young, P.E.
LJA Engineering, Inc.
5316 Highway 290 West, Ste. 150
Austin, TX 78735
(512) 439-4700

VIA EMAIL
byoung@ljaengineering.com

RE: Second Proposal for Additional Surveying Services for the Weiss Lane Road Improvements Project, City of Pflugerville, Texas

Dear Mr. Young:

We appreciate the opportunity to present you with this second proposal for the above referenced project. The following represents our understanding of the scope of services and our fee proposal follows.

Scope of Services:

Design Survey:

- Locate paintmarks established by Manville Water. Provide a .dgn file of collected points.

Right-of-Way Mapping:

- Provide a plat and description for 1 proposed easement.

Electronic File Requirements:

- A. Survey shall be provided in Microstation (.dgn) and AutoCAD (.dwg) format.
- B. The units of the drawing file shall be U.S. survey feet.
- C. All submittals shall include all of the control points utilized for the project. All control points shall have their own unique point number, northing and easting coordinate, elevation, and point description.

- D. All electronic submittals shall include a text block that states the coordinate system (horizontal and vertical) that the survey is using along with any scale factors used for GPS applications, i.e. surface to grid scale factor.

Fees:

Design Survey (Non-taxable):

RTK Crew:	6 hrs @	\$220.00 /hr.=	\$	1,320.00
GPS Processing:	0.5 hrs @	\$105.00 /hr.=	\$	52.50
Field Coordinator:	0.5 hrs @	\$95.00 /hr.=	\$	47.50
Sr. Tech:	2 hrs @	\$93.00 /hr.=	\$	186.00
Tech:	4 hrs @	\$72.00 /hr.=	\$	288.00
RPLS:	0.5 hrs @	\$140.00 /hr.=	\$	70.00
Project Manager:	2 hrs @	\$160.00 /hr.=	\$	320.00
TOTAL = \$				2,284.00

Right-of-Way Mapping (taxable):

These surveying services will be provided on a parcel basis of \$2,200.00 plus 8.25% sales tax of \$181.50, for a total of **\$2,381.50**.

Summary:

Design Survey Total	\$	2,284.00
Right-of-Way Mapping Total	\$	2,200.00
GRAND TOTAL	\$	4,484.00

Optional Grand Total (with 8.25% sales tax)*

Right-of-Way Mapping Total with \$181.50 sales tax	\$	2,381.50
*GRAND TOTAL	\$	4,665.50

******Since this project includes taxable services, we will need to receive a Texas Sales and Use Tax Resale Certificate for those services prior to starting the project. If one is not available, sales tax will be charged.

We will proceed as soon as we receive notice to proceed. We estimate it will take approximately 1 to 2 weeks (weekends and holidays excluded) from notice to proceed to complete this project, weather and circumstances beyond our control permitting. Please let us know if we need to accelerate this schedule.

Thank you for including us on this project. We look forward to the opportunity to work with you. If you think we have omitted any service you require or misinterpreted your request, please let me or Chris Conrad know.

Sincerely,



Judith J. McGray, RPLS
President
TBPLS Firm #10095500

Authorized to Proceed by:

Signature

Date

Print Name

Title

JJM:CIC:klr

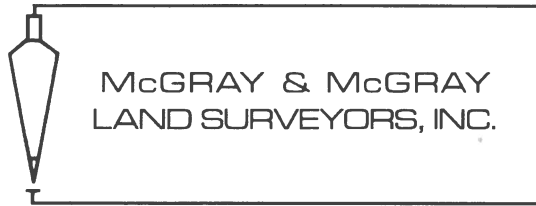

September 13, 2016

Brian Young, P.E.
LJA Engineering, Inc.
5316 Highway 290 West, Ste. 150
Austin, TX 78735
(512) 439-4700

VIA EMAIL
byoung@ljaengineering.com

RE: Revised Third Proposal for Additional Surveying Services for the Weiss Lane Road Improvements Project, City of Pflugerville, Texas

Dear Mr. Young:

We appreciate the opportunity to present you with this revised third proposal for the above referenced project. The following represents our understanding of the scope of services and our fee proposal follows.

Right-of-Way Mapping:

- Provide 2 plats and descriptions for proposed ROW.
- Provide 2 plats and descriptions for proposed public utilities easements.

Fees:

Right-of-Way Mapping (Non-taxable*):

These surveying services will be provided on a parcel basis of \$2,200.00 for a total of **\$8,800.00.**

*(Non-taxable due to the receipt of a Texas Sales and Use Tax Resale Certificate)

We will proceed as soon as we receive notice to proceed. We estimate it will take approximately 1 to 2 weeks (weekends and holidays excluded) from notice to proceed to complete this project, weather and circumstances beyond our control permitting. Please let us know if we need to accelerate this schedule.

Thank you for including us on this project. We look forward to the opportunity to work with you. If you think we have omitted any service you require or misinterpreted your request, please let me or Chris Conrad know.

Sincerely,

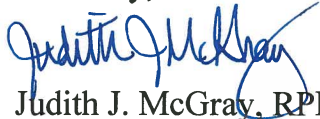

Judith J. McGray, RPLS
President
TBPLS Firm #10095500

Authorized to Proceed by:

Signature

Date

Print Name

Title

JJM:CIC:klr

WEISS LANE - LUMP SUM FEE ESTIMATE

EXHIBIT C
FEE SCHEDULE - Supplemental #4 Design Services for PS&E - LUMP SUM
PROJECT NAME: Weiss Lane
PRIME PROVIDER NAME: LJA Engineering, Inc.

Date: 9/21/2016

WEISS LANE PROJECT													
TASK DESCRIPTION		Senior Project Manager	Senior Engineer/ Planner	Project Engineer	E.I.T.	Senior Engineering Tech	CADD Operator	GIS Analyst/ Cartography	GIS Technician	Admin	Total	Number of Sheets	Hours/Sheet
Project Management													
Additional City/Manville WSC Coordination Meetings (2)		4.0	8.0		4.0						16.0	N/A	N/A
Additional Sub Coordination Meetings			4.0								4.0	N/A	N/A
Additional Design Team Meetings (2)			4.0	4.0	4.0	4.0					16.0	N/A	N/A
HOURS SUB-TOTALS		4.0	16.0	4.0	8.0	4.0	0.0	0.0	0.0	0.0	36.0		
LABOR RATE PER HOUR		\$215	\$175	\$145	\$130	\$110	\$80	\$110	\$95	\$70			
SUBTOTAL		\$860	\$2,800	\$580	\$1,040	\$440	\$0	\$0	\$0	\$0	\$5,720		
TASK DESCRIPTION		Senior Project Manager	Senior Engineer/ Planner	Project Engineer	E.I.T.	Senior Engineering Tech	CADD Operator	GIS Analyst/ Cartography	GIS Technician	Admin	Total	Number of Sheets	Hours/Sheet
Bridge Design													
	Bridge Layout and Typical Sections	1.0	2.0		4.0	4.0					11.0	2.0	5.5
	Estimated Quantities and Bearing Seat Elevations	1.0	2.0		4.0	2.0					9.0	1.0	9.0
	Abutment No. 1	1.0	10.0		20.0	20.0					51.0	3.0	17.0
	Abutment No. 2	1.0	10.0		20.0	20.0					51.0	3.0	17.0
	Girder Layout	1.0	5.0		10.0	16.0					32.0	2.0	16.0
	Slab Plan and Section	1.0	12.0		12.0	20.0					45.0	2.0	22.5
	Prestressed Concret I-Girder Designs	1.0	3.0		8.0	6.0					18.0	1.0	18.0
HOURS SUB-TOTALS		7.0	44.0	0.0	78.0	88.0	0.0	0.0	0.0	0.0	217.0		
LABOR RATE PER HOUR		\$215	\$175	\$145	\$130	\$110	\$80	\$110	\$95	\$70			
SUBTOTAL		\$1,505	\$7,700	\$0	\$10,140	\$9,680	\$0	\$0	\$0	\$0	\$29,025		
TASK DESCRIPTION		Senior Project Manager	Senior Engineer/ Planner	Project Engineer	E.I.T.	Senior Engineering Tech	CADD Operator	GIS Analyst/ Cartography	GIS Technician	Admin	Total	Number of Sheets	Hours/Sheet
Manville WSC Waterline Relocation													
	Plan & Profile		24.0		120.0	180.0					324.0	25.0	13.0
	Detail Connections		8.0		16.0	40.0					64.0	10.0	6.4
	Standards and specs		2.0		16.0	24.0					42.0	3.0	14.0
	Milestone Comment Resolution	2.0	4.0		20.0	40.0							
HOURS SUB-TOTALS		0.0	38.0	0.0	172.0	284.0	0.0	0.0	0.0	0.0	494.0		
LABOR RATE PER HOUR		\$215	\$175	\$145	\$130	\$110	\$80	\$110	\$95	\$70			
SUBTOTAL		\$0	\$6,650	\$0	\$22,360	\$31,240	\$0	\$0	\$0	\$0	\$60,250		

WEISS LANE - LUMP SUM FEE ESTIMATE

[illegible]