

**PROFESSIONAL SERVICES
SUPPLEMENTAL AGREEMENT # 2
FOR
<STREET RECONSTRUCTION PACKAGE 2>**

**STATE OF TEXAS §
 §
COUNTY OF TRAVIS §**

This Supplemental Agreement No. 2 to a contract for Professional Services is made by and between the City of Pflugerville, Texas ("City") and Lockwood, Andrews & Newnam, Inc. ("Consultant"). City and Consultant may be referred to herein singularly as "Party" or collectively as the "Parties."

WHEREAS, the City and Consultant executed an Agreement for Professional Services ("Agreement") on the 26 day of January, 2022 for the Street Reconstruction Package 2 project ("Project") in the amount of \$423,294.00 ; and

WHEREAS, the City and Consultant executed a Supplemental Agreement #1 for Professional Services ("Agreement") on the 26 day of May, 2022 to add the Frost Circle Street segment funded separately (Community Development Block Grant) to the Project in the amount of \$57,176.00 ; and

WHEREAS, the City and Consultant desire to enter into a Supplemental Agreement # 2 for Professional Services for the Project in the amount of \$254,368.00, on the 28 day of June, 2022 to add the engineering services to modify the streets proposed for reconstruction to include W. Pflugerville Loop, Picadilly Drive and Great Basin Avenue Segments 2 and 4 per the recommendations included in the Windshield Study Report to the Agreement; and

WHEREAS, it has become necessary to amend the Agreement to modify the provisions for the Scope of Services, Work Schedule, and Compensation; and

WHEREAS, it is necessary for the City to amend its agreements from time to time to comply with changes in state law relating to contracts of municipalities.

NOW, THEREFORE, premises considered, the City and the Consultant agree that said Agreement is amended as follows:

I.

Article III. Scope of Services and Exhibit A, shall be amended as set forth in the attached addendum to Exhibit A.

Article III. Work Schedule and Exhibit B, shall be amended as set forth in the attached addendum to Exhibit B.

Article IV. Compensation to Consultant and Exhibit C (Fee Schedule), shall be amended by increasing by \$254,368.00 the amount payable under the Agreement for a total of \$734,838.00, as shown by the attached Addendum to Exhibit C (Fee Schedule).

2.

Except as amended hereby and as previously amended as indicated above, the terms of the Agreement shall remain unchanged and in full force and effect.

EXECUTED and **AGREED** to as of the dates indicated below.

**CITY OF
PFLUGERVILLE**

CONSULTANT

<hr/>	
(Signature)	(Signature)
Printed Name: <u>Sereniah Breland</u>	Printed Name: <u>Travis Michel</u>
Title: <u>City Manager</u>	Title: <u>Senior Associate</u>
Date: _____	Date: <u>6/22/22</u>

APPROVED AS TO FORM:



Charles E. Zech
City Attorney
DENTON NAVARRO ROCHA BERNAL & ZECH, P.C.

EXHIBIT A



PLANNING
ENGINEERING
PROGRAM MANAGEMENT

June 16, 2022

TEXAS

AUSTIN
COLLEGE STATION
CONROE
CORPUS CHRISTI
DALLAS
FORT WORTH
FRISCO
HOUSTON
LAREDO
SAN ANTONIO
SAN MARCOS
WACO

CALIFORNIA

LOS ANGELES
ORANGE
SAN JOSE

ILLINOIS

CHICAGO

MICHIGAN

LANSING

City of Pflugerville
Attn: Patricia Davis, PE
City Engineer
P.O. Box 589
Pflugerville, TX 78691

Via email: Michael Lafferty, PE, CFM (Michael.lafferty@freese.com)

RE: Street Reconstruction Projects, Package 2 Windshield Study Report Recommended Improvements – Additional Services #2

The following additional services request is based upon our meeting with the City's GEC on May 5, 2022, and the recommendations included in the Windshield Study Report (WSR). The City agreed to proceed with the recommendations of the referenced report dated April 27, 2022 and identified in WSR Exhibit 8.

The following is LAN's proposed scope of services:

- 1- Modify the streets proposed for reconstruction to those recommended in the WSR as follows: W. Pflugerville Loop; Picadilly Drive; and Great Basin Avenue Segments 2 and 4. All other streets are proposed for mill and overlay with base repairs.
- 2- Perform additional survey and geotechnical analysis of the roadways in Item #1 to prepare survey drawings for design and proposed pavement recommendations.
- 3- Add curb ramps and sidewalks proposed for removal and replacement per WSR.
- 4- Add the limits of Bushmills Road from Bushmills Court to Village Glen Road and the Bushmills Court cul-de-sac as alternates for mill and overlay with base repairs.
- 5- Prepare the additional plans, specifications and estimates for the modified limits described in Item 1 through 4 above.
- 6- Prepare separate bid and construction packages for: a) the mill and overlay with base repair streets, including the limits in #4 as alternates; and b) streets proposed for reconstruction.

LAN proposes to perform these services for the additional amount of \$254,368 as indicated in the attached fee spreadsheet. These additional services will be invoiced monthly on a time & materials basis. Survey and Geotech subconsultant proposals are also attached.

Lockwood, Andrews
& Newnam, Inc.

A LEO A DALY COMPANY

8911 N. Capital of Texas Hwy
Bldg. 2, Suite 2300
Austin, TX 78759
512.338.4212

lan-inc.com

Sincerely,
Lockwood, Andrews & Newnam, Inc.

Steven D. Widacki, PE
Project Manager
SDWidacki@lan-inc.com

Cc: Travis Michel, PE – LAN Project Principal

Attachments

EXHIBIT B STREET RECONSTRUCTION PROJECTS, PACKAGE 2 FEE SPREADSHEET AMENDMENT NO. 2

Table with columns: Task Number, LAN Project No. TBD, Total Task Hours, Project Principal, Quality Manager, Sr. Project Manager/Engineer, Project Engineer, EIT, Sr. CAD/GIS, CAD/GIS, Administrative, Subcontractors, Total Task Cost ADD SVCS. #2, Total Task Cost ORIGINAL AUTHORIZATION. Rows include various service categories like 1.0 - Project Coordination Services, 2.0 - Project Design Criteria, 3.0 - Environmental Services, etc., with subtotals for each.

Attachment 1
EXHIBIT C

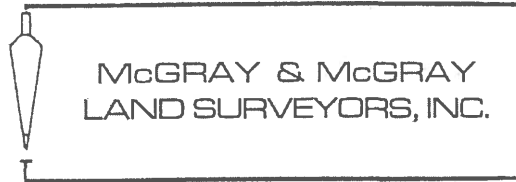

May 11, 2022

Steve Widacki, P.E.
LAN, Inc.
8911 N. Capital of Texas Hwy
Bldg. 2, Suite 2300
Austin, TX 78759
(512) 338-4212

VIA EMAIL:
SDWidacki@lan-inc.com

**RE: Revised Proposal for Topographic Surveying Services for the Pflugerville 2020
Transportation Reconstruction Projects, Pflugerville, Texas**

Dear Mr. Widacki:

We appreciate the opportunity to present you with this revised proposal for the above referenced project. The following represents our understanding of the area to survey and scope of services. Our fee proposal follows.

Areas to Survey:

1. Between the right-of-way lines of the following streets which are highlighted in "Red" on attached Exhibits "A & B".
 - W. Pflugerville Loop (1,635 L.F.)
 - Great Basin Ave. (3,400 L.F.)

Survey Control:

- We will use the City of Pflugerville Monumentation with all data being based on the Texas State Plane, Horizontal data being based on NAD83, and Vertical data based on NAVD88 coordinate system, Central Zone, with all coordinates in Grid. A Grid to Surface Scale factor will be noted.

Scope of Services:

Design Survey:

- A. Elevations shall be obtained at of a maximum of 50-foot intervals, along with break lines as required, to provide a digital topographic design file at 1-foot contour intervals.
- B. Locate and identify all above ground features within the survey limits including buildings, fences, mailboxes, sidewalks, driveways, guardrails, signs, telecom

boxes, visible utilities, utility poles, manholes, water valves with top of nut elevations and water meters.

- C. Identify types of existing pavement surfaces for streets, sidewalks and driveways. Locate and identify existing traffic signals including base, street signs and control boxes.
- D. Trees that are 8-inches, and larger, in diameter shall be located and measured. No identification or tag number will be provided.

Deliverables:

- A. A MicroStation (.dgn) drawing file.
- B. The units of the drawing file shall be U.S. survey feet.
- C. Approximate Boundary lines will not be provided.

Fees:

Design Survey (Non-taxable) – W. Pflugerville Loop (Exhibit “A”):

2 Man Crew:	54 hrs @	\$165.00 /hr.=	\$ 8,910.00
Field Coordinator:	3 hrs @	\$98.00 /hr.=	\$ 294.00
Sr. Tech:	36 hrs @	\$96.00 /hr.=	\$ 3,456.00
Tech:	70 hrs @	\$90.00 /hr.=	\$ 6,300.00
RPLS:	8 hrs @	\$145.00 /hr.=	\$ 1,160.00
Project Manager:	2 hrs @	\$165.00 /hr.=	\$ 330.00
		TOTAL =	\$ 20,450.00

Design Survey (Non-taxable) – Great Basin Ave. (Exhibit “B”):

2 Man Crew:	34 hrs @	\$165.00 /hr.=	\$ 5,610.00
Field Coordinator:	2 hrs @	\$98.00 /hr.=	\$ 196.00
Sr. Tech:	30 hrs @	\$96.00 /hr.=	\$ 2,880.00
Tech:	53 hrs @	\$90.00 /hr.=	\$ 4,770.00
LiDAR Technician:	99 hrs @	\$98.00 /hr.=	\$ 9,702.00
Mobile Mapper:	1 dys @	\$9,000.00 /dy.=	\$ 9,000.00
RPLS:	11 hrs @	\$145.00 /hr.=	\$ 1,595.00
Project Manager:	4 hrs @	\$165.00 /hr.=	\$ 660.00
		TOTAL =	\$ 34,413.00

Summary:

Design Surveying - W. Pflugerville Loop Total \$	20,450.00
Design Surveying - Great Basin Ave. Total \$	34,413.00
GRAND TOTAL \$	54,863.00

Once we receive notice to proceed, we will visit with you to establish a schedule for this project.

Thank you for including us on this project. We look forward to the opportunity to work with you. If you think we have omitted any service you require or misinterpreted your request, please let me or Joe Webber know.

Sincerely,

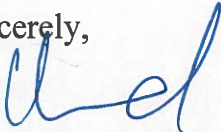

Chris I. Conrad, RPLS
Vice President
TBPELS Survey Firm #10095500

Authorized to Proceed by:

Signature

Date

Print Name

Title

CIC:JDW:pft
Encl.

Google Earth



W. Pflugerville Loop

EXHIBIT "A"

W. Pflugerville Loop
(Approx. 1,635 L.F.)

1000 ft



EXHIBIT "B"

Great Basin Ave.

(Approx. 3,400 L.F.)

Great Basin

Google Earth

1000 ft



Attachment 2 EXHIBIT C



- GEOTECHNICAL ENGINEERING
- CONSTRUCTION MATERIALS
ENGINEERING & TESTING
- SOILS • ASPHALT • CONCRETE

May 12, 2022

LAN

8911 N. Capital of Texas Hwy, Building 2, Suite 2300
Austin, Texas 78759

Attention: Steven D. Widacki, P.E.
SDWidacki@lan-inc.com

**SUBJECT: PROPOSAL - GEOTECHNICAL ENGINEERING SERVICES
PROPOSED PFLUGERVILLE STREET RECONSTRUCTION
PACKAGE 2
PFLUGERVILLE, TEXAS
RET_L Proposal Number: RGP112221AR2**

Dear Mr. Widacki, P.E.;

Introduction

As you requested in emails dated November 22, 2021 and November 23, 2021 and December 28, 2021, and May 11, 2022, Rock Engineering & Testing Laboratory, Inc. (RET_L) is pleased to submit this revised proposal to provide Geotechnical Engineering Services for the proposed Pflugerville Street Reconstruction – Package 2 project located in Pflugerville, Texas. Our services will be performed to determine the subsurface conditions along the roadway alignments and to provide pavement design recommendations for the proposed project.

Project Information

Based on review of the information presented in the referenced emails, RET_L understands that the proposed project will include the full depth reconstruction of the following streets:

- W Pflugerville Loop
 - Approximately 1,653 LF
- Picadilly Drive
 - Approximately 1,800 LF
- Great Basin Avenue
 - Approximately 2,000 LF

The following streets will be mill and overlay projects with spot base repair:

- Yellow Sage Street
 - Approximately 1,170 LF
- Edgemere Drive
 - Approximately 2,230 LF
- Windermere Drive
 - Approximately 3,020 LF

ROCK ENGINEERING & TESTING LABORATORY, INC. (TBPE FIRM NO. 2101)
7 Roundville Lane • Round Rock, Texas, 78664
Office: (512) 284-8022 • Fax: (512) 284-7764 • www.rocktesting.com

The recommendations for the proposed streets will be based on CAPEC Design guidance along with other items in the City's Engineering Design Manual and Construction Standards (Adopted 11/2014).

Scope of Services

RETL's Scope of Services for the subject project will include the following:

Subsurface Investigation - RETL proposes to investigate the subsurface soil and groundwater conditions at the subject site by drilling and sampling test borings utilizing truck-mounted drilling equipment. RETL proposes to perform test borings as shown in the following table:

PROPOSED TEST BORINGS	
Street	Borings
W Pflugerville Loop	4 @ 15
Picadilly Drive	4 @ 15
Great Basin Avenue	4 @ 15

Additionally, RETL proposes to core the existing pavement for the mill and overlay projects and obtain samples of the subgrade soils as shown in the following table:

PROPOSED PAVEMENT CORES	
Street	Cores
Yellow Sage Street	4
Edgemere Drive	6
Windermere Drive	6

The depths noted will be measured from the existing ground surface elevation at the test boring locations. Due to anticipated subsurface lithologies to be encountered at the subject site, RETL will complete the test borings to the depths noted utilizing solid stem auger and air rotary drilling. RETL will coordinate with LAN to locate the test borings at the subject site.

RETL will obtain Right-of-Way permits from the City of Pflugerville prior to drilling. Prior to the commencement of the drilling operations, RETL will contact the Texas 811 System to locate underground utilities within the vicinity of the test boring locations. RETL will coordinate traffic control for test borings requiring partial or full lane closures. During the drilling operations, an RETL representative will be present at the site to coordinate the drilling and sampling activities, as well as prepare field Logs of Boring. Samples will be obtained at 2-foot intervals to 10-feet and at 5-foot intervals thereafter, unless subsurface conditions warrant additional sampling. Groundwater readings will be obtained during drilling and immediately upon completion of the drilling operations. The boreholes will be backfilled with materials generated during the drilling operations.

Laboratory Testing Services - The laboratory-testing program may consist of the following:

- Supplementary visual classification (ASTM D2487)
- Moisture content (ASTM D2216)
- Atterberg limits (ASTM D4318)
- Percent material finer than the #200 sieve (ASTM D1140)
- Unconfined compressive strength (ASTM D2166)
- One-dimensional swell (ASTM D4546)
- pH tests (TEX-128-E)
- Sulfate content (TEX-145-E)
- Moisture Density Relationship (TEX-113-E or TEX-114-E)
- California Bearing Ratio (ASTM D1663)
- Triaxial Compression for Disturbed Soils and Base Materials (TEX-117-E)

The phases of the laboratory-testing program will be performed in general accordance with applicable ASTM or TxDOT Specifications. The results of the laboratory testing will be included on the Logs of Boring or presented in the completed report.

Geotechnical Engineering Services - In addition to the field and laboratory testing, a geotechnical engineering report will be prepared and reviewed by a Professional Engineer licensed in the State of Texas. The geotechnical report will include the following:

- Subsurface and groundwater conditions encountered at the test boring locations
- Subgrade compaction recommendations
- Recommendations for fill materials, placement, and compaction
- Flexible pavement section thickness recommendations in accordance with City of Pflugerville requirements
- General excavation considerations
- Test Boring Location Plan
- Logs of Boring

Fee and Limitations

An estimated cost breakdown for each street is included as an attachment. The total estimated maximum fee is \$67,797.74. The amount billed will be based on the actual quantities of work performed and will not exceed this amount without prior authorization. Our final report can be ready approximately three (3) weeks after the completion of the field work. RETL can consult with the client as field and laboratory test results become available.

Services provided by RETL under this Agreement will be performed in a manner consistent with the degree of care and skill ordinarily exercised by members of the same profession currently practicing under similar circumstances. The Client shall provide for RETL's right to enter the site and that the test boring locations are accessible to truck-mounted drilling equipment and clear of underground utilities in order for RETL to fulfill the Scope of Services included hereunder.

In addition, and notwithstanding any other provisions of this Agreement, the Client agrees, to the fullest extent permitted by law, to indemnify and hold harmless RETL, his or her officers, directors, employees, agents and sub consultants from and against all damage, liability or cost, including reasonable attorneys' fees and defense costs, arising out of or in any way connected with this project or the performance by any of the above named parties of the services under this Agreement, excepting only those damages, liabilities or costs attributable to the sole negligence or willful misconduct of RETL.

The Parties to this agreement agree that if any claim is made that RETL failed to comply with any term of this agreement or that it failed to perform its work and/or duties under this agreement properly, the client, upon proof that there was some failure to comply or some mistake in the performance of the work, shall not be entitled to recover any sum greater than the amount paid by the client to RETL for the service performed by RETL.

Either the Client or RETL may terminate this Agreement at any time with or without cause upon giving the other party 10-calendar days prior written notice. The Client shall within 10-calendar days of termination pay RETL for all services rendered and all costs incurred up to the date of termination, in accordance with the compensation provisions of this contract.

Closing

If you are in agreement with our proposed scope of work and fees, please provide authorization to proceed signing below and returning one copy of this proposal to us. Thank you for your consideration of our firm to assist you with this project. If you have any questions, or comments, please call our office.

Sincerely,



Brian Geiger, P.E.
Geotechnical Project Manager



Arnie K. Hammock, P.E.
Vice President – Round Rock

Attachment: Project Cost Breakdowns

Prime Provider: LAN
Sub Provider: Rock Engineering & Testing
Project: W Pflugerville Loop

TASK DESCRIPTION	PROJECT MANAGER	SENIOR ENGINEER	PROJECT ENGINEER	DESIGN ENGINEER	EIT	SENIOR ENGINEERING TECH	ENGINEERING TECH	SENIOR GEOLOGIST	GEOLOGIST	CADD OPERATOR	ADMIN/CLERICAL	TOTAL LABOR HR AND COST
GEOTECHNICAL STUDIES												
Geotechnical Studies and Investigations		2	10				25					37
HOURS SUB-TOTALS	0	2	10	0	0	0	25	0	0	0	0	37
HOURLY CONTRACT RATE		\$185.64	\$147.33				\$65.00					
TOTAL LABOR COSTS	\$0.00	\$371.28	\$1,473.30	\$0.00	\$0.00	\$0.00	\$1,625.00	\$0.00	\$0.00	\$0.00	\$0.00	\$3,469.58

SUBTOTAL	\$3,469.58
-----------------	-------------------

TASK DESCRIPTION	PROJECT MANAGER	SENIOR ENGINEER	PROJECT ENGINEER	DESIGN ENGINEER	EIT	SENIOR ENGINEERING TECH	ENGINEERING TECH	SENIOR GEOLOGIST	GEOLOGIST	CADD OPERATOR	ADMIN/CLERICAL	TOTAL LABOR HR AND COST
GENERAL PROJECT MANAGEMENT												
a. General Management		2	2									4
b. Project Coordination Meetings		2	8									10
c. Quality Assurance/Quality Control		2	2									4
HOURS SUB-TOTALS	0	6	12	0	0	0	0	0	0	0	0	18
HOURLY CONTRACT RATE		\$185.64	\$147.33									
TOTAL LABOR COSTS	\$0.00	\$1,113.84	\$1,767.96	\$0.00	\$0.00	\$0.00	\$0.00	\$0.00	\$0.00	\$0.00	\$0.00	\$2,881.80

SUBTOTAL	\$2,881.80
-----------------	-------------------

OTHER DIRECT EXPENSES	QTY	UNIT	RATE	COST
Soil Boring (< 60 ft.)	60	LF	\$25.25	\$1,515.00
Core/drill operator/technician and coring equipment used to drill flexible and rigid pavement (2-man crew)	1	Trip	\$400.00	\$400.00
(a) 4-in. diameter cores	32	Inch	\$7.25	\$232.00
Construction Truck (Includes operation, and maintenance costs; Insurance costs will not be reimbursed)	1	day	\$80.00	\$80.00
Street Cut Permit	1	each	\$200.00	\$200.00
Traffic Control Services, Arrow Boards and Attenuator trucks - Large Project (Includes labor, equipment and fuel)	1	day	\$1,950.00	\$1,950.00
Lodging/Hotel - Taxes and Fees	0	day	\$30.00	\$0.00
Lodging/Hotel (Taxes/fees not included)	0	day	\$102.00	\$0.00
Meals	0	day	\$56.00	\$0.00
Mileage	0	mile	\$4.85	\$0.00
Moisture Content	24	each	\$15.00	\$360.00
Atterberg Limits	8	each	\$90.00	\$720.00
Minus No 200 Sieve	8	each	\$45.25	\$362.00
Sieve Analysis	0	each	\$89.90	\$0.00
CBR	1	each	\$425.00	\$425.00
Sulfate Content	4	each	\$50.00	\$200.00
Lime Series	1	each	\$242.00	\$242.00
Unconfined Compressive Strength (Soil)	4	each	\$80.00	\$320.00
Texas Triaxial (Subgrade Soil)	1	each	\$2,500.00	\$2,500.00
One Dimensional Swell, Method C	2	each	\$300.00	\$600.00
SUBTOTAL DIRECT EXPENSES				\$10,106.00

SUBTOTAL	\$10,106.00
-----------------	--------------------

SUMMARY COSTS - FUNCTION CODES	
GEOTECHNICAL STUDIES	\$3,469.58
GENERAL PROJECT MANAGEMENT	\$2,881.80
OTHER DIRECT EXPENSES	\$10,106.00
TOTALS	\$16,457.38

Prime Provider: LAN
 Sub Provider: Rock Engineering & Testing
 Project: Picadilly

TASK DESCRIPTION	PROJECT MANAGER	SENIOR ENGINEER	PROJECT ENGINEER	DESIGN ENGINEER	EIT	SENIOR ENGINEERING TECH	ENGINEERING TECH	SENIOR GEOLOGIST	GEOLOGIST	CADD OPERATOR	ADMIN/CLERICAL	TOTAL LABOR HR AND COST
GEOTECHNICAL STUDIES												
Geotechnical Studies and Investigations		2	10				25					37
HOURS SUB-TOTALS	0	2	10	0	0	0	25	0	0	0	0	37
HOURLY CONTRACT RATE		\$185.64	\$147.33				\$65.00					
TOTAL LABOR COSTS	\$0.00	\$371.28	\$1,473.30	\$0.00	\$0.00	\$0.00	\$1,625.00	\$0.00	\$0.00	\$0.00	\$0.00	\$3,469.58

SUBTOTAL	\$3,469.58
-----------------	-------------------

TASK DESCRIPTION	PROJECT MANAGER	SENIOR ENGINEER	PROJECT ENGINEER	DESIGN ENGINEER	EIT	SENIOR ENGINEERING TECH	ENGINEERING TECH	SENIOR GEOLOGIST	GEOLOGIST	CADD OPERATOR	ADMIN/CLERICAL	TOTAL LABOR HR AND COST
GENERAL PROJECT MANAGEMENT												
a. General Management		2	2									4
b. Project Coordination Meetings		2	8									10
c. Quality Assurance/Quality Control		2	2									4
HOURS SUB-TOTALS	0	6	12	0	0	0	0	0	0	0	0	18
HOURLY CONTRACT RATE		\$185.64	\$147.33									
TOTAL LABOR COSTS	\$0.00	\$1,113.84	\$1,767.96	\$0.00	\$0.00	\$0.00	\$0.00	\$0.00	\$0.00	\$0.00	\$0.00	\$2,881.80

SUBTOTAL	\$2,881.80
-----------------	-------------------

OTHER DIRECT EXPENSES	QTY	UNIT	RATE	COST
Soil Boring (< 60 ft.)	60	LF	\$25.25	\$1,515.00
Core/drill operator/technician and coring equipment used to drill flexible and rigid pavement (2-man crew)	1	Trip	\$400.00	\$400.00
(a) 4-in. diameter cores	32	Inch	\$7.25	\$232.00
Construction Truck (Includes operation, and maintenance costs; Insurance costs will not be reimbursed)	1	day	\$80.00	\$80.00
Street Cut Permit	1	each	\$200.00	\$200.00
Traffic Control Services, Arrow Boards and Attenuator trucks - Large Project (Includes labor, equipment and fuel)	1	day	\$1,950.00	\$1,950.00
Lodging/Hotel - Taxes and Fees	0	day	\$30.00	\$0.00
Lodging/Hotel (Taxes/fees not included)	0	day	\$102.00	\$0.00
Meals	0	day	\$56.00	\$0.00
Mileage	0	mile	\$4.85	\$0.00
Moisture Content	24	each	\$15.00	\$360.00
Atterberg Limits	8	each	\$90.00	\$720.00
Minus No 200 Sieve	8	each	\$45.25	\$362.00
Sieve Analysis	0	each	\$89.90	\$0.00
CBR	1	each	\$425.00	\$425.00
Sulfate Content	4	each	\$50.00	\$200.00
Lime Series	1	each	\$242.00	\$242.00
Unconfined Compressive Strength (Soil)	4	each	\$80.00	\$320.00
Texas Triaxial (Subgrade Soil)	1	each	\$2,500.00	\$2,500.00
One Dimensional Swell, Method C	2	each	\$300.00	\$600.00
SUBTOTAL DIRECT EXPENSES				\$10,106.00

SUBTOTAL	\$10,106.00
-----------------	--------------------

SUMMARY COSTS - FUNCTION CODES	
GEOTECHNICAL STUDIES	\$3,469.58
GENERAL PROJECT MANAGEMENT	\$2,881.80
OTHER DIRECT EXPENSES	\$10,106.00
TOTALS	\$16,457.38

Prime Provider: LAN
 Sub Provider: Rock Engineering & Testing
 Project: Great Basin

TASK DESCRIPTION	PROJECT MANAGER	SENIOR ENGINEER	PROJECT ENGINEER	DESIGN ENGINEER	EIT	SENIOR ENGINEERING TECH	ENGINEERING TECH	SENIOR GEOLOGIST	GEOLOGIST	CADD OPERATOR	ADMIN/CLERICAL	TOTAL LABOR HR AND COST
GEOTECHNICAL STUDIES												
Geotechnical Studies and Investigations		2	10				25					37
HOURS SUB-TOTALS	0	2	10	0	0	0	25	0	0	0	0	37
HOURLY CONTRACT RATE		\$185.64	\$147.33				\$65.00					
TOTAL LABOR COSTS	\$0.00	\$371.28	\$1,473.30	\$0.00	\$0.00	\$0.00	\$1,625.00	\$0.00	\$0.00	\$0.00	\$0.00	\$3,469.58

SUBTOTAL	\$3,469.58
-----------------	-------------------

TASK DESCRIPTION	PROJECT MANAGER	SENIOR ENGINEER	PROJECT ENGINEER	DESIGN ENGINEER	EIT	SENIOR ENGINEERING TECH	ENGINEERING TECH	SENIOR GEOLOGIST	GEOLOGIST	CADD OPERATOR	ADMIN/CLERICAL	TOTAL LABOR HR AND COST
GENERAL PROJECT MANAGEMENT												
a. General Management		2	2									4
b. Project Coordination Meetings		2	8									10
c. Quality Assurance/Quality Control		2	2									4
HOURS SUB-TOTALS	0	6	12	0	0	0	0	0	0	0	0	18
HOURLY CONTRACT RATE		\$185.64	\$147.33									
TOTAL LABOR COSTS	\$0.00	\$1,113.84	\$1,767.96	\$0.00	\$0.00	\$0.00	\$0.00	\$0.00	\$0.00	\$0.00	\$0.00	\$2,881.80

SUBTOTAL	\$2,881.80
-----------------	-------------------

OTHER DIRECT EXPENSES	QTY	UNIT	RATE	COST
Soil Boring (< 60 ft.)	60	LF	\$25.25	\$1,515.00
Core/drill operator/technician and coring equipment used to drill flexible and rigid pavement (2-man crew)	1	Trip	\$400.00	\$400.00
(a) 4-in. diameter cores	32	Inch	\$7.25	\$232.00
Construction Truck (Includes operation, and maintenance costs; Insurance costs will not be reimbursed)	1	day	\$80.00	\$80.00
Street Cut Permit	1	each	\$200.00	\$200.00
Traffic Control Services, Arrow Boards and Attenuator trucks - Large Project (Includes labor, equipment and fuel)	1	day	\$1,950.00	\$1,950.00
Lodging/Hotel - Taxes and Fees	0	day	\$30.00	\$0.00
Lodging/Hotel (Taxes/fees not included)	0	day	\$102.00	\$0.00
Meals	0	day	\$56.00	\$0.00
Mileage	0	mile	\$4.85	\$0.00
Moisture Content	24	each	\$15.00	\$360.00
Atterberg Limits	8	each	\$90.00	\$720.00
Minus No 200 Sieve	8	each	\$45.25	\$362.00
Sieve Analysis	0	each	\$89.90	\$0.00
CBR	1	each	\$425.00	\$425.00
Sulfate Content	4	each	\$50.00	\$200.00
Lime Series	1	each	\$242.00	\$242.00
Unconfined Compressive Strength (Soil)	4	each	\$80.00	\$320.00
Texas Triaxial (Subgrade Soil)	1	each	\$2,500.00	\$2,500.00
One Dimensional Swell, Method C	2	each	\$300.00	\$600.00
SUBTOTAL DIRECT EXPENSES				\$10,106.00

SUBTOTAL	\$10,106.00
-----------------	--------------------

SUMMARY COSTS - FUNCTION CODES	
GEOTECHNICAL STUDIES	\$3,469.58
GENERAL PROJECT MANAGEMENT	\$2,881.80
OTHER DIRECT EXPENSES	\$10,106.00
TOTALS	\$16,457.38

Prime Provider: LAN
Sub Provider: Rock Engineering & Testing
Project: Yellow Sage Street

TASK DESCRIPTION	PROJECT MANAGER	SENIOR ENGINEER	PROJECT ENGINEER	DESIGN ENGINEER	EIT	SENIOR ENGINEERING TECH	ENGINEERING TECH	SENIOR GEOLOGIST	GEOLOGIST	CADD OPERATOR	ADMIN/CLERICAL	TOTAL LABOR HR AND COST
GEOTECHNICAL STUDIES												
Geotechnical Studies and Investigations		1	4				4					9
HOURS SUB-TOTALS	0	1	4	0	0	0	4	0	0	0	0	9
HOURLY CONTRACT RATE		\$185.64	\$147.33				\$65.00					
TOTAL LABOR COSTS	\$0.00	\$185.64	\$589.32	\$0.00	\$0.00	\$0.00	\$260.00	\$0.00	\$0.00	\$0.00	\$0.00	\$1,034.96

SUBTOTAL	\$1,034.96
-----------------	-------------------

TASK DESCRIPTION	PROJECT MANAGER	SENIOR ENGINEER	PROJECT ENGINEER	DESIGN ENGINEER	EIT	SENIOR ENGINEERING TECH	ENGINEERING TECH	SENIOR GEOLOGIST	GEOLOGIST	CADD OPERATOR	ADMIN/CLERICAL	TOTAL LABOR HR AND COST
GENERAL PROJECT MANAGEMENT												
a. General Management		1	1									2
b. Project Coordination Meetings		1	2									3
c. Quality Assurance/Quality Control		1	1									2
HOURS SUB-TOTALS	0	3	4	0	0	0	0	0	0	0	0	7
HOURLY CONTRACT RATE		\$185.64	\$147.33									
TOTAL LABOR COSTS	\$0.00	\$556.92	\$589.32	\$0.00	\$0.00	\$0.00	\$0.00	\$0.00	\$0.00	\$0.00	\$0.00	\$1,146.24

SUBTOTAL	\$1,146.24
-----------------	-------------------

OTHER DIRECT EXPENSES	QTY	UNIT	RATE	COST
Soil Boring (< 60 ft.)	0	LF	\$25.25	\$0.00
Core/drill operator/technician and coring equipment used to drill flexible and rigid pavement (2-man crew)	1	Trip	\$400.00	\$400.00
(a) 4-in. diameter cores	32	Inch	\$7.25	\$232.00
Construction Truck (Includes operation, and maintenance costs; Insurance costs will not be reimbursed)	1	day	\$80.00	\$80.00
Street Cut Permit	1	each	\$200.00	\$200.00
Traffic Control Services, Arrow Boards and Attenuator trucks - Large Project (Includes labor, equipment and fuel)	1	day	\$1,950.00	\$1,950.00
Lodging/Hotel - Taxes and Fees	0	day	\$30.00	\$0.00
Lodging/Hotel (Taxes/fees not included)	0	day	\$102.00	\$0.00
Meals	0	day	\$56.00	\$0.00
Mileage	0	mile	\$4.85	\$0.00
Moisture Content	4	each	\$15.00	\$60.00
Atterberg Limits	4	each	\$90.00	\$360.00
Minus No 200 Sieve	4	each	\$45.25	\$181.00
Sieve Analysis	0	each	\$89.90	\$0.00
CBR	0	each	\$425.00	\$0.00
Sulfate Content	0	each	\$50.00	\$0.00
pH Test	4	each	\$25.00	\$100.00
Unconfined Compressive Strength (Soil)	0	each	\$80.00	\$0.00
Texas Triaxial (Subgrade Soil)	0	each	\$2,500.00	\$0.00
One Dimensional Swell, Method C	0	each	\$300.00	\$0.00
SUBTOTAL DIRECT EXPENSES				\$3,563.00

SUBTOTAL	\$3,563.00
-----------------	-------------------

SUMMARY COSTS - FUNCTION CODES	
GEOTECHNICAL STUDIES	\$1,034.96
GENERAL PROJECT MANAGEMENT	\$1,146.24
OTHER DIRECT EXPENSES	\$3,563.00
TOTALS	\$5,744.20

Prime Provider: LAN
 Sub Provider: Rock Engineering & Testing
 Project: Edgemere Drive

TASK DESCRIPTION	PROJECT MANAGER	SENIOR ENGINEER	PROJECT ENGINEER	DESIGN ENGINEER	EIT	SENIOR ENGINEERING TECH	ENGINEERING TECH	SENIOR GEOLOGIST	GEOLOGIST	CADD OPERATOR	ADMIN/CLERICAL	TOTAL LABOR HR AND COST
GEOTECHNICAL STUDIES												
Geotechnical Studies and Investigations		1	4				6					11
HOURS SUB-TOTALS	0	1	4	0	0	0	6	0	0	0	0	11
HOURLY CONTRACT RATE		\$185.64	\$147.33				\$65.00					
TOTAL LABOR COSTS	\$0.00	\$185.64	\$589.32	\$0.00	\$0.00	\$0.00	\$390.00	\$0.00	\$0.00	\$0.00	\$0.00	\$1,164.96

SUBTOTAL \$1,164.96

TASK DESCRIPTION	PROJECT MANAGER	SENIOR ENGINEER	PROJECT ENGINEER	DESIGN ENGINEER	EIT	SENIOR ENGINEERING TECH	ENGINEERING TECH	SENIOR GEOLOGIST	GEOLOGIST	CADD OPERATOR	ADMIN/CLERICAL	TOTAL LABOR HR AND COST
GENERAL PROJECT MANAGEMENT												
a. General Management		1	1									2
b. Project Coordination Meetings		1	2									3
c. Quality Assurance/Quality Control		1	1									2
HOURS SUB-TOTALS	0	3	4	0	0	0	0	0	0	0	0	7
HOURLY CONTRACT RATE		\$185.64	\$147.33									
TOTAL LABOR COSTS	\$0.00	\$556.92	\$589.32	\$0.00	\$0.00	\$0.00	\$0.00	\$0.00	\$0.00	\$0.00	\$0.00	\$1,146.24

SUBTOTAL \$1,146.24

OTHER DIRECT EXPENSES	QTY	UNIT	RATE	COST
Soil Boring (< 60 ft.)	0	LF	\$25.25	\$0.00
Core/drill operator/technician and coring equipment used to drill flexible and rigid pavement (2-man crew)	1	Trip	\$400.00	\$400.00
(a) 4-in. diameter cores	48	Inch	\$7.25	\$348.00
Construction Truck (Includes operation, and maintenance costs; Insurance costs will not be reimbursed)	1	day	\$80.00	\$80.00
Street Cut Permit	1	each	\$200.00	\$200.00
Traffic Control Services, Arrow Boards and Attenuator trucks - Large Project (Includes labor, equipment and fuel)	1	day	\$1,950.00	\$1,950.00
Lodging/Hotel - Taxes and Fees	0	day	\$30.00	\$0.00
Lodging/Hotel (Taxes/fees not included)	0	day	\$102.00	\$0.00
Meals	0	day	\$56.00	\$0.00
Mileage	0	mile	\$4.85	\$0.00
Moisture Content	6	each	\$15.00	\$90.00
Atterberg Limits	6	each	\$90.00	\$540.00
Minus No 200 Sieve	6	each	\$45.25	\$271.50
Sieve Analysis	0	each	\$89.90	\$0.00
CBR	0	each	\$425.00	\$0.00
Sulfate Content	0	each	\$50.00	\$0.00
pH Test	6	each	\$25.00	\$150.00
Unconfined Compressive Strength (Soil)	0	each	\$80.00	\$0.00
Texas Triaxial (Subgrade Soil)	0	each	\$2,500.00	\$0.00
One Dimensional Swell, Method C	0	each	\$300.00	\$0.00
SUBTOTAL DIRECT EXPENSES				\$4,029.50

SUBTOTAL \$4,029.50

SUMMARY COSTS - FUNCTION CODES	
GEOTECHNICAL STUDIES	\$1,164.96
GENERAL PROJECT MANAGEMENT	\$1,146.24
OTHER DIRECT EXPENSES	\$4,029.50
TOTALS	\$6,340.70

Prime Provider: LAN
 Sub Provider: Rock Engineering & Testing
 Project: Windermere Drive

TASK DESCRIPTION	PROJECT MANAGER	SENIOR ENGINEER	PROJECT ENGINEER	DESIGN ENGINEER	EIT	SENIOR ENGINEERING TECH	ENGINEERING TECH	SENIOR GEOLOGIST	GEOLOGIST	CADD OPERATOR	ADMIN/CLERICAL	TOTAL LABOR HR AND COST
GEOTECHNICAL STUDIES												
Geotechnical Studies and Investigations		1	4				6					11
HOURS SUB-TOTALS	0	1	4	0	0	0	6	0	0	0	0	11
HOURLY CONTRACT RATE		\$185.64	\$147.33				\$65.00					
TOTAL LABOR COSTS	\$0.00	\$185.64	\$589.32	\$0.00	\$0.00	\$0.00	\$390.00	\$0.00	\$0.00	\$0.00	\$0.00	\$1,164.96

SUBTOTAL	\$1,164.96
-----------------	-------------------

TASK DESCRIPTION	PROJECT MANAGER	SENIOR ENGINEER	PROJECT ENGINEER	DESIGN ENGINEER	EIT	SENIOR ENGINEERING TECH	ENGINEERING TECH	SENIOR GEOLOGIST	GEOLOGIST	CADD OPERATOR	ADMIN/CLERICAL	TOTAL LABOR HR AND COST
GENERAL PROJECT MANAGEMENT												
a. General Management		1	1									2
b. Project Coordination Meetings		1	2									3
c. Quality Assurance/Quality Control		1	1									2
HOURS SUB-TOTALS	0	3	4	0	0	0	0	0	0	0	0	7
HOURLY CONTRACT RATE		\$185.64	\$147.33									
TOTAL LABOR COSTS	\$0.00	\$556.92	\$589.32	\$0.00	\$0.00	\$0.00	\$0.00	\$0.00	\$0.00	\$0.00	\$0.00	\$1,146.24

SUBTOTAL	\$1,146.24
-----------------	-------------------

OTHER DIRECT EXPENSES	QTY	UNIT	RATE	COST
Soil Boring (< 60 ft.)	0	LF	\$25.25	\$0.00
Core/drill operator/technician and coring equipment used to drill flexible and rigid pavement (2-man crew)	1	Trip	\$400.00	\$400.00
(a) 4-in. diameter cores	48	Inch	\$7.25	\$348.00
Construction Truck (Includes operation, and maintenance costs; Insurance costs will not be reimbursed)	1	day	\$80.00	\$80.00
Street Cut Permit	1	each	\$200.00	\$200.00
Traffic Control Services, Arrow Boards and Attenuator trucks - Large Project (Includes labor, equipment and fuel)	1	day	\$1,950.00	\$1,950.00
Lodging/Hotel - Taxes and Fees	0	day	\$30.00	\$0.00
Lodging/Hotel (Taxes/fees not included)	0	day	\$102.00	\$0.00
Meals	0	day	\$56.00	\$0.00
Mileage	0	mile	\$4.85	\$0.00
Moisture Content	6	each	\$15.00	\$90.00
Atterberg Limits	6	each	\$90.00	\$540.00
Minus No 200 Sieve	6	each	\$45.25	\$271.50
Sieve Analysis	0	each	\$89.90	\$0.00
CBR	0	each	\$425.00	\$0.00
Sulfate Content	0	each	\$50.00	\$0.00
pH Test	6	each	\$25.00	\$150.00
Unconfined Compressive Strength (Soil)	0	each	\$80.00	\$0.00
Texas Triaxial (Subgrade Soil)	0	each	\$2,500.00	\$0.00
One Dimensional Swell, Method C	0	each	\$300.00	\$0.00
SUBTOTAL DIRECT EXPENSES				\$4,029.50

SUBTOTAL	\$4,029.50
-----------------	-------------------

SUMMARY COSTS - FUNCTION CODES	
GEOTECHNICAL STUDIES	\$1,164.96
GENERAL PROJECT MANAGEMENT	\$1,146.24
OTHER DIRECT EXPENSES	\$4,029.50
TOTALS	\$6,340.70

ID	% Complete	Task Name	Duration	Start	Finish	Predecessors
1	100%	Windshield Study/Preliminary Assessment	4 wks	Mon 2/21/22	Fri 3/18/22	
2	100%	Update Schedule with Utility Relocations Estimate	1 wk	Mon 3/14/22	Fri 3/18/22	
3	100%	Preliminary Assessment submittal	2 days	Mon 3/21/22	Tue 3/22/22	1
4	100%	Prelim Assess - City Rvw.	3 wks	Wed 3/23/22	Tue 4/12/22	3
5	100%	Address City Cmts to WS	2.4 wks	Tue 4/12/22	Wed 4/27/22	4
6	100%	Resubmit WSR to City	1 day	Thu 4/28/22	Thu 4/28/22	5
7	100%	City rvw. WSR Rsbmt.	0.6 wks	Fri 4/29/22	Tue 5/3/22	6
8	100%	Mtg w/ City for Amend #2 per WSR	0.2 wks	Wed 5/4/22	Wed 5/4/22	7
9	100%	Prep Amend #2	1.4 wks	Thu 5/5/22	Fri 5/13/22	8
10	0%	Council Action Amend #2	0.2 wks	Tue 5/24/22	Tue 5/24/22	9FS+6 days
11	0%	Public Involvement 1-1	3 wks	Wed 6/22/22	Tue 7/12/22	10FS+20 days
12	0%	Public Involvement 1-2	3 wks	Wed 6/22/22	Tue 7/12/22	10FS+20 days
13	0%	Geotechnical Services	8 wks	Wed 5/25/22	Tue 7/19/22	10
14	0%	Survey	8 wks	Wed 5/25/22	Tue 7/19/22	10
15	0%	Utility Coordination	21 wks	Wed 5/25/22	Tue 10/18/22	10
16	0%	60% Design/PS&E	21 wks	Wed 5/25/22	Tue 10/18/22	10
17	0%	60% Design/PSE Submitt	1 day	Wed 10/19/22	Wed 10/19/22	16,13,14
18	0%	60% Review by City	2 wks	Thu 10/20/22	Wed 11/2/22	17
19	0%	Coordination with TxDOT & County	8 wks	Wed 9/14/22	Tue 11/8/22	16SS+80 days
20	0%	Update Schedule with Utility Relocations Estimate	1 wk	Wed 10/19/22	Tue 10/25/22	15
21	0%	90% Design/PS&E	12 wks	Wed 10/26/22	Tue 1/17/23	15,17,20
22	0%	90% Design/PSE Submitt	1 day	Wed 1/18/23	Wed 1/18/23	21
23	0%	TxDOT & County Review	4 wks	Wed 12/28/22	Tue 1/24/23	21SS+45 days
24	0%	90% Review by City	2 wks	Thu 1/19/23	Wed 2/1/23	22
25	0%	Update Schedule with Utility Relocations estimate	1 wk	Thu 1/19/23	Wed 1/25/23	22
26	0%	100% PS&E	7 wks	Thu 2/2/23	Wed 3/22/23	19,23,25,22,24
27	0%	100% Design/PS&E Subm	1 day	Thu 3/23/23	Thu 3/23/23	26
28	0%	100% Review by City	2 wks	Fri 3/24/23	Thu 4/6/23	27
29	0%	Bid Services	13 wks	Fri 4/7/23	Thu 7/6/23	28
30	0%	Bid Package Submittal	1 day	Fri 4/7/23	Fri 4/7/23	29SS
31	0%	Bid Pkg Review by City	2 wks	Mon 4/10/23	Fri 4/21/23	30
32	0%	Advertising	3 wks	Mon 4/24/23	Fri 5/12/23	31
33	0%	Pre-Bid Conferences	1 day	Fri 5/12/23	Fri 5/12/23	32SS+14 days
34	0%	Bid Openings	1 day	Mon 5/15/23	Mon 5/15/23	32
35	0%	Review Bids/Award/Excute Contracts	7.4 wks	Tue 5/16/23	Wed 7/5/23	34
36	0%	Public Involvement 2-1	3 wks	Thu 6/15/23	Wed 7/5/23	35SS+22 days
37	0%	Public Involvement 2-2	3 wks	Thu 6/15/23	Wed 7/5/23	35SS+22 days
38	0%	Construction - M&O (2 Mo. Duration)	8 wks	Thu 7/6/23	Wed 8/30/23	36,37
39	0%	Construction - Reconstruct (10 Mo. Duration)	42 wks	Thu 7/6/23	Wed 4/24/24	36,37

Project: Project1
Date: Fri 5/13/22

Task Split

█ Milestone ◆ Project Summary ▬ Inactive Milestone ◆ Manual Task █ Manual Summary Rollup ▬ Start-only ▬ External Tasks ▬ Deadline ▬ Manual Progress
⋯ Summary ▬ Inactive Task ▬ Inactive Summary ▬ Duration-only ▬ Manual Summary ▬ Finish-only ▬ External Milestone ◆ Progress