

CONCEPTUAL ALIGNMENT OF PROPOSED ROADS

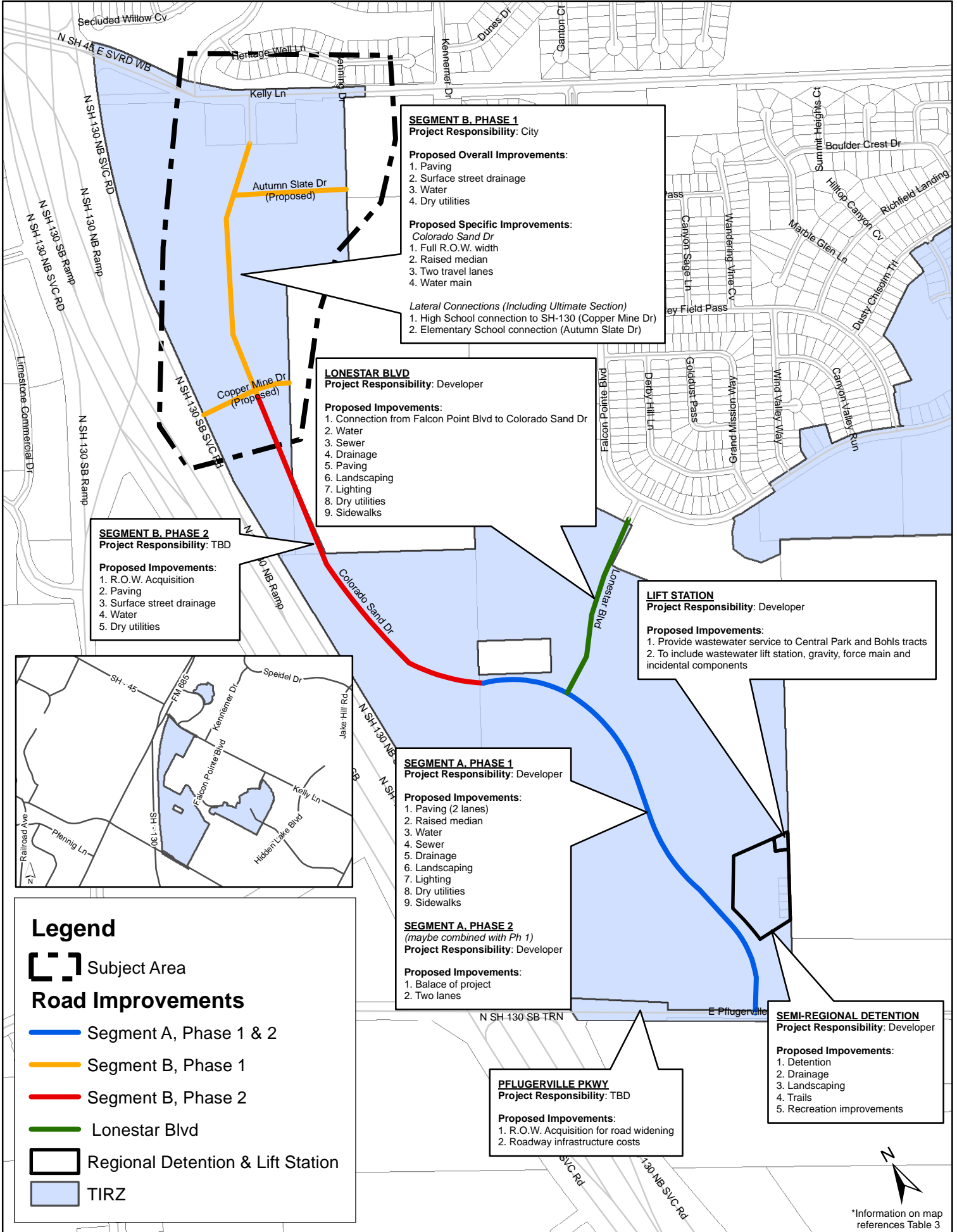

SEGMENT B, PHASE 1
 Project Responsibility: City

Proposed Overall Improvements:

1. Paving
2. Surface street drainage
3. Water
4. Dry utilities

Proposed Specific Improvements:

Colorado Sand Dr

1. Full R.O.W. width
2. Raised median
3. Two travel lanes
4. Water main

Lateral Connections (Including Ultimate Section)

1. High School connection to SH-130 (Copper Mine Dr)
2. Elementary School connection (Autumn Slate Dr)

LONESTAR BLVD
 Project Responsibility: Developer

Proposed Improvements:

1. Connection from Falcon Pointe Blvd to Colorado Sand Dr
2. Water
3. Sewer
4. Drainage
5. Paving
6. Landscaping
7. Lighting
8. Dry utilities
9. Sidewalks

SEGMENT B, PHASE 2
 Project Responsibility: TBD

Proposed Improvements:

1. R.O.W. Acquisition
2. Paving
3. Surface street drainage
4. Water
5. Dry utilities

LIFT STATION
 Project Responsibility: Developer

Proposed Improvements:

1. Provide wastewater service to Central Park and Bohls tracts
2. To include wastewater lift station, gravity, force main and incidental components

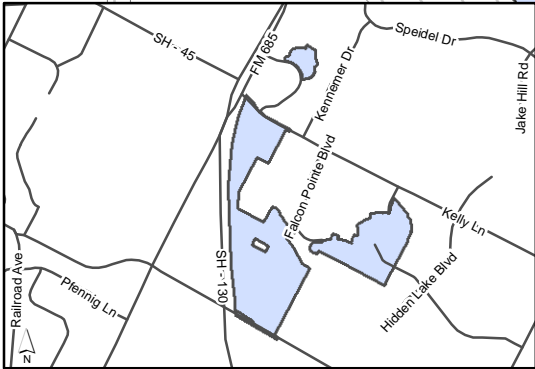

SEGMENT A, PHASE 1
 Project Responsibility: Developer

Proposed Improvements:

1. Paving (2 lanes)
2. Raised median
3. Water
4. Sewer
5. Drainage
6. Landscaping
7. Lighting
8. Dry utilities
9. Sidewalks

SEGMENT A, PHASE 2
 (maybe combined with Ph 1)
 Project Responsibility: Developer

Proposed Improvements:

1. Balance of project
2. Two lanes

PFLUGERVILLE PKWY.
 Project Responsibility: TBD

Proposed Improvements:

1. R.O.W. Acquisition for road widening
2. Roadway infrastructure costs

SEMI-REGIONAL DETENTION
 Project Responsibility: Developer

Proposed Improvements:

1. Detention
2. Drainage
3. Landscaping
4. Trails
5. Recreation improvements

Legend

Subject Area

Road Improvements

- Segment A, Phase 1 & 2
- Segment B, Phase 1
- Segment B, Phase 2
- Lonestar Blvd
- Regional Detention & Lift Station
- TIRZ