

# **AGREEMENT REGARDING POST-ANNEXATION PROVISION OF SERVICES**

This Agreement is entered into by and between the City of Pflugerville, a Texas Municipal Corporation (“City”), acting by and through its City Manager, and Pflugerville Independent School District (“Landowner”), both of which may be referred to herein singularly as “Party” or collectively as the “Parties.”

## **Recitals**

**WHEREAS**, the Landowner has requested that the City consider annexation of a tract of land totaling approximately 149.96 acres of land situated in the Joseph Wehl Survey No. 8, Abstract No. 802, Travis County, Texas, as specifically described in **Exhibit “A”** (“Property”), which is attached hereto and incorporated herein for all purposes; and

**WHEREAS**, in accordance with Texas Local Government Code, Chapter 43, Sub-Chapter C-3, Sections 43.067 et seq., the City and the Landowner must enter into a written agreement identifying a list of public services to be provided to the Property and a schedule for provision of the same; and

**WHEREAS**, this Agreement is being entered into by and between the Parties to comply with the Texas Local Government Code prior to the City’s consideration of an ordinance annexing the Property, it being understood and agreed to by the Parties that annexation of the Property is a condition precedent to this Agreement becoming effective; and

**WHEREAS**, this Agreement shall be deemed effective on the effective date of an ordinance approved by the City annexing the Property (the “Effective Date”).

**NOW, THEREFORE**, in consideration of the mutual covenants and agreements contained herein and for other good and valuable consideration, the receipt and sufficiency of which are hereby acknowledged, the Parties agree as follows:

## **Section 1.**

The Parties hereto acknowledge and agree that the foregoing recitals are hereby found to be true and correct and are hereby adopted by the Parties and made a part hereof for all purposes.

## **Section 2.**

The following service list and schedule (“Service Plan”) represents the provision of services agreed to between the Landowner of the Property and the City establishing a program under which the City will provide municipal services to the Property (referred to hereinafter as the “Annexed Area”) on the Effective Date of this Agreement, as required by § 43.0672 of the Texas Local Government Code, which will be provided at a level consistent with service levels provided to other similarly-situated areas within the City:

I.

- A. Police Protection. The City provides police service within its City limits, including routine patrols through the City and law enforcement services upon call. Upon annexation, police protection will be provided to the Annexed Area at a level consistent with the service to other areas of the City with similar population density and characteristics. The City's police services include neighborhood patrols, criminal investigations, crime prevention, community services and school programs.
- B. Fire Protection and Emergency Medical Service.
1. Travis County Emergency Services District No. 2 (TCESD #2) includes the City and the Annexed Area. TCESD #2 will continue to provide fire protection service to the Annexed Area after annexation.
  2. The City fire marshal enforces the City fire code, investigates fires, and conducts fire prevention inspections within the City limits, and will provide these services within the Annexed Area upon annexation.
  3. The City provides Emergency Medical Transport Services through an interlocal agreement with Travis County, Texas. Upon annexation, transport services will be provided to the Annexed Area at a level consistent with the service to other areas of the City with similar population density and characteristics. Emergency Medical First Responder Services are provided by TCESD #2, and TCESD #2 will continue to provide such services to the Annexed Area after annexation.

II.

Upon annexation, the City will provide the following municipal services to the Annexed Area on the same basis as it provides such services to other similarly situated areas of the City:

- A. Solid Waste Collection. The City provides residential solid waste collection services within the City limits for a fee under a contract between the City and various private refuse collection companies. The residential solid waste collection services include garbage collection, recycling, bulky item collection and brush collection or chipping. Commercial solid waste collection services are also available. This service will be provided for a fee to any person within the Annexed Area requesting the service after the date of annexation, provided that a privately owned solid waste management service provider ("POSWMSP") is unavailable. In the event that the Annexed Area is already receiving service, or desires to receive service from a POSWMSP, the City may not prohibit solid waste collection by the POSWMSP, nor may the City offer solid waste collection services for a period of two years following the effective date of the annexation unless a POSWMSP is or becomes unavailable, as established by Texas Local Government Code § 43.0661. If a landowner uses the services of a POSWMSP or services are available from a POSWMSP during the two years following annexation, the City will not provide solid waste collection services to that landowner.

- B. Maintenance. Routine maintenance of the following City-owned facilities, if any, will be provided within the Annexed Area upon the effective date of annexation:
1. **Water and wastewater facilities** that are not within the service area of another water or wastewater utility. These facilities will include all internal water and wastewater distribution and collection lines owned by the City that are within the Annexed Area. The City maintains distribution and collection lines and handles all customer billing, service calls and complaints.
  2. **Public streets and right-of-ways.** The City provides street repairs, improvements, inspections, street lighting and traffic control devices. This City does not maintain private streets or private right-of-ways or other public owned streets under the ownership and control of another public entity.
  3. **Publicly owned parks, playgrounds, and swimming pools.** The City will maintain and operate City-owned land and facilities within the Annexed Area.
  4. **Other public easement, facilities or buildings,** including drainage facilities, such as drainage channels, storm sewers and detention ponds contained within dedicated public easements not under the ownership and control of another public entity. The City maintains drainage facilities through regular mowing and cleaning or repair, as needed. The City will periodically inspect facilities and perform maintenance on facilities in the Annexed Area as necessary to ensure continued functionality of the facilities through the year. Any unacceptable conditions that exist in the drainage areas and are reported to the City of Pflugerville between scheduled inspections will be evaluated and resolved as necessary. A maintenance schedule for these areas can be obtained from the Public Works and Parks and Recreation Departments.
- C. Development Regulation. The City will impose and enforce zoning, subdivision development, site development and building code regulations within the Annexed Area upon the effective date of the annexation. Enforcement will be in accordance with City ordinances. Development plans and plats for projects within the Annexed Area will be reviewed for compliance with City standards.
- D. Other Services. City recreational facilities, including parks and library, will be available for use by landowners or residents of the Annexed Area on the same basis as those facilities are available to current City landowners and residents. City residents receive program preference for some City programs. Other City services including Animal Control, Code Enforcement, Municipal Court and General Administration services will be also be available to landowners and residents in the Annexed Area on the same basis those facilities are available to current City landowners and residents. All other services contemplated herein will be available upon the effective date of annexation.

### III.

- A. Capital Improvements. Capital improvement acquisition or construction will occur in accordance with applicable ordinances and regulations and the adopted capital improvement plans of the City, as amended, which are incorporated herein by reference.
- B. Water and Wastewater Service. For portions of the Annexed Area not within the certificated service areas of the City, water and wastewater service to such areas will be subject to service extension regulations and policies provided in the City's Unified Development Code, as amended.

The portions of the Annexed Area that are currently within the certificated service areas of other water and wastewater utilities will continue to receive water and wastewater utility services from such utility providers after annexation, unless subsequent agreements are entered into between the City and the other utility providers.

### IV.

- A. In accordance with Texas Local Government Code § 43.0672(c), no other services are contemplated by this Service Plan and a schedule for future services as contemplated by Texas Local Government Code § 43.0672(b) is not applicable as all services identified herein will be provided upon the effective date of annexation.

### Section 3.

#### General Terms.

1. **Binding Effect/Authority.** This Agreement binds and inures to the benefit of the Parties and their respective heirs, successors, and permitted assigns. Each Party further warrants that each signatory to this Agreement is legally authorized to bind the respective individual or entity for the purposes established herein.
2. **Choice of Law.** This Agreement will be construed under the laws of the State of Texas, without regard to choice-of-law rules of any jurisdiction. Venue for any dispute shall lie exclusively in Travis County, Texas.
3. **Counterparts.** This Agreement may be executed in any number of counterparts with the same effect as if all signatory Parties had signed the same document. All counterparts will be construed together and will constitute one and the same instrument.
4. **Legal Construction.** If any provision in this Agreement is for any reason found to be unenforceable, to the extent the unenforceability does not destroy the basis of the bargain among the parties, the unenforceability will not affect any other provision hereof, and this Agreement will be construed as if the unenforceable provision had never been a part of the Agreement. Whenever context requires, the singular will include the plural and neuter include the masculine or feminine gender, and vice versa. Headings in this Agreement are for reference only and are not intended to

restrict or define the text of any section. This Agreement will not be construed more or less favorably between the Parties by reason of authorship or origin of language.

5. Entire Agreement. This Agreement contains the entire Agreement between the Parties relating to the rights herein granted and the obligations herein assumed and cannot be varied except by written agreement of the Parties. Any oral representation or modification concerning this instrument shall be of no force and effect except for any subsequent modification in writing, signed by the Party to be charged.

**Executed and Agreed to by the Parties on this the \_\_\_ day of \_\_\_\_\_ 2019.**

**CITY OF PFLUGERVILLE**

**ATTEST:**

by: \_\_\_\_\_  
Sereniah Breland, City Manager

by: \_\_\_\_\_  
Karen Thompson, City Secretary

Date: \_\_\_\_\_

Date: \_\_\_\_\_

**APPROVED AS TO FORM:**

By: \_\_\_\_\_  
Charles E. Zech, City Attorney  
Denton, Navarro, Rocha, Bernal & Zech, P.C.

**PROPERTY OWNER(S):**

Pflugerville Independent School District

By: Vernagene Mott

Name (Print): Mrs. Vernagene Mott

Title: President, Board of Trustees

Date: 2-7-2019

EXHIBIT "A"

PROPERTY/ANNEXED AREA

DESCRIPTION OF A 149.96 ACRE TRACT OF LAND, OUT OF THE JOSEPH WEIHL SURVEY NO. 8, ABSTRACT NO. 802, IN TRAVIS COUNTY, TEXAS, SAID 149.96 ACRE TRACT BEING THE REMAINDER OF AN ORIGINAL 172.85 ACRE TRACT DESCRIBED IN VOLUME 4232 PAGE 2153 OF THE DEED RECORDS OF TRAVIS COUNTY, TEXAS FROM WHICH 172.85 ACRE TRACT, A 4 ACRE TRACT AND A 16 ACRE TRACT WERE TAKEN OUT OF THE ORIGINAL 172.85 ACRE TRACT, RESULTING IN THE 149.96 ACRE TRACT HEREIN DESCRIBED. THE 4 ACRE TRACT IS AS RECORDED IN VOLUME 4656, PAGE 1010 AND THE 16 ACRE TRACT IS AS RECORDED IN VOLUME 4727, PAGE 383.

A 99/100 UNDIVIDED INTEREST ON THE SAID 149.96 ACRE TRACT WAS CONVEYED IN 2004 TO TIMMERMAN FARMS LTD. IN DOCUMENT NUMBER 2004240368 OF THE OFFICIAL PUBLIC RECORDS, TRAVIS COUNTY, TEXAS, AND A 1/100 UNDIVIDED INTEREST WAS CONVEYED IN THE SAME YEAR TO TIMMERMAN FARMS LTD. IN DOCUMENT NUMBER 2004240373 OF THE OFFICIAL PUBLIC RECORDS, TRAVIS COUNTY, TEXAS. AN UNDIVIDED 7.4% INTEREST ON THE SAID 149.96 ACRE TRACT WAS CONVEYED IN 2014 TO CHERYL TIMMERMAN GREINER RECORDED IN DOCUMENT NUMBER 2014151492 OF THE OFFICIAL PUBLIC RECORDS, TRAVIS COUNTY TEXAS.

A 1.00 ACRE TRACT WHOLLY CONTAINED WITHIN THE SAID 149.96 ACRE TRACT DESCRIBED HEREIN WAS CONVEYED IN 2012 TO THEODOR R. TIMMERMAN AND WIFE, MARLENE TIMMERMAN RECORDED IN DOCUMENT NUMBER 2012208998 OF THE OFFICIAL PUBLIC RECORDS, TRAVIS COUNTY AND IS NOT DESCRIBED SEPARATLY FROM THE SAID 149.96 ACRE TRACT WHICH IS HEREIN DESCRIBED MORE PARTICULARLY DESCRIBED BY METES AND BOUNDS AS FOLLOWS:

**BEGINNING** at an ½" rebar found with a destroyed red cap for the southwest corner of the herein described Tract same being the northwest corner of a 1.893 acre Tract conveyed to Sivaramakrishnana Venkatraman recorded in Document Number 2013093529 of the Official Public Records, Travis County, Texas, also being a point on the east right of way line of Weiss Lane, from which a magnetic nail found in a concrete culvert for the southeast corner of a 32.29 acre Tract conveyed to Joe Weiss, recorded in Document Number 2001065238 of the Official Public Records, Travis County, Texas, bears N 62° 03' 05" E 58.84 feet,

THENCE, N 27° 33' 41" E 2503.99 feet along the west line of the herein described Tract same being the east right of way line of Weiss Lane to a ½" pipe found for the northwest corner of the herein described Tract, same being southwest corner of a remainder of 4 acres conveyed as Tract 3 to Irby M. Ford recorded in Volume 11526 Page 796 of the Real Property Records of Travis County, Texas,

THENCE, S 62° 25' 19" E along the north line of the herein described Tract same being the south line of said Tract 3 at 260.60 feet passing the southeast corner of the said remainder of 4 acres Tract 3 and the southwest corner of a 2.00 acre Tract conveyed to Irby M. Ford recorded in Volume 11526 Page 796 of the Real Property Records of Travis County, Texas, in all 521.30 feet to an ½" pipe found for the southeast corner of Tract 2 of said Volume 11526 Page 796, and the southwest corner of a 16.00 acre Tract 1 conveyed to Irby M. Ford recorded in Volume 11526 Page 796 of the Real Property Records of Travis County, Texas, (Tract 2 and 3 are the 4.00 acres in volume 4656 page 1010) Tract 1 is the 16.00 acre Tract in Volume 4727 Page 383

THENCE, S 62° 27' 08" E 2086.85 feet continuing with the north line of the herein described Tract, same being the south line of the said 16.00 acre Tract 1, to a ½" pipe found for the northeast corner of the herein described Tract, same being the southeast corner of said 16.00 acre Tract 3 and being a point on the west line of 51.598 acre Tract conveyed to ARP Autumn Ridge Partners LP. Recorded in Document Number 2007065360 of the Official Public Records of Travis County, Texas,

THENCE, S 27° 32' 22" W with the east line of the herein described Tract same being the west line of said 51.598 acre Tract, at 1291.32 feet passing the southwest corner of said 51.598 acre Tract, same being the northwest corner of a 31.782 acre Tract 2A, conveyed to 130 Cactus Investments L.P., recorded in Document Number 2008121344 of the Official Public Records of Travis County, Texas, (no monument was found at this corner) in all 2504.17 feet to a ½" pipe found for the southeast corner of the herein described Tract, same being the southwest corner of said 31.782 acre Tract, same being a point on the north line of a 46.615 acre Tract conveyed to ARP Autumn Ridge Partners L.P. recorded in Document Number 2007059997 of the Official Public Records of Travis County, Texas.

THENCE, N 62° 26' 32" W with the south line of the herein described Tract, same being the north line of said 46.615 acre Tract, at 1243.44 feet passing the northwest corner of said 46.615 acre Tract same being the northeast corner of a 5.0 acre Tract conveyed to C. J. & Irene King recorded in Volume 5426 Page 1856 of the Deed Records of Travis County, Texas, at 1831.27 passing a ½" rebar found for the north west corner of said 5.0 acre Tract, same being the most northerly northeast corner of said 1.893 acre Tract conveyed to

Sivaramakrishnana Venkatraman in all 2609.11 feet to the **POINT OF BEGINNING** and containing 149.96 acres more or less;



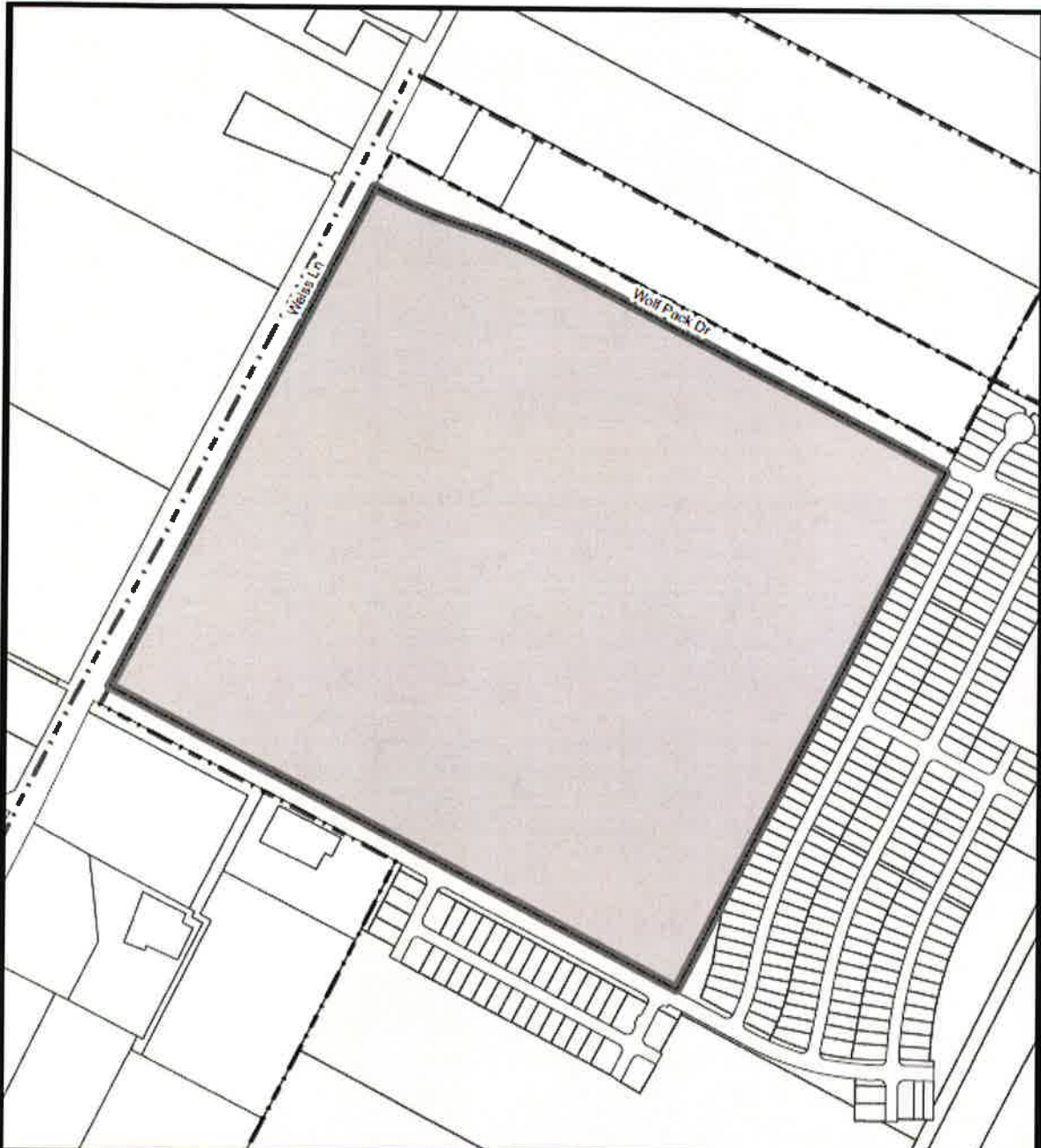

**Weiss High School Property**



---

**Case Number:**  
**ANX1901-01**

---

**1/4/19**

**Legend**

-  Annexation
-  ETJ
-  City Limits

 Feet



When required the City of Pflugerville complies with Texas Local Government Code for public notifications. All notification addresses are derived from the role information that is certified annually.

 **PFLUGERVILLE**  
TEXAS

