

Authorizing the City Manager to execute a conditional purchase agreement and associated conveyance documents between BH Pflugerville Golf, LP (Parcel 9) and the City of Pflugerville as necessary to acquire real property interests for the Kelly Lane Phase 2 Roadway Project.

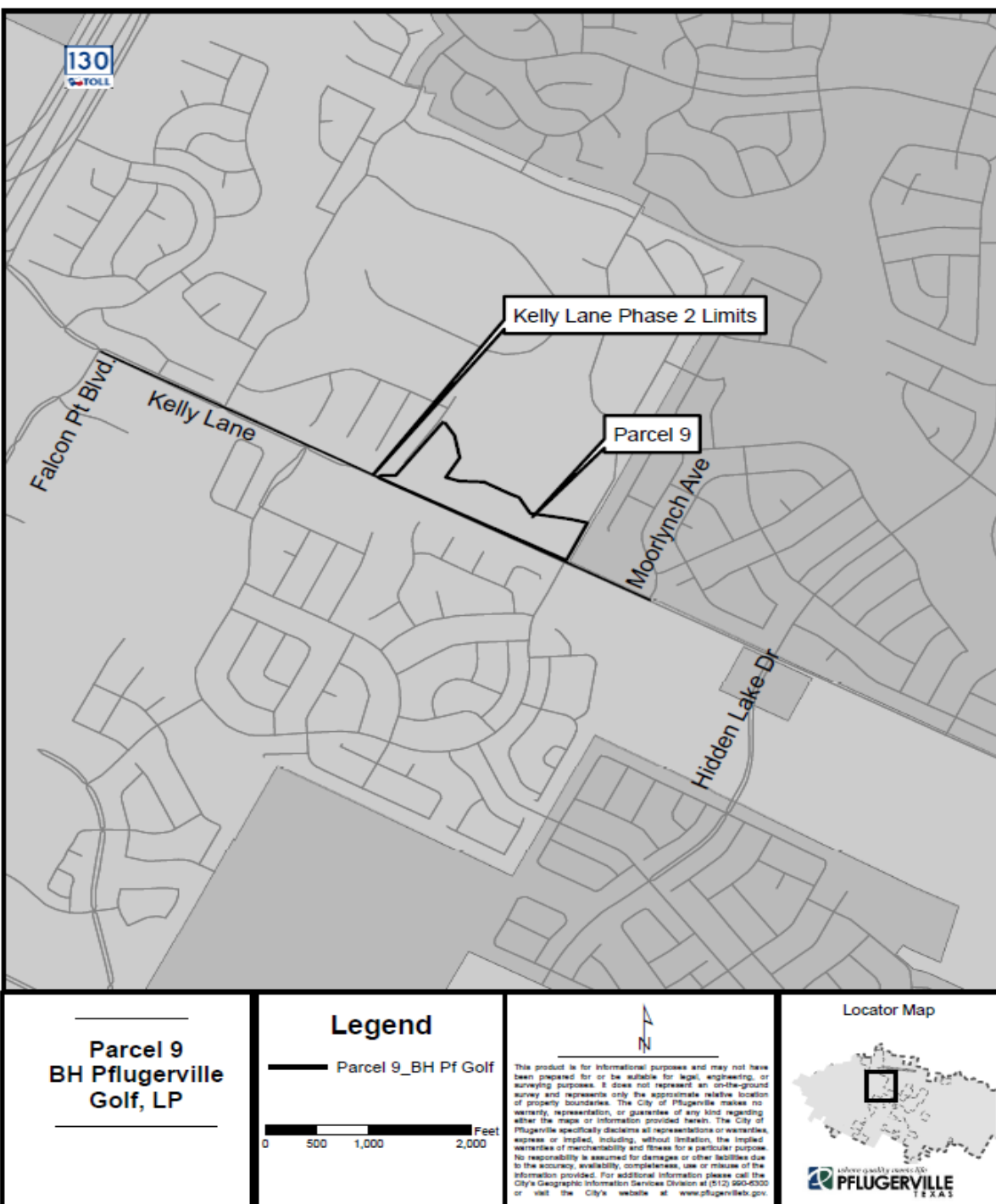

# Parcel 9, BH Pflugerville

- Initial offer accepted
- \$208,298.00



## Staff Recommendation

Staff recommends Authorizing the City Manager to execute a conditional purchase agreement and associated conveyance documents between BH Pflugerville Golf, LP (Parcel 9) and the City of Pflugerville as necessary to acquire real property interests for the Kelly Lane Phase 2 Roadway Project.

