

**TRAVIS COUNTY CONSUMER
PROTECTION NOTICE FOR HOMEBUYERS.**

IF YOU ARE BUYING A LOT OR HOME IN THIS SUBDIVISION, YOU SHOULD
DETERMINE WHETHER IT IS INSIDE OR OUTSIDE THE CITY LIMITS.

DEPENDING ON STATE LAW AND OTHER FACTORS, LAND OUTSIDE THE CITY LIMITS
MAY BE SUBJECT TO FEWER LOCAL GOVERNMENT CONTROLS OVER THE
DEVELOPMENT AND USE OF LAND THAN INSIDE THE CITY LIMITS, BECAUSE OF THIS,
LOCAL GOVERNMENT MAY NOT BE ABLE TO RESTRICT THE NATURE OR EXTENT OF
DEVELOPMENT NEAR THE LOT OR HOME NOR PROHIBIT NEARBY LAND USES THAT
ARE INCOMPATIBLE WITH A RESIDENTIAL NEIGHBORHOOD.

THIS CAN AFFECT THE VALUE OF YOUR PROPERTY. TRAVIS COUNTY REQUIRES THIS
NOTICE TO BE PLACED ON SUBDIVISION PLATS. IT IS NOT A STATEMENT OR
REPRESENTATION OF THE OWNER OF THE PROPERTY,
THE SUBDIVIDER, OR THEIR REPRESENTATIVES.

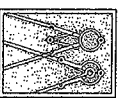

GRAY & ASSOCIATES, INC.
Consulting Engineers
8217 Shoal Creek Blvd., Suite 200
Austin, Texas 78757-7592
(512)462-0871 FAX(512)464-9933
TBPB FIRM # 29346

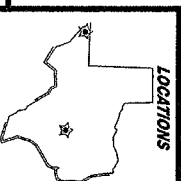

ZWA
Zamora, L.L.C.
Professional Land Surveyors
1485 South Loop 4, P.O. Box 1096, Bldg. Texas 78610
Tel: (512) 296-6201 • Fax: (512) 296-6091

| | | |
|--|------------------|-----------------------|
| TECH: SECURA | SURV: GRZ | SHEET 1 OF 4 |
| DATE: OCTOBER, 2011 | SCALE: 1" = 100' | |
| DRAWING FILE: 11-1002-11 CARL III-B SHEETS 1-3.DWG | | |
| PROJECT: COMMONS @ ROWE LANE - PHASE III-B | | |
| JOB NO: 11-1002-11 | | |

FINAL PLAT THE COMMONS AT ROWE LANE PHASE III B

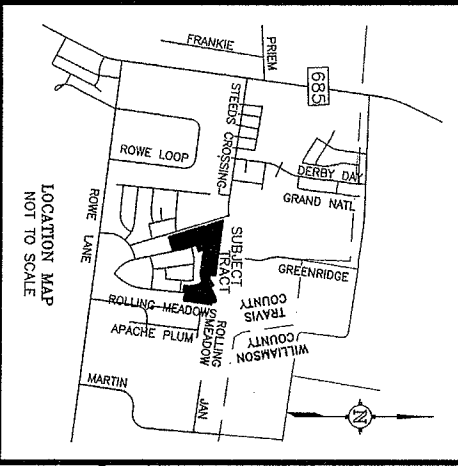

THE COMMONS AT ROWE LANE, LP
 (10,032 ACRES)
 OCTOBER, 2011
 D.C. NO. 2005045836
 O.P.R.I.C.T.
 TRAVIS COUNTY, TEXAS

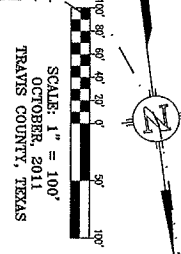

- LEGEND**
- 1/2" IRON ROD FOUND
 - 1/2" IRON ROD WITH CAP SET
 - ⊠ CONCRETE MONUMENT SET
 - ⊙ BENCHMARK
 - ⊣ SIDEWALK
 - 4" SIDEWALK
 - ROW RIGHT-OF-WAY
 - BL. BUILDING SETBACK LINE
 - SF. SQUARE FEET
 - POB POINT OF BEGINNING
 - Ⓐ PUE PUBLIC UTILITY EASEMENT
 - Ⓛ BLOCK LETTER
- LT# 9
 R.P.R.I.C.T. REAL PROPERTY RECORDS
 TRAVIS COUNTY, TEXAS
 O.P.R.I.C.T. OFFICIAL PUBLIC RECORDS
 TRAVIS COUNTY, TEXAS
 P.R.I.C.T. PLAT RECORDS
 TRAVIS COUNTY, TEXAS

BENCHMARK LIST

BW#1: COTTON SPINDLE SET IN THE SOUTHWEST BASE OF A 1 1/2" LIVE OAK, APPROX. 700' NORTH OF INTERSECTION OF WINDMILL RANCH AVE. & COMMONS PARKWAY.
 NORthing = 10,152,756.13
 EASTing = 3,167,197.81
 ELEV. = 687.87

BW#2: ARROW MARK IN CONCRETE ON NORTH EDGE OF WASTEWATER MANHOLE
 NORthing = 10,154,130.49
 EASTing = 3,166,557.78
 ELEV. = 685.10

ROLLING HILLS
 BOOK 76, PAGE 277
 CRESTED VANE DRIVE

LOT 10

LAND USE

SINGLE FAMILY LOTS = 38
 DRAINAGE ESMT & PARKLAND LOTS = 2
 DRAINAGE ESMT & OPEN SPACE LOTS = 2
 DETENTION POND, DRAINAGE ESMT & OPEN SPACE LOTS = 1

CUMULATIVE DENSITY CALCULATIONS

TOTAL NUMBER OF RESIDENTIAL UNITS: 38
 TOTAL AREA OF RESIDENTIAL LOTS AND LOCAL AND COLLECTOR STREETS: 10,635 AC.

| | |
|---------------|------------|
| ACREAGE | 6,904 AC. |
| BLOCK H | 4,614 AC. |
| BLOCK M | 4,206 AC. |
| BLOCK N | 4,143 AC. |
| BLOCK O | 1,392 AC. |
| BLOCK FF | 3,243 AC. |
| RIGHT-OF-WAY | 3,243 AC. |
| TOTAL ACREAGE | 24,502 AC. |

LINEAR FEET OF NEW STREETS

| | | |
|-----------------------|---------|-----------|
| WINDY VANE DRIVE | 60' ROW | 1444 L.F. |
| WINDMILL RIDGE STREET | 50' ROW | 681 L.F. |
| WINDY VANE DRIVE | 50' ROW | 325 L.F. |
| CRESTED VANE DRIVE | 50' ROW | 180 L.F. |
| TOTAL | | 2640 L.F. |

COMMONS AT ROWE LANE, LP
 (71,402 ACRES)
 D.C. NO. 2007205045
 O.P.R.I.C.T.

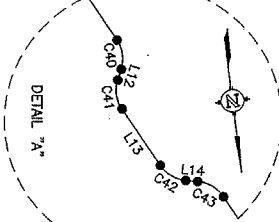

ZWA
Zantora, L.L.C.
Professional Land Surveyors
 1485 South Loop 4, P.O. Box 1036, Buda, Texas 78610
 Tel: (512) 295-6201 • Fax: (512) 295-6091

GRAY & ASSOCIATES, INC.
 Consulting Engineers
 8217 Shoal Creek Blvd., Suite 200
 Austin, Texas 78757-7592
 (512)452-0871 FAX(512)454-9833
 TBE# FRM # 2846

LOCATIONS

TECH: SEQUA
SURV: GRZ
DATE: OCTOBER, 2011
SCALE: 1" = 100'
DRAWING FILE: 11-1002-11 CARL III-B SHEETS 1-3.DWG
PROJECT: COMMONS @ ROWE LANE - PHASE III-B
JOB NO: 11-1002-11

SHEET
 2
 OF
 4

FINAL PLAT THE COMMONS AT ROWE LANE PHASE III B

LEGAL DESCRIPTION

DESCRIPTION OF A 24.502 ACRE TRACT OF LAND, SITUATED IN THE JACOB CASNER SURVEY, ABSTRACT NO. 2753, BEING A PORTION OF THAT CERTAIN 108.529 ACRE TRACT OF LAND CONVERTED TO THE COMMONS AT ROWE LANE, L.P., OF RECORD IN DOCUMENT NO. 2005022370 OF THE OFFICIAL PUBLIC RECORDS OF TARRANT COUNTY, TEXAS, AND BEING A PORTION OF THAT CERTAIN 71.402 ACRE TRACT OF LAND CONVERTED TO THE COMMONS AT ROWE LANE, L.P., OF RECORD IN DOCUMENT NO. 2005045858 OF TARRANT COUNTY, TEXAS, THE OFFICIAL PUBLIC RECORDS OF TARRANT COUNTY, TEXAS, SAID 24.502 ACRE TRACT BEING MORE PARTICULARLY DESCRIBED BY METES AND BOUNDS AS FOLLOWS:

BEGINNING at a Concrete Monument set for the northwest corner of the herein described tract, being also the northeast corner of The Commons at Rowe Lane Phase II B of record in document No. 2011000282 of the Official Public Records of Tarrant County, Texas, being also the north line of said 108.529 acre tract, and being on the south line of that certain 10,032 acre tract of land conveyed to The Commons at Rowe Lane, L.P., of record in document No. 2005045858 of the Official Public Records of Tarrant County, Texas;

THENCE S 82°29'22" E, with the north line of said 108.529 acre tract, the south line of said 10,032 acre tract, at 21.50 feet, pass the northeast corner of said 108.529 acre tract, being also the northwest corner of said 71.402 acre tract, at 32.14 feet, pass the southeast corner of said 10,032 acre tract, being also the southwest corner of Lot 9, Rolling Hills, a subdivision of record in Book 76, Page 277 of the Plat Record of Tarrant County, Texas, at 534.28 feet, pass the southwest corner of said Lot 9, Rolling Hills, a subdivision of record in Book 76, Page 277 of the Plat Record of Tarrant County, Texas, for a total distance 1294.25 feet to a 1/2 inch iron iron rod found for the southeast corner of said Lot 10, being also on all corner of said 71.402 acre tract;

THENCE, depicting the south line of said Rolling Hills subdivision, over and across said 71.402 acre tract the following ten (10) courses and distances:

1. S 02°45'20" E, for a distance of 146.75 feet to a 1/2 inch iron rod with cap (ZMA) set on a curve to the left.

2. along said curve to the left, on arc distance of 186.12 feet, said curve having a radius of 570.00 feet, a central angle of 18°42'32" and a chord bearing of N 74°52'50" E, for a chord distance of 185.50 feet to a 1/2 inch iron rod with cap (ZMA) set at the beginning of a compound curve to the left,

3. along said curve to the left, on arc distance of 23.99 feet, said curve having a radius of 15.00 feet, a central angle of 91°37'43" and a chord bearing of N 19°22'22" E, for a chord distance of 21.51 feet to a 1/2 inch iron rod with cap (ZMA) set at the end of said curve,

4. N 63°48'59" E, for a distance of 50.00 feet to a 1/2 inch iron rod with cap (ZMA) set at the beginning of a curve to the left,

5. along said curve to the left, on arc distance of 23.56 feet, said curve having a radius of 15.00 feet, a central angle of 90°00'00" and a chord bearing of S 71°25'50" E, for a chord distance of 21.21 feet to a 1/2 inch iron rod with cap (ZMA) set at the end of said curve,

6. S 26°26'30" E, for a distance of 60.00 feet to a 1/2 inch iron rod with cap (ZMA) set.

7. N 63°33'30" E, for a distance of 190.20 feet to a 1/2 inch iron rod with cap (ZMA) set at the beginning of a curve to the left,

8. along said curve to the right, on arc distance of 173.49 feet, said curve having a radius of 570.00 feet, a central angle of 17°38'23" and a chord bearing of N 72°22'42" E, for a chord distance of 174.80 feet to a 1/2 inch iron rod with cap (ZMA) set at the end of said curve,

9. S 11°18'19" E, for a distance of 121.25 feet to a 1/2 inch iron rod with cap (ZMA) set, and

10. N 81°10'12" E, for a distance of 41.36 feet to a 1/2 inch iron rod found for an all corner of said 71.402 acre tract, being also the northwest corner of Lot 28, Block A, Rolling Meadows Section One, a subdivision of record in Book 85, Page 47C of the Plat Record of Tarrant County, Texas, and being the northeast corner of the herein described tract;

THENCE, depicting the west line of said Rolling Meadows, Section One, over and across said 71.402 acre tract, being also along the north line of said The Commons at Rowe Lane, Phase II A, the following three (3) courses and distances:

1. N 82°25'04" W, for a distance 210.35 feet to a 1/2 inch iron rod with cap (ZMA) found,

2. S 07°34'59" W, for a distance of 35.87 feet to a 1/2 inch iron rod with cap (ZMA) found, and

3. N 82°25'04" W, for a distance of 133.00 feet to a 1/2 inch iron rod with cap (ZMA) found for the great northerly northwest corner of said The Commons at Rowe Lane, Phase II A, being also the northeast corner of Lot 28, Block A, of said Rolling Meadows, Section One subdivision, at 579.23 feet, pass the southwest corner of said Lot 27, Block A, being also the northwest corner of Lot 12, Block A, of said Rolling Meadows, Section One subdivision, for a total distance of 643.00 feet to a 1/2 inch iron rod found for the southeast corner of the herein described tract, being also the northeast corner of The Commons at Rowe Lane, Phase II A, a subdivision of record in Document No. 200800219, of the Official Public Records of Tarrant County, Texas;

THENCE, depicting the north line of said The Commons at Rowe Lane, Phase II A, over and across said 71.402 acre tract, being also in the east, north, and west lines of said The Commons at Rowe Lane, Phase III A, the following twelve (12) courses and distances:

1. N 07°44'56" E, for a distance of 62.46 feet to a 1/2 inch iron rod with cap (ZMA) set,

2. N 01°11'09" W, for a distance of 59.28 feet to a 1/2 inch iron rod with cap (ZMA) set,

3. N 06°50'49" W, for a distance of 144.63 feet to a 1/2 inch iron rod with cap (ZMA) set,

4. N 26°26'30" W, for a distance of 188.87 feet to a 1/2 inch iron rod with cap (ZMA) set,

5. S 79°56'23" W, for a distance of 188.87 feet to a 1/2 inch iron rod with cap (ZMA) set,

6. N 86°01'24" W, for a distance of 75.15 feet to a 1/2 inch iron rod with cap (ZMA) set,

7. N 82°29'22" W, for a distance of 520.69 feet to a 1/2 inch iron rod with cap (ZMA) set,

8. S 16°44'31" E, for a distance of 132.41 feet to a 1/2 inch iron rod with cap (ZMA) set,

9. S 73°15'29" W, for a distance of 170.00 feet to a 1/2 inch iron rod with cap (ZMA) set,

10. S 16°44'31" E, for a distance of 258.10 feet to a 1/2 inch iron rod with cap (ZMA) set at the beginning of a curve to the right,

11. along said curve to the right, on arc distance of 51.81 feet, said curve having a radius of 575.00 feet, a central angle of 05°09'46" and a chord bearing of S 14°09'38" E, for a chord distance of 51.79 feet to a 1/2 inch iron rod with cap (ZMA) set at the end of said curve, and

12. S 11°34'42" E, for a distance of 268.36 feet to a 1/2 inch iron rod with cap (ZMA) set for the southwest corner of said The Commons at Rowe Lane, Phase III A, being also an angle point in the common line of said 71.402 acre tract, being also on angle point in the said north line of said The Commons at Rowe Lane, Phase III A, and being the northeast corner of Lot 2, Block H, a 1.315 acre Drainage Way and Parkland Lot of the said The Commons at Rowe Lane, Phase III A, and being the northeast corner of Madison Boulevard;

THENCE, leaving the said The Commons at Rowe Lane, Phase III A, along the said common line of said 71.402 acre tract and 108.529 acre tract, being also the north line of said The Commons at Rowe Lane, Phase II A, being also the north line of said Lot 2, Block H of said The Commons at Rowe Lane, Phase II A, passing at a distance of 295.69 feet, the southeast corner of said 71.402 acre tract, being also on all corner in the north line of said 108.529 acre tract, being also the southwest corner of said 71.402 acre tract, being also on all corner in the north line of said The Commons at Rowe Lane, Phase II B, a subdivision of record in Document No. 2011000282, of the Official Public Records of Tarrant County, Texas, being also in the east line of Windmill Ranch Avenue;

THENCE, over and across said 108.529 acre tract and said 71.402 acre tract, being also in the said east line of The Commons at Rowe Lane, Phase II B, being also in the east line of said Windmill Ranch Avenue the following five (5) courses and distances:

1. N 17°13'15" W, for a distance of 851.03 feet to a 1/2 inch iron rod found at the beginning of a curve to the right,

2. along said curve to the right, passing at an arc distance of 33.92 feet, the said common line of 108.529 acre tract and 71.402 acre tract, for a total arc distance of 39.27 feet, said 39.27 feet curve having a radius of 25.00 feet, a central angle of 90°00'00" and a chord bearing of N 27°46'45" E, for a chord distance of 35.36 feet to a 1/2 inch iron rod found at the end of said curve,

3. N 17°13'15" W, for a distance of 60.00 feet to a 1/2 inch iron rod found at the beginning of a curve to the right,

4. along said curve to the right, passing at an arc distance of 5.37 feet, the said common line of 71.402 acre tract and 108.529 acre tract, for a total arc distance of 39.27 feet, said 39.27 feet curve having a radius of 25.00 feet, a central angle of 90°00'00" and a chord bearing of N 27°13'15" W, for a chord distance of 35.36 feet to a 1/2 inch iron rod found at the end of said curve, and

5. N 17°13'15" W, for a distance of 360.73 feet to the POINT OF BEGINNING and containing 24.502 acres of land.

| CURVE | LENGTH | RADIUS | DELTA | CHORD BEARING | CHORD |
|-------|--------|--------|-----------|---------------|--------|
| C1 | 186.12 | 570.00 | 18°42'32" | N72°32'07"E | 185.30 |
| C2 | 23.99 | 15.00 | 91°37'43" | N19°22'22"E | 21.51 |
| C3 | 23.56 | 15.00 | 90°00'00" | S71°26'50"E | 21.21 |
| C4 | 175.49 | 570.00 | 17°38'23" | N72°22'42"E | 174.80 |
| C5 | 39.27 | 25.00 | 90°00'00" | N27°46'45"E | 35.36 |
| C6 | 39.27 | 25.00 | 90°00'00" | N27°13'15"W | 35.36 |
| C7 | 33.88 | 570.00 | 3°24'19" | S74°28'55"W | 33.87 |
| C8 | 24.64 | 15.00 | 94°07'59" | N56°44'57"W | 21.96 |
| C9 | 77.00 | 625.00 | 7°03'33" | N13°12'44"E | 76.99 |
| C10 | 51.81 | 575.00 | 5°09'46" | N14°06'38"W | 51.79 |
| C28 | 70.84 | 575.00 | 7°03'33" | S13°12'44"E | 70.80 |
| C29 | 24.64 | 15.00 | 94°07'59" | S37°23'02"W | 21.96 |
| C30 | 129.93 | 570.00 | 13°03'37" | N89°01'10"W | 129.65 |
| C31 | 357.91 | 630.00 | 32°33'03" | N81°14'07"E | 353.12 |
| C32 | 23.20 | 15.00 | 88°35'55" | N70°44'42"W | 20.95 |
| C33 | 341.45 | 575.00 | 34°01'26" | N09°25'47"W | 336.46 |
| C34 | 327.14 | 625.00 | 34°01'26" | N09°25'47"W | 326.71 |
| C35 | 23.56 | 15.00 | 90°00'00" | S18°33'30"W | 21.21 |
| C36 | 271.94 | 630.00 | 24°43'53" | S86°08'42"W | 269.53 |
| C37 | 23.56 | 15.00 | 90°00'00" | S37°29'22"E | 21.21 |
| C38 | 23.56 | 15.00 | 90°00'00" | S37°29'22"E | 21.21 |
| C39 | 321.57 | 570.00 | 32°19'25" | N81°20'56"E | 317.32 |
| C40 | 8.90 | 10.00 | 50°58'43" | S00°56'43"E | 8.61 |
| C41 | 8.90 | 10.00 | 50°58'43" | N00°56'43"W | 8.61 |
| C42 | 8.90 | 10.00 | 50°58'43" | N51°56'16"W | 8.61 |
| C43 | 8.90 | 10.00 | 50°58'43" | S51°56'16"E | 8.61 |
| C44 | 105.49 | 570.00 | 10°56'18" | S88°44'09"W | 105.34 |
| C62 | 105.49 | 570.00 | 10°56'18" | N88°44'03"W | 105.34 |
| C63 | 24.43 | 570.00 | 4°47'12" | S84°53'03"W | 24.43 |
| C64 | 52.63 | 630.00 | 4°47'12" | S84°52'58"E | 52.62 |
| C65 | 62.64 | 630.00 | 5°41'17" | N89°22'48"E | 62.62 |
| C66 | 62.64 | 630.00 | 5°41'17" | N84°11'30"E | 62.62 |
| C67 | 62.64 | 630.00 | 5°41'17" | N78°30'33"E | 62.62 |
| C68 | 62.64 | 630.00 | 5°41'17" | N67°28'56"E | 62.62 |
| C69 | 56.10 | 630.00 | 5°00'41" | N67°27'56"E | 55.09 |
| C70 | 78.24 | 575.00 | 5°31'39" | N22°40'40"W | 75.49 |
| C71 | 77.12 | 578.00 | 7°41'06" | N25°54'13"W | 77.06 |
| C72 | 77.12 | 578.00 | 7°41'06" | N07°34'51"W | 77.06 |
| C73 | 44.04 | 578.00 | 7°41'06" | N03°51'50"E | 44.54 |
| C74 | 54.83 | 628.00 | 3°28'58" | N03°51'50"E | 54.54 |
| C75 | 62.63 | 628.00 | 5°43'58" | N04°52'39"E | 62.50 |
| C76 | 62.63 | 628.00 | 5°43'58" | N01°00'38"W | 62.50 |
| C77 | 62.63 | 628.00 | 5°43'58" | N06°44'51"W | 62.50 |
| C78 | 62.63 | 628.00 | 5°43'58" | N12°28'47"W | 62.50 |
| C79 | 121.04 | 630.00 | 11°08'46" | N20°53'37"W | 120.95 |
| C80 | 129.16 | 630.00 | 9°28'57" | S72°46'14"W | 129.62 |
| C81 | 62.64 | 630.00 | 5°41'17" | S85°36'21"W | 62.62 |
| C82 | 62.64 | 630.00 | 5°41'17" | N86°42'21"W | 62.58 |
| C83 | 37.08 | 630.00 | 3°22'21" | N84°10'32"W | 37.05 |
| C84 | 8.95 | 570.00 | 0°55'29" | S82°56'21"E | 8.95 |
| C85 | 77.25 | 570.00 | 7°48'53" | N87°16'18"E | 77.19 |
| C86 | 49.25 | 570.00 | 4°57'00" | N86°22'16"E | 49.23 |

| LINE | BEARING | LENGTH |
|------|-------------|--------|
| L1 | N63°48'59"E | 60.00 |
| L2 | S62°28'30"E | 41.36 |
| L3 | N81°10'12"E | 15.87 |
| L4 | S02°24'56"W | 60.00 |
| L5 | N17°13'15"W | 60.00 |
| L6 | N82°29'22"E | 59.27 |
| L7 | N24°53'03"E | 35.36 |
| L8 | N26°26'30"W | 19.28 |
| L14 | N72°58'03"W | 53.33 |
| L20 | N16°20'44"W | 77.99 |
| L21 | N13°15'28"W | 60.71 |
| L22 | N09°40'57"W | 65.65 |
| L24 | N01°11'05"W | 59.28 |
| L27 | S87°19'28"E | 60.94 |
| L28 | N07°30'38"E | 40.42 |
| L29 | N07°34'58"E | 62.46 |

LOT SQUARE FOOTAGE TABLES

| BLOCK | LOT | SQ. FEET | BLOCK | LOT | SQ. FEET |
|-------|-----|----------|-------|-----|----------|
| H | 3 | 3,007.53 | N | 1 | 8,651 |
| M | 2 | 7,800 | N | 2 | 7,800 |
| M | 3 | 7,944 | N | 3 | 8,068 |
| M | 4 | 8,361 | N | 4 | 8,576 |
| M | 5 | 9,176 | N | 5 | 9,488 |
| M | 6 | 9,497 | N | 6 | 12,601.8 |
| M | 7 | 7,600 | N | 7 | 14,608 |
| M | 8 | 7,800 | O | 29 | 8,316 |
| M | 9 | 7,800 | O | 30 | 8,884 |
| M | 10 | 7,800 | O | 31 | 10,085 |
| M | 11 | 7,800 | O | 32 | 10,680 |
| M | 12 | 7,800 | O | 54 | 14,251.9 |
| M | 13 | 8,209 | FF | 1 | 8,651 |
| M | 14 | 8,570 | FF | 2 | 7,800 |
| M | 15 | 8,563 | FF | 3 | 7,800 |
| M | 16 | 8,425 | FF | 4 | 7,912 |
| M | 17 | 8,856 | FF | 5 | 8,334 |
| M | 18 | 9,137 | FF | 6 | 20,154 |
| M | 19 | 7,800 | | | |
| M | 20 | 7,800 | | | |
| M | 21 | 8,304 | | | |
| M | 22 | 8,864 | | | |
| M | 23 | 9,137 | | | |
| M | 24 | 9,106 | | | |

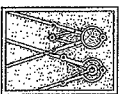

GRAY & ASSOCIATES, INC.
Consulting Engineers
8217 Shovel Creek Blvd., Suite 200
Austin, Texas 78757-7592
(512)462-0971 FAX(512)464-9893
TWPB FIRM # 2946

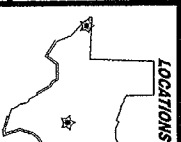

ZWA
Zamora, L.L.C.
Professional Land Surveyors
1435 South Loop 4, P.O. Box 1006, Buda, Texas 78610
Tel: (512) 295-6201 • Fax: (512) 295-6091

TECH: SEGURA
DATE: OCTOBER, 2007
DRAWING FILE: 11-1002-11 CARL III-B SHEETS 1-3.DWG
PROJECT: COMMONS @ ROWE LANE
JOB NO: 10-1001-05

SHEET
3
OF
4

